

# Passport

U L T R A L I T E  
*by Keystone*



EXPRESS



GRAND TOURING



# GO ANYWHERE



ELITE



**Keystone RV  
Company**



**Passport**  
ULTRA LITE  
*by Keystone*



## MORE CAMPING FOR LESS

Welcome to Passport Ultra Lite by Keystone. Developed by the industry leader in travel trailers and fifth wheels, Keystone set out to develop a true, full line, ultra lite product that brings best in class features and value to the market. Once again, Keystone delivers with the Passport Ultra Lite!

With customer demand for lightweight fuel efficient travel trailers at an all time high, the Passport from Keystone is sure to be the pick of families who want to maximize fuel efficiency, but still maintain all the conveniences of a well appointed, feature packed RV. Passport identified the four most important priorities for our customers: floor plan, weight, eye appeal and price; then designed the Passport to be the perfect combination of all four. Creative engineering has enabled Passport to include high-end amenities without adding pointless weight. Its sleek aerodynamic front-end design and enclosed underbelly reduces wind resistance and increases fuel efficiency. In addition, the "Load Equalization", spread-axle system assists in lowering hitch weight and makes towing easier. The Passport family can be easily towed with a half-ton pickup or SUV and the Passport Express can be towed by some smaller SUVs, crossovers or vans.

Sure, towability led you to the Passport, but when you need a travel trailer for those fun weekends or the extended cross country excursion you realize Passport has a full array of features and conveniences built into every model! You know you have arrived at the pinnacle of lite weights when you roll in with a Passport.



GO ANYWHERE.



Express Super Lite



Grand Touring



Elite

What looks small but packs a big punch when it comes to living space? The Passport Express Super Lite! Whether it's the feel of sleeping in the open air with our expandable models or the need for a trailer that can be towed by most small SUV's, the Passport **Express** Super Lite is the Passport way of making camping easy.

One word describes the Passport Grand Touring. Amazing! The Passport Grand Touring didn't get the memo that it was suppose to act like the other lite weights. With size and features of a full size camper, this Passport is still made for today's SUV's and half ton vehicles. So go ahead live large and go lite, and get more with a Passport **Grand Touring**.

Taking camping to the next level, Passport has created the ultimate in lightweight luxury! Once inside, you will see why the wide open spaces, all the amenities and high end finishes make this ultra-lite travel trailer **Elite** indeed.



PAGE 4



PAGE 5



PAGE 6





Pantry Can Also Be  
Used As Wardrobe



Queen Size Bed



Booth Dinette with  
Entertainment Center



## EXPRESS SUPER LITE

Let's say you need a camper that is easy to tow, has models under 3500 lbs. and has everything from a large kitchen sink to outside speakers. Look no further, you have arrived at the Passport Express Super Lite. With floorplans starting around 2900 lbs. and including every feature the experienced camper needs this is the Passport you want. Expandables to small bunkhouses means you won't be sitting at home on the weekends because you can go anywhere in a Passport Express Super Lite.



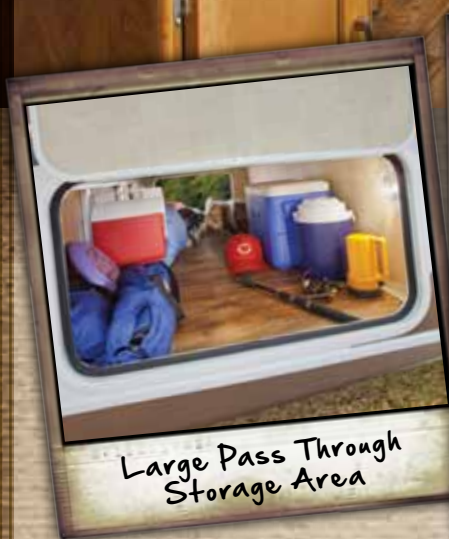

Large Pass Through  
Storage Area



Entertainment Center  
with Swivel TV



Plenty of Space for  
the Kids to Sleep



Portable Outside Grill

## GRAND TOURING



Live large and go light with the Passport Grand Touring. The long standing myth of not being able to have a full 36" deep slide and still be an ultra lite has been solved. The first and only true ultra lite weight travel trailer with a deep slide that gives you all the room you want but doesn't have unnecessary weight like the others. The spectacular Grand Touring 3220BH gives you sleeping for up to 10, an outside kitchen with water, a fridge, and cooktop all under its own awning is a flagship in its self. Want something made for two? Then step into a 2510RB which rolls in under 4900 lbs, has room to roam inside, and 2 full wardrobes/pantries to fill for a fun weekend or a cross country outing.





PASSPORT ELITE

## PASSPORT ELITE



Wow! Passport has done it again! The all new Passport Elite represents the ultimate in "true" ultra-lightweight luxury. Includes spacious wide open layouts, residential sized leather sofas, solid surface countertops, stainless steel appliances and so much more. If you're looking for the ultimate in lightweight luxury, look no further than the Elite.



# STANDARDS & OPTIONS

EXPRESS  
GT  
ELITE

## CHASSIS

Engineered specifically for each floor plan	•	•	•
Tube style bumper w/ sewer hose storage	•	•	•
Fully welded outriggers	•	•	•
Cambered for added structural support	•	•	•
Extra support cross members	•	•	•
Electric slide out system	•	•	•
Enclosed and heated underbelly (N/A 195RB)	•	•	•

## CONSTRUCTION

Welded aluminum framed sidewalls	•	•	•
Laminated gel-coated filon exterior walls	•	•	•
High density bead foam insulation in sidewalls (R-7 insulation)	•	•	•
Laminated aluminum framed floor 2" thick	•	•	•
One piece breathable Darco protective wrap	•	•	•
R-11 floor insulation	•	•	•
Stamped galvanized 5" thick crowned rafters	•	•	•
One piece seamless Rubber roof	•	•	•
R-11 ceiling insulation	•	•	•

## EXTERIOR FEATURES

Insulated lockable radius baggage doors with hold backs	•	•	•
Insulated radius entrance door with screen door	•	•	•
Double entry steps at main door	•	•	•
Triple entry steps at main door	•	•	•
Heavy duty front mechanical jack	•	•	•
4 scissor style stabilizer jacks	•	•	•
2-20lb. Propane bottles with flip top cover	•	•	•
Dual battery rack over A-frame	•	•	•
Rain gutters with extended downspouts	•	•	•
Electric adjustable awning	•	•	•
Lighted exterior pass thru storage compartment	•	•	•
Portable outside grill (most models)	•	•	•
Patio entrance light	•	•	•
Exterior shower w/ hot & cold	•	•	•
Fold away exterior grab handle (main door)	•	•	•
Front diamond plate	•	•	•
Load Equalization (spread axle design)	•	•	•
EZ lube axles	•	•	•
Exterior speakers	•	•	•
Exterior light at dump valves	•	•	•
Aluminum Wheels (OPTIONAL)	•	•	•
Upgraded graphics	•	•	•
Frameless windows	•	•	•
15 inch tires	•	•	•
Front Filon colored	•	•	•
Rear Filon colored	•	•	•
Slide wall color	•	•	•

## INTERIOR FEATURES

Residential style furniture with high grade fabric	•	•	•
Convenience center with slide, lights, awning, water system controls, and 110V receptacle	•	•	•
13.5 BTU ducted A/C	•	•	•
Forced air furnace	•	•	•
Ducted in floor heating	•	•	•
6 gallon gas/electric DSI water heater	•	•	•
Water system winterization ready	•	•	•
Residential durable Beauflor® linoleum	•	•	•
Digital TV system	•	•	•
12 volt DVD/CD/AM/FM stereo with aux input and quality sound speakers	•	•	•

## INTERIOR FEATURES CONT.

LCD flat screen HD TV	•	•	•
2 tone wood accents	•	•	•
Residential light fixtures in slide room	•	•	•
King u-shaped dinette	•	•	•
Radius walls	•	•	•
4-panel shaker style interior doors	•	•	•
Upgraded furniture (hide-a-bed)	•	•	•
High-end window treatments (wood valence leather accent)	•	•	•
Residential style entertainment center	•	•	•
Wood mini blinds	•	•	•
Optional booth dinette	•	•	•

## KITCHEN

Extra large double door refrigerator	•	•	•
Oversized 60/40 residential sink	•	•	•
Metal high-rise faucet	•	•	•
Microwave with carousel	•	•	•
3-burner high output range	•	•	•
Range hood	•	•	•
Residential hardwood cabinet doors	•	•	•
Coordinated wall paper border	•	•	•
Gas Oven	•	•	•
Solid surface countertop	•	•	•
Stainless steel sink	•	•	•
Stainless steel appliances	•	•	•
Wood panel refrigerator cabinets instead of wall board (side of cabinet)	•	•	•
Pendant lighting above kitchen countertops	•	•	•

## BATHROOM

Solid wood custom built medicine cabinet with mirror	•	•	•
Tub surround with built-in shelves	•	•	•
Radius shower curtain	•	•	•
Pedestal foot flush toilet	•	•	•
Skylight over tub (most floorplans)	•	•	•
12 volt power exhaust fan	•	•	•

## BEDROOM MAIN

60"x80" Queen Size Mattress	•	•	•
Quilted bedspread	•	•	•
Oversized wardrobes	•	•	•
Nighttime reading lights	•	•	•
Upgraded quilted bed spread	•	•	•
Throw pillows	•	•	•

## SAFETY PACKAGE

4 wheel electric brakes	•	•	•
Break-away switch	•	•	•
Heavy duty safety chains with clasp	•	•	•
Tinted safety glass windows	•	•	•
Multiple emergency egress windows	•	•	•
GFI recepticals	•	•	•
Carbon monoxide detector	•	•	•
Smoke alarm	•	•	•
Fire extinguisher	•	•	•
Propane gas leak detector	•	•	•
Dead-bolt lock on entrance doors	•	•	•
Manual override on slide system	•	•	•
Spare tire kit	•	•	•



# Passport ULTRA LITE *by Keystone*

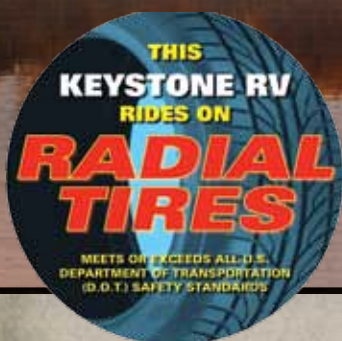

- 1 Gel Coated Filon Exterior
- 2 Luan Layer
- 3 Hi-Density Block Foam Insulation
- 4 Interior Wallboard
- 5 Total Aluminum Frame
- 6 Residential Grade Linoleum
- 7 1st Layer Floor Decking
- 8 2nd Layer Floor Decking with Staggered Seams
- 9 Hi-Density Block Foam Insulation

- 10 Aluminum Floor Studs
- 11 3rd Layer Floor Decking
- 12 Moisture Barrier Wrap
- 13 Enclosed Underbelly (GT & Elite)
- 14 PACO I-Beam Frame
- 15 One Piece Rubber Roof
- 16 Roof Decking
- 17 R-11 Insulation
- 18 5" Crowned/Stamped Roof Trusses
- 19 Hurricane Straps

- 20 Diamond Plate
- 21 Dual Battery Tray
- 22 Sloped Slide Roof
- 23 Wiper Seals
- 24 Bulb Seal in T-Track
- 25 Aerodynamic Front Wall
- 26 Easy Lube Axles
- 27 Load Equalization Axles (GT only)
- 28 Radial Tires
- 29 Radius Entry Steps

CONSTRUCTION AND FEATURES



Foot Flush Toilet



HD LCD Television



Easy Open LP Tank Cover



Solid Surface Countertops (Elite only)



Outside Speakers and Power Awning



# GO ANYWHERE.



Folding Entry Assist Handle  
(GT and Elite)

Stabilizer Jacks



Load Equalization Axles  
(GT only)



Lighted Pass-Thru Storage



Wood Mini Blinds  
(Elite only)



Deep Sink with High-Rise Faucet  
(Elite-Stainless Steel)

CONSTRUCTION AND FEATURES



23RB

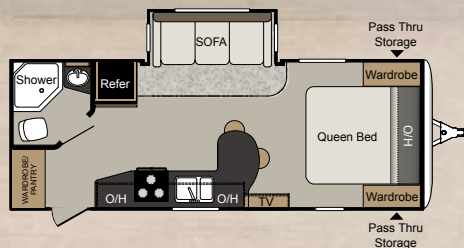

28BH

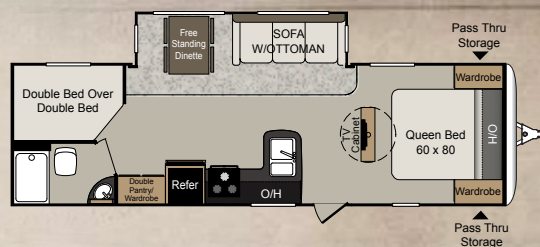

31RE

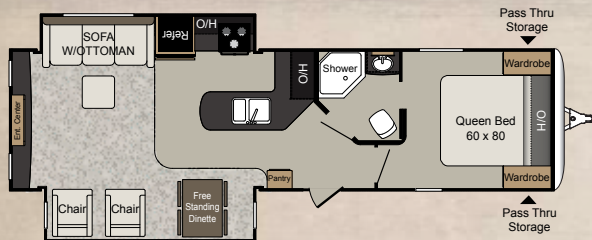

32FB

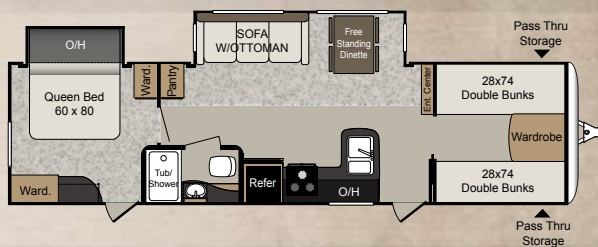

33BH

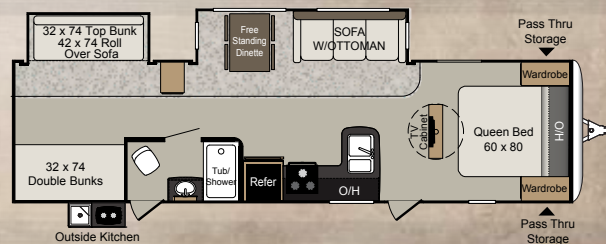

OPTIONAL BOOTH DINETTE  
(ELITE ONLY)

	Floorplan	Shipping Weight	Carrying Capacity	Hitch	Length	Height	Fresh Water	Waste Water	Gray Water	LPG	AWNING
ELITE	23RB	4560	2240	410	25' 11"	10' 9"	30	30	30	40	15'
	28BH	5505	1995	610	31' 10"	10' 9"	30	30	30	40	19'
	31RE	6240	1760	655	34' 8"	10' 9"	30	30	30	40	12'
	32FB	6340	1860	820	35' 4"	10' 9"	30	30	30	40	19'
	33BH	6450	1750	780	35' 4"	10' 9"	30	30	30	40	15'
EXPRESS SL	190EXP	3500	1700	385	20' 7"	10' 1"	30	30	30	40	12'
	195RB	3580	1620	350	23' 4"	10' 1"	30	30	30	40	15'
	199ML	3541	1659	335	21' 9"	10' 1"	30	30	30	40	10'
	235EXP	4144	1856	335	21' 9"	10' 2"	30	30	30	40	10'
	238ML	3707	1693	495	24' 11"	10' 2"	30	30	30	40	15'
	245RB	4250	1750	460	26' 9"	10' 2"	30	30	30	40	17'
	252BH	4085	1915	450	26' 9"	10' 2"	30	30	30	40	17'
	280BH	4420	1580	485	30' 1"	10' 2"	30	30	30	40	17'
GRAND TOURING	2300BH	4365	2435	460	26' 6"	10' 7"	30	30	30	40	15'
	2510RB	4839	2161	495	28' 10"	10' 7"	30	30	30	40	19'
	2650BH	4876	2324	540	29' 4"	10' 7"	30	30	30	40	19'
	2890RL	5420	1780	590	32' 8"	10' 9"	30	30	60	40	19'
	2910BH	5354	1846	725	32' 8"	10' 9"	30	30	30	40	19'
	2920BH	5370	1830	635	32' 10"	10' 9"	30	30	30	40	15'
	3180RE	5922	1578	720	34' 11"	10' 9"	30	30	30	40	15'
	3220BH	6109	1391	600	35' 5"	10' 9"	30	30	30	40	15' & 10'
WE	2100RBWE	4337	2163	530	24' 10"	10' 7"	43	30	30	40	15'
	2480RKWE	4817	2183	520	28' 6"	10' 7"	43	30	60	40	19'

## SPECIFICALLY BUILT FOR THE WEST COAST

2100RBWE

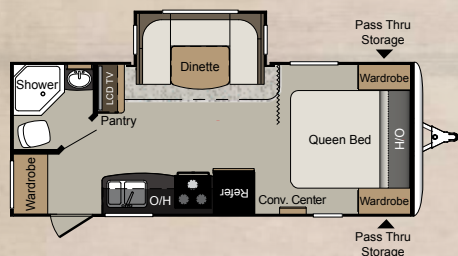

2480RKWE

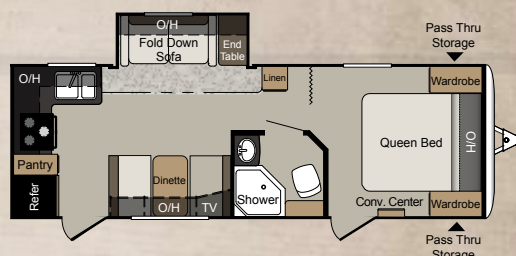



190EXP

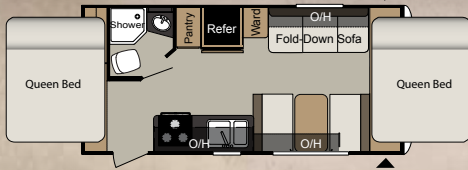

195RB

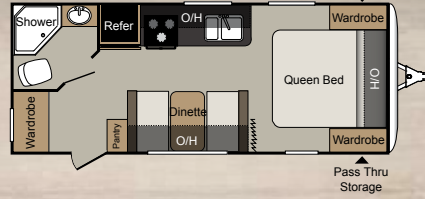

199ML

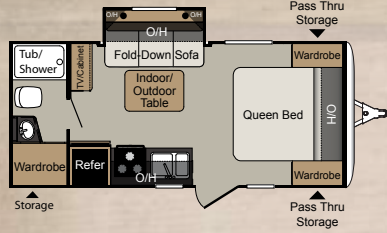

235EXP

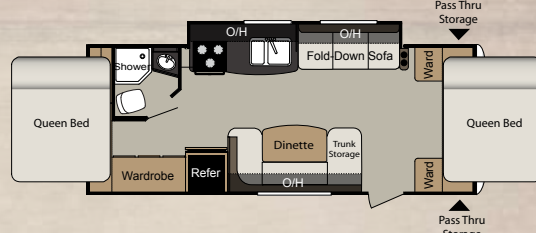

238ML

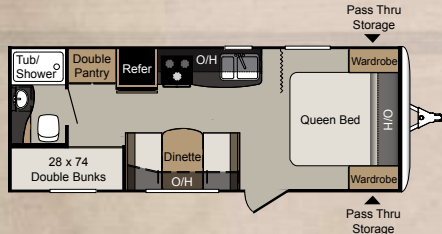

245RB

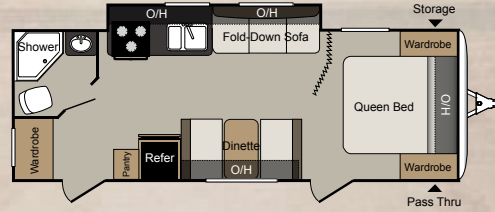

252BH

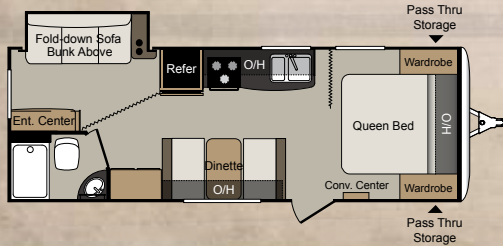

280BH

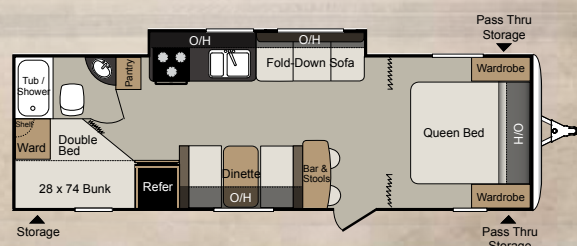

2300BH

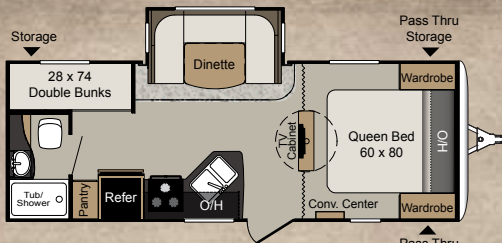

2510RB

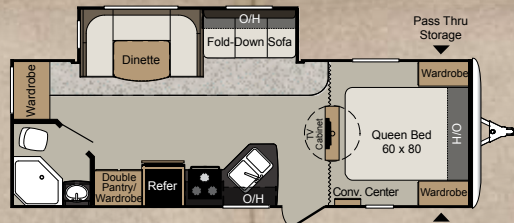

2650BH

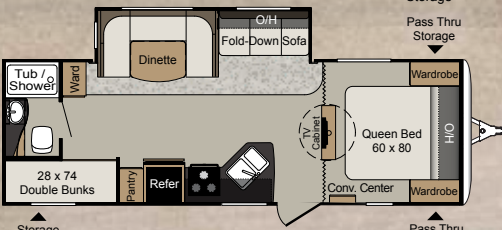

2890RL

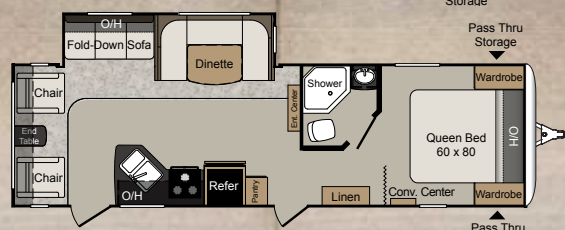

2910BH

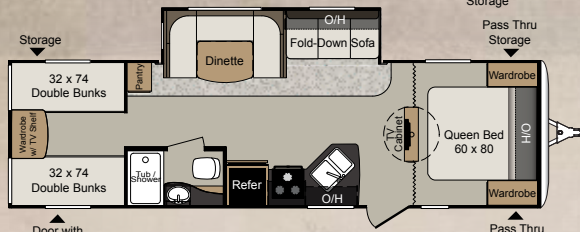

2920BH

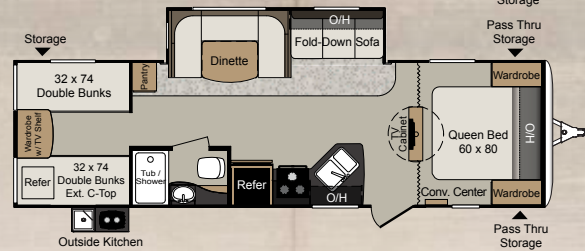

3220BH

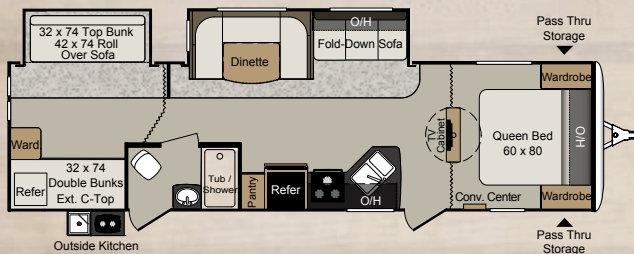

3180RE

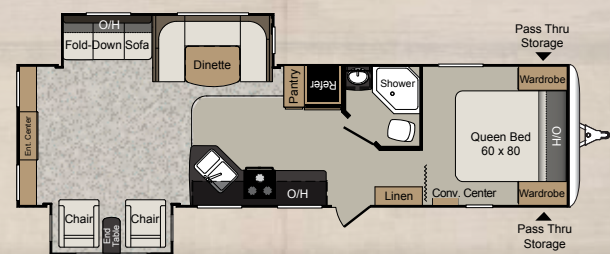



# DECOR OPTIONS



Parsley



Bayside



Rattan

**Passport**  
ULTRA LITE  
by Keystone



GO ANYWHERE | [WWW.KEYSTONE-PASSPORT.COM](http://WWW.KEYSTONE-PASSPORT.COM)

YOUR LOCAL DEALER IS:

March 2013

Product information is as accurate as possible at the date of publication of this brochure. Features, floor plans, and specifications are subject to change without notice. Please also consult Keystone's web site at [keystonerv.com](http://keystonerv.com) for more current product information and specifications. Tow Vehicle Disclaimer. CAUTION: Owners of Keystone recreational vehicles are solely responsible for the selection and proper use of tow vehicles. All customers should consult with a motor vehicle manufacturer or their dealer concerning the purchase and use of suitable tow vehicles for Keystone products. Keystone disclaims any liability or damages suffered as a result of the selection, operation, use or misuse of a tow vehicle. KEYSTONE'S LIMITED WARRANTY DOES NOT COVER DAMAGE TO THE RECREATIONAL VEHICLE OR THE TOW VEHICLE AS A RESULT OF THE SELECTION, OPERATION, USE OR MISUSE OF THE TOW VEHICLE. 3/2013

Go RVing  
Life's A Trip

Member  
**RVIA**  
RECREATION VEHICLE  
INDUSTRY ASSOCIATION

2642 Hackberry Drive | PO Box 2000  
Goshen, IN 46527-2000  
(574) 535-2100



**Keystone RV  
Company**

[www.keystonerv.com](http://www.keystonerv.com)

**LEARN MORE**



Download the free Tag app  
at <http://gettag.mobi>  
and scan this Tag.