

STARCRAFT

CAMPING | pure and simple.

2015 AR-ONE

Travel Trailers by Starcraft®

AR-ONE



- 48-Gallon Fresh Water Capacity (Select Models)
- Front and Rear Stabilizer Jacks
- Some Towable by Minivans and SUVs
- 7-Year Tent Warranty (Select Models)



28QBS



STARCRAFT
AR-ONE

A durable, entry-level camper that is value-priced, the AR-ONE is towable by most SUVs and minivans. The 2015 AR-ONE features bolder new graphics, a 2-year limited warranty and new touches such as ball bearing drawer guides and heated mattress pads. The AR-ONE MAXX provides more living space while five floorplans offer additional sleeping accommodations in double or single bunk beds. Packing a lot into a small, lightweight package, the AR-ONE and AR-ONE MAXX feature standard amenities to ensure an enjoyable camping experience – pure and simple.

30BHU



- 1 Optional 26" LED TV
- 2 Kitchen with honey-glazed cherry wood cabinetry, residential-style backsplash, 3-burner range (MAXX) and high-rise faucet (MAXX)
- 3 Electric awning (Show Stopper Package) and exterior speakers (MAXX)
- 4 Outside shower (Show Stopper Package MAXX)
- 5 Electric tongue jack and dual 30-lb. LP bottles with cover (Show Stopper Package MAXX)
- 6 Stabilizer jacks (Show Stopper Package MAXX)



FLOORPLANS

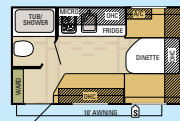

14RB

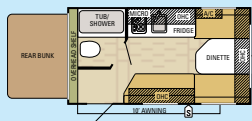

15RB

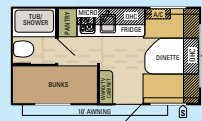

16BH

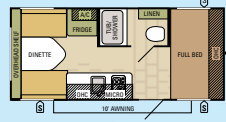

17RD

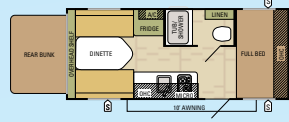

18FB

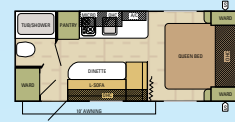

18QB

MAXX
SERIES

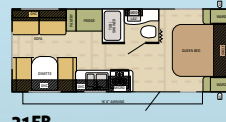

21FB



25BHS

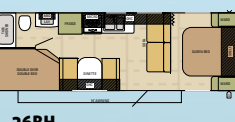

26BH

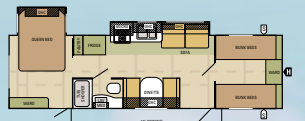

28FBS

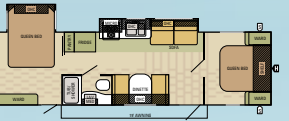

28QBS

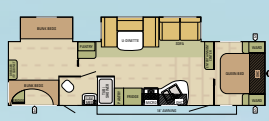

30BHU

SPECIFICATIONS

FLOORPLAN	EXTERIOR LENGTH	EXTERIOR HEIGHT (14RB-18FB) EXTERIOR HEIGHT WITH A/C (MAXX)	INTERIOR HEIGHT	UNLOADED VEHICLE WEIGHT (LBS.)	DRY HITCH WEIGHT (LBS.)	GROSS VEHICLE WEIGHT RATING (LBS.)	CARGO CARRYING CAPACITY (LBS.)	FRESH WATER CAPACITY (GAL.) (INCLUDES WATER HEATER)	GRAY WASTE WATER CAPACITY (GAL.)	BLACK WASTE WATER CAPACITY (GAL.)
14RB	16' 6"	101"	73"	2,390	255	3,200	810	32	15	9
15RB	17' 6"	103"	73"	2,550	220	3,200	650	32	15	9
16BH	17' 10"	103"	73"	2,560	335	3,500	940	32	15	9
17RD	20' 6"	103"	73"	2,865	305	3,500	635	26	15	9
18FB	20' 6"	103"	73"	2,975	325	3,750	775	26	15	9
18QB	TBD	TBD	73"	TBD	TBD	TBD	TBD	TBD	15	9
21FB	25' 7"	126"	81"	3,880	490	6,000	2,120	48	32.5	32.5
25BHS	29' 9"	132"	81"	5,200	685	7,500	2,300	48	32.5	32.5
26BH	TBD	TBD	81"	TBD	TBD	TBD	TBD	48	32.5	32.5
28FBS	33' 10"	135"	81"	6,320	635	8,500	2,180	48	32.5	32.5
28QBS	30' 10"	135"	81"	6,120	615	8,500	2,380	48	32.5	32.5
30BHU	36' 2"	134"	81"	7,170	895	9,950	2,780	48	32.5	32.5

UNLOADED VEHICLE WEIGHT (UVW): Sometimes referred to as "Dry Weight," UVW means the typical weight of this trailer as built at the factory. The UVW, as used in product literature and other promotional materials, does not include cargo, fresh water, propane, options or dealer-installed accessories. The weights of certain options and/or option packages are not included in the UVW listed above.

GROSS VEHICLE WEIGHT RATING (GVWR): GVWR means the maximum permissible weight of the trailer, including the UVW plus passengers, personal items, all cargo, fluids, options, and dealer-installed accessories. The GVWR is equal to or greater than the sum of the UVW and the CCC.

CARGO CARRYING CAPACITY (CCC): CCC means the maximum weight of all passengers, personal items, food, fresh water, propane, tools, other cargo and dealer-installed accessories that can be carried by the trailer. CCC is equal to or less than GVWR minus UVW. The addition of options will decrease the CCC.

HITCH WEIGHT (HW): The hitch weight, as used in product literature and other promotional materials, does not include cargo, fresh water, propane gas, options or dealer-installed accessories. The addition of these types of items will either add to or subtract from the stated hitch weight. It is important for your safety and enjoyment that your tow vehicle be adequately sized and equipped to tow and handle the GVWR of the RV you select. Review weights and rating of your tow vehicle and consult a competent advisor for questions or advice. Whether you are new to RVing or a veteran, get a feel for the performance of your tow vehicle and the RV together before heading out on the roadways. When you tow an RV, you must drive differently than you do when driving a single vehicle. Practice hooking up, driving, backing up and braking in a safe environment or seek out professional instruction. Starcraft affixes a weight label to each RV which lists weight information for that vehicle. See specification chart above.

STANDARDS AND OPTIONS

STANDARD CONSTRUCTION EQUIPMENT

5/8" tongue-and-groove plywood main floor decking (MAXX)
Cable-support bunk-end system (1,100-lb. capacity) (15RB, 18FB)
Fully decked roof with 3/8" decking
One-piece, seamless rubber roof material
Poly Flex one-piece underbelly covering
Roof rafters constructed of residential-style tapered trusses
Screwed-stile cabinetry with hardwood stiles

STANDARD EXTERIOR EQUIPMENT

20-lb. propane bottle(s)
48-gallon fresh water capacity (MAXX)
120V G.F.C.I. protected exterior receptacle
5,000-BTU A/C (14RB, 15RB, 16BH)
8,000-BTU A/C (17RD, 18FB)
13,500-BTU A/C (MAXX)
19" large plastic grab handle (MAXX)
AquaShield Aqualon water-repellent sectionalized tent with 7-year warranty (15RB, 18FB)
Bumper with drain hose carrier and end caps
Bunk-end tent permanently attached to bed base (15RB, 18FB)
Cable TV prep
Dark-tinted safety glass windows
Electric brakes
Front window with flush-mounted stone guard (select models)
Galvanized steel wheel wells
Prep for bumper-mount grill (MAXX)
Rain guttering, molded with drip spouts
Roof-mounted antenna for radio
Spare tire with carrier (n/a on MAXX)
Starmaxx pass-through storage (MAXX)
Three-toned exterior metal
Water system winterization kit

STANDARD INTERIOR EQUIPMENT

5/8" tongue-and-groove plywood main floor decking (MAXX)
Cable-support bunk-end system (1,100-lb. capacity) (15RB, 18FB)
Fully decked roof with 3/8" decking
One-piece, seamless rubber roof material
Poly Flex one-piece underbelly covering
Roof rafters constructed of residential-style tapered trusses
Screwed-stile cabinetry with hardwood stiles

3 cu. ft. gas/electric refrigerator
6 cu. ft. flush-mount refrigerator (MAXX)
54" booth dinette (n/a MAXX)
81" interior height (MAXX)
Acrylic sink with faucet
Ball-bearing drawer guides, 50-lb. capacity with full-drawer extension (MAXX)
Double-over-double bunk bed with 600-lb. bunk capacities (26BH)
Evergreen mattress with upgraded radius corners (MAXX)
Extra-large picture window at dinette
Hardwood cabinet doors
High-rise kitchen faucet (MAXX)
Honey-glazed cherry wood cabinetry
LED light in bunk (15RB, 18FB)
Medicine cabinet (MAXX)
Quilted bunk mats – Denver Mattress
Shaw carpet with R2X stain and soil resistance (slideout models)
Skylight in tub/shower (n/a MAXX)
Systems monitor panel

CUSTOMER CONVENIENCE PACKAGE (MANDATORY OPTION)

6-gallon gas DSI water heater
Front diamond plate - black
Microwave
Pleated shades
Bathroom vent
Radial tires
Stereo with AM/FM and iPod/MP3 connection
Water heater bypass system

SHOW STOPPER PACKAGE (MANDATORY OPTION STANDARD AR-ONE)

Electric awning
Front and rear stabilizer jacks
Heated bunk mat (on 15RB & 18FB)
Denver Mattress bunk mat (on 15RB & 18FB)
Spare tire cover (n/a on MAXX)

OPTIONS

13,500-BTU A/C in lieu of 5,000 or 8,000-BTU A/C
Aluminum rims
Extreme Package (n/a MAXX): 5" extra ground clearance, 6-sided Flex-Foil insulation, 15" off-road mud tires, double entrance step, enclosed underbelly, fender flair
LED interior lighting package

MAXX SERIES ONLY SHOW STOPPER PACKAGE (MANDATORY OPTION)

Electric awning
Front and rear stabilizer jacks
30-lb. propane bottles with cover (2)
Electric tongue jack
Exterior speakers (2)
Outside shower
Sink covers

OPTIONS

26" LED TV & CD/DVD player with MP3 iPod input jack
Aluminum rims
Arctic Package: Insulated, heated and enclosed underbelly; foil insulation in roof
Bumper-mount grill
Décor Upgrade Package: Decorative dinette light (select models), jackknife sofa, kitchen backsplash and valances with lambrquin legs
Ducted 13,500-BTU A/C (21FB, 25BHS, 26BH)
Exterior fiberglass sidewalls (two-toned) with frameless windows
LED interior lighting package
Oven
Spare tire with carrier and cover



Scan for a
complete list
of Standards
and Options

PEACE OF MIND - PURE AND SIMPLE

Starcraft is proud to back their products with one of the best and most comprehensive warranty programs in the industry. Starcraft is determined to make every camping experience enjoyable by offering peace of mind - pure and simple. See back for details.



50 YEARS OF AFFORDABLE DURABILITY

Starcraft builds a variety of RVs, from the entry-level Starflyer camping trailer to our premium-rated Travel Star travel trailer. Throughout each unit, it is evident to customers that our Amish craftsmanship and attention to detail are what make Starcraft products unique and family-friendly.

Staying true to our pursuit of affordability and durability, we use the highest-quality materials available, state-of-the-art production techniques and time-tested design. We put all of our time and effort into making a quality camper at an affordable price.

What started out five decades ago as an idea to provide families with a way to reconnect and enjoy the great outdoors has grown into a company that takes great pride in saying that Starcraft means Camping - Pure and Simple.



DURABLE CONSTRUCTION

AR-ONE features durable construction, including 5/8" main floor decking, Poly Flex one-piece underbelly covering, wooden wall studs on 16" centers, and .024" aluminum exterior siding. Crowned roof trusses, 3/8" roof decking and a one-piece seamless rubber roof offer durability and help prevent leaking. With a 7-year tent warranty, our mold resistant, double-stitched AquaShield Aqualon material doesn't stretch, shrink or crack, providing long-lasting durability even when it's up against Mother Nature.



PEACE OF MIND - PURE AND SIMPLE

The Starcraft warranty is a manufacturer's limited warranty. Each Starcraft is warranted to the original purchaser for twenty-four (24) months from the original date of purchase against defects in materials and workmanship. Starcraft's limited warranty is not transferable. For a copy of the limited warranty with full terms and conditions, ask your local Starcraft dealer.

Starcraft -vs- the Competition

MAGNUMROOF SYSTEM

Our Roof is 50% Stronger!



SCREWED CONSTRUCTION

We screw down 3/8" roof decking at each seam vs. our competitors who use staples.



OVERSIZED NAIL PLATES

Our oversized nail plate joint fasteners are more secure than the smaller ones used by our competitors.



2" X 2" VERTICAL WOOD STUDS

Our strategically placed 2" x 2" vertical studs maximize load capacity compared to 1" aluminum piece on inferior roofs.



7" HEADER BEAM

7" header beams between the roof and slideout openings comply with load-bearing beam standards for home construction.



4,500 LBS. ON A STARCRAFT ROOF

The MagnumRoof System withstands 4,500 lbs., while the others crumble.



Scan to learn all the ways that the MagnumRoof System by Starcraft is superior.

WWW.STARCRAFTCAMPING.COM

VISIT OUR WEBSITE for more information or to find a dealer near you.



FOLLOW US ON  

© Starcraft RV • 536 Michigan St., Topeka, IN 46571
www.starcraftcamping.com



See dealer for further information and prices. All information in this brochure is the latest available at the time of publication approval. Starcraft reserves the right to make changes and to discontinue models without notice or obligation. Photos in this brochure may show optional equipment and props for photography purposes. RVs built for sale in Canada may differ to conform to Canadian codes.

eco advantage

The Starcraft EcoAdvantage is our company's commitment to protecting the environment. Scan this QR code with your smartphone to watch a video about our efforts and the impact we're making on our planet.