

*Cadet*

*Sport*

*Pilot*

**FIFTH 'S**

DON'T JUST DREAM. LIVE.



STRONG, DURABLE LAMINATED FIBERGLASS WITH ALL ALUMINUM CAGE CONSTRUCTION



*Cadet*



*Sport*



*Pilot*



**FIFTH WHEEL**



# Cadet

## BIG THINGS COME IN SMALL PACKAGES



**SC225T SADDLE / SC291BHSS PEBBLE** (Both shown with optional wood planked vinyl flooring)

As with every series designed by Surveyor, a premium is placed on superior craftsmanship and unmatched value. By combining lightweight floorplans and efficient design, the Cadet delivers superior camping comfort.

# CADET

## FLOORPLANS AND SPECIFICATIONS

ST=STORAGE PT=PASS THRU STORAGE OHD=OVERHEAD CABINET

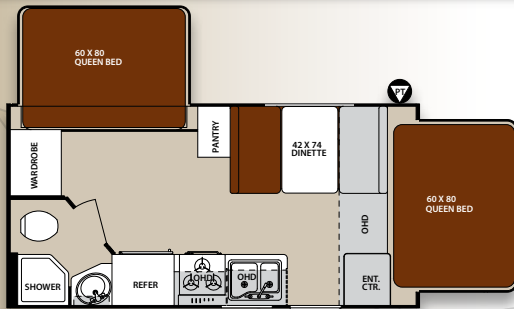

CADET SC191T

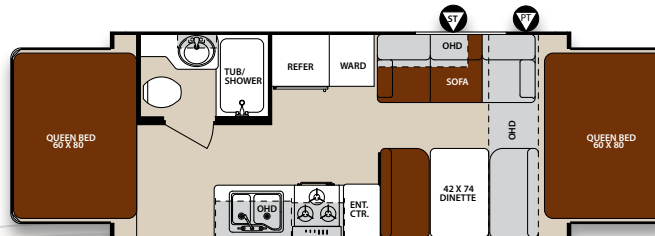

CADET SC192T

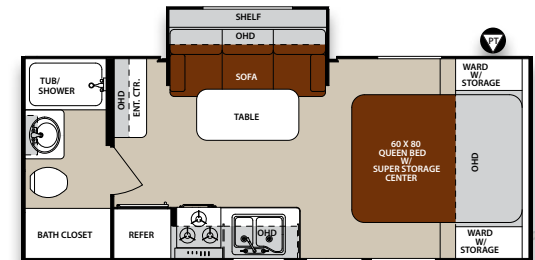

CADET SC201RBS

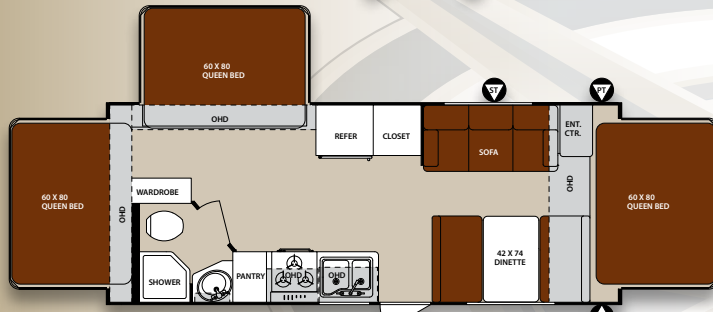

CADET SC224T

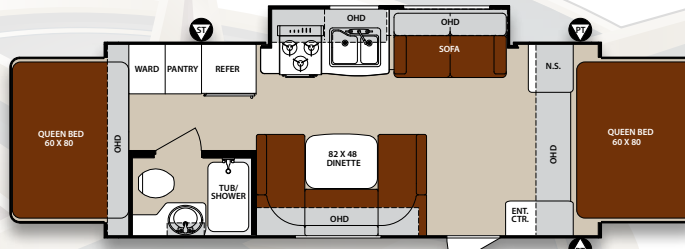

CADET SC225T

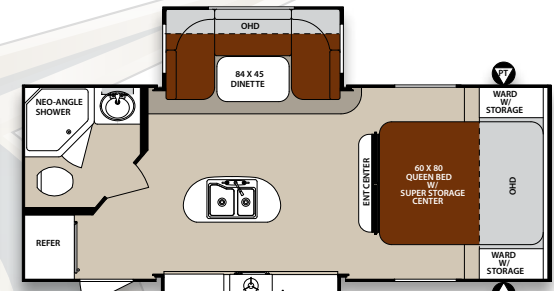

CADET SC226RBDS

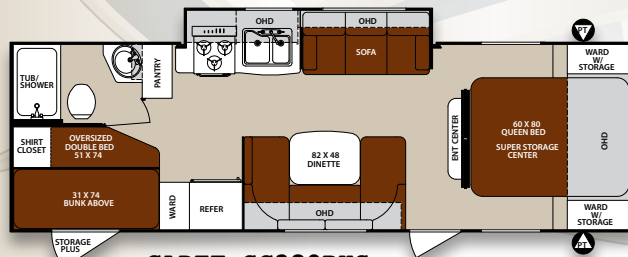

CADET SC280BHS

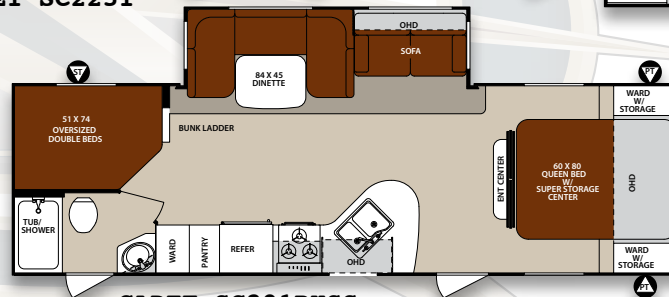

CADET SC291BHSS

## SPECIFICATIONS

MODEL	SC191T	SC192T	SC201RBS	SC224T	SC225T	SC226RBDS	SC280BHS	SC291BHSS	SC321BHTS
*TOTAL DRY WEIGHT	3358	3680	4088	4026	4211	4880	4729	5989	7294
LOAD CAPACITY	1478	1730	1328	1428	1252	2612	2775	3476	3754
HITCH WEIGHT	436	372	416	416	425	492	504	665	888
OVERALL LENGTH	20'4"	21'11"	23'11"	24'7"	24'7"	25'5"	30'7"	32'2"	36'0"
EXT. WIDTH	8'0"	8'0"	8'0"	8'0"	8'0"	8'0"	8'0"	8'0"	8'0"
EXT. HEIGHT (W/ AC)	10'5"	10'5"	10'5"	10'5"	10'5"	11'0"	10'5"	11'3"	11'3"
FRESH WATER (GAL)	46	46	46	46	46	46	46	46	46
GREY WATER (GAL)	40	40	40	40	40	40	40	40	40
BLACK WATER (GAL)	30	30	30	30	30	30	30	30	30
AWNING SIZE	12'	9'	13'	13'	16'	17'	17'	17'	17'

\*We know weights and dimensions are an important part of your buying decision. Surveyor weighs every model to ensure accuracy, although refinements to the product can create variations to weights and dimensions. Review a current model at your nearest authorized Surveyor Dealer today.

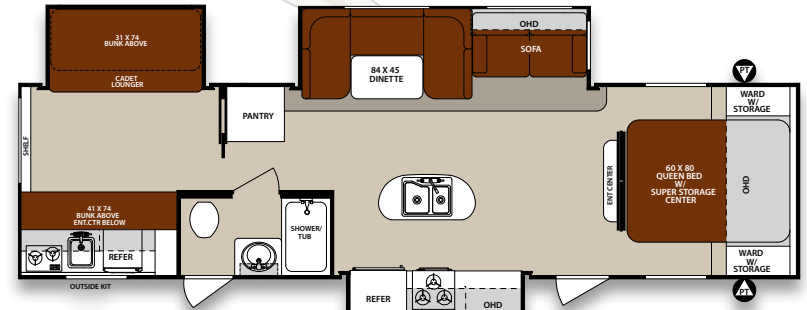

CADET SC321BHTS



*Sport*

HIGH END FEATURES  
AT A VALUE PRICE



### SP285RBDS JAVA

Sporty and innovative, the Sport Series offers you a true residential feel. Our Island Kitchen sink and high rise faucet with pull out sprayer is just one example of our commitment to your outdoor adventure.



## SP240RBS JAVA

The Sport series provides you with everything you need for your next trip and more. The kitchen of our SP240RBS is designed to be efficient and provide you with abundant storage for all the necessities.



SP240RBS EXTERIOR KITCHEN



*Sport*

DESIGNED FOR COMFORT  
AND CONVENIENCE



### SP220RBS SADDLE

The smart choice for those who choose to travel well but light.

# SPORT

## FLOORPLANS AND SPECIFICATIONS

ST=STORAGE PT=PASS THRU STORAGE OHD=OVERHEAD CABINET

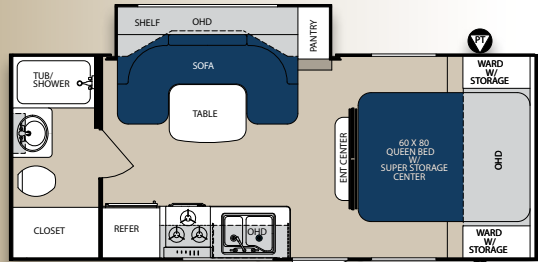

**SPORT SP220RBS**

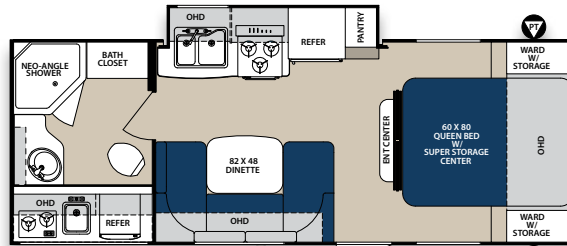

**SPORT SP240RBS**

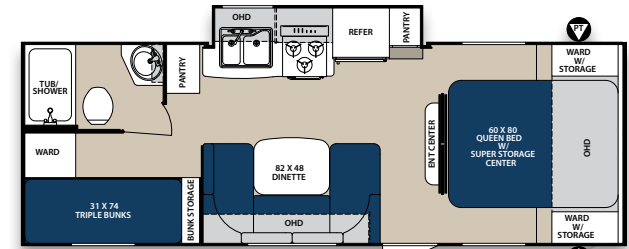

**SPORT SP260BHS**

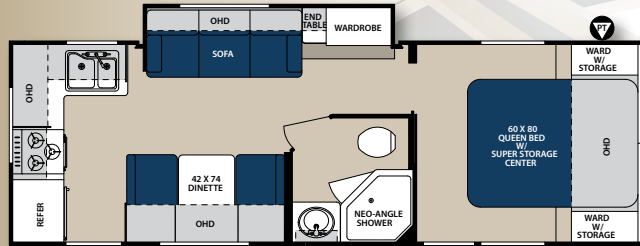

**SPORT SP264RKS**

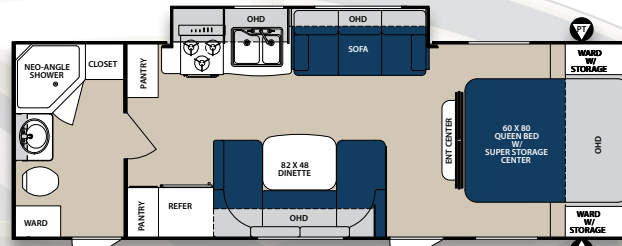

**SPORT SP275RBS**

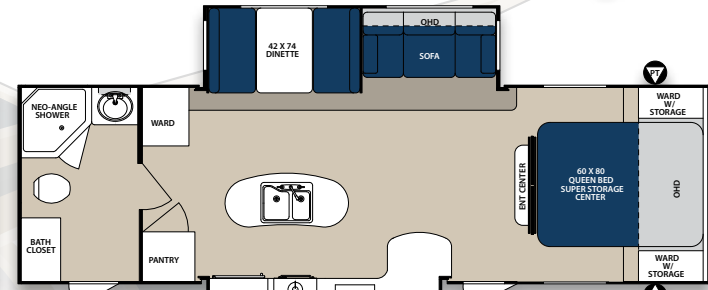

**SPORT SP285RBDS**

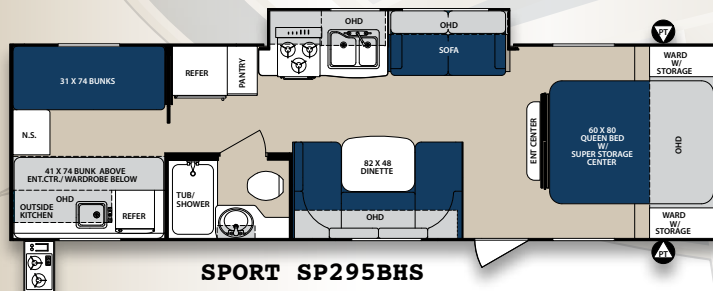

**SPORT SP295BHS**

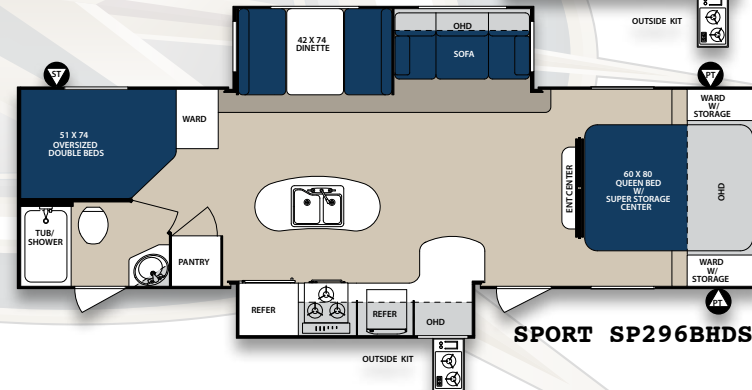

**SPORT SP296BHDS**

## SPECIFICATIONS

MODEL	SP220RBS	SP240RBS	SP260BHS	SP264RKS	SP275RBS	SP285RBDS	SP295BHS	SP296BHDS
*TOTAL DRY WEIGHT	4415	4759	4850	5124	4973	6513	5644	6606
LOAD CAPACITY	3038	2829	2667	2499	2532	4405	1931	4300
HITCH WEIGHT	453	588	517	623	505	758	575	746
OVERALL LENGTH	25'5"	27'3"	28'9"	29'9"	30'3"	32'7"	33'11"	34'3"
EXT. WIDTH	8'0"	8'0"	8'0"	8'0"	8'0"	8'0"	8'0"	8'0"
EXT. HEIGHT (W/ AC)	10'5"	10'5"	10'5"	10'5"	10'5"	11'3"	10'5"	11'3"
FRESH WATER (GAL)	46	46	46	46	46	46	46	46
GREY WATER (GAL)	40	40	40	60	40	40	40	40
BLACK WATER (GAL)	30	30	30	30	30	30	30	30
AWNING SIZE	15'	13'	16'	20'	20'	18'	18'	20'

\*We know weights and dimensions are an important part of your buying decision. Surveyor weighs every model to ensure accuracy, although refinements to the product can create variations to weights and dimensions. Review a current model at your nearest authorized Surveyor Dealer today.





# Pilot

## WELCOME TO FIRST CLASS CAMPING



### SV32RBDS SADDLE

You will feel right at home in our Island Kitchen models, spacious countertops provide you with the room you need to prepare even the most elaborate meals.

Convenience. Ladies you'll enjoy the built in vanity, located right in your bedroom.



## TAKE FLIGHT FROM THE ORDINARY

Whether it's time for dinner or you are just sitting back to relax, the "Vista Lounge" sofa slide in the SV34BHTS with its panoramic windows brings the outside in for more natural light and great views.





# Pilot

## THE BEST WAY TO ENJOY ISLAND LIVING



### SV34RLTS JAVA

The Pilot SV34RLTS triple slide offers you all the comforts of home, even at the most remote camping spot. A large LED TV, an electric fireplace, a fully equipped kitchen and a spacious bedroom are the hallmarks of the SV34RLTS.



# PILOT

## FLOORPLANS AND SPECIFICATIONS

ST=STORAGE PT=PASS THRU STORAGE OHD=OVERHEAD CABINET

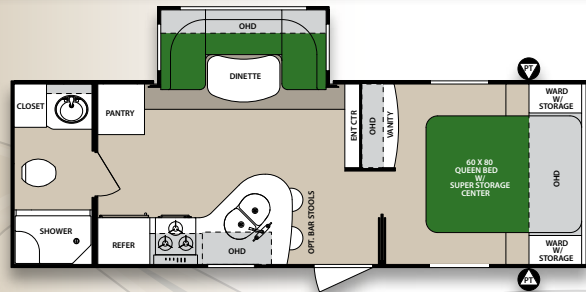

**PILOT SV27RBS**

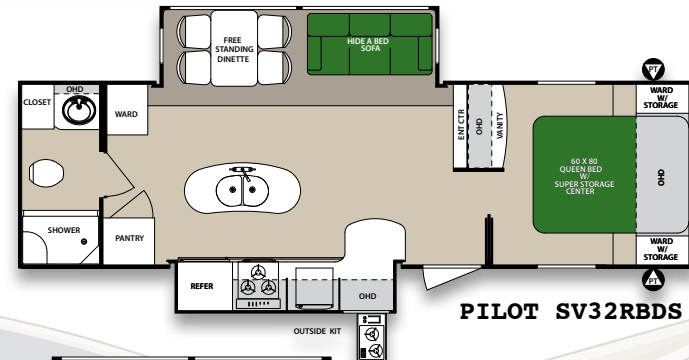

**PILOT SV32RBDS**

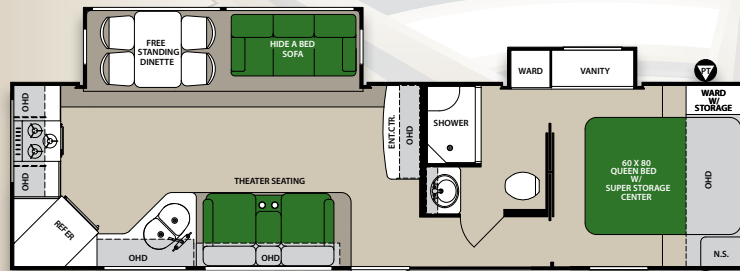

**PILOT SV34RKDS**

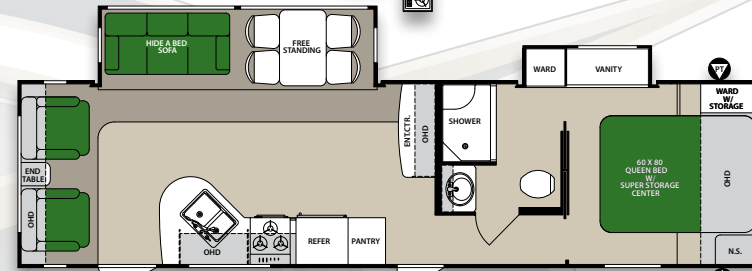

**PILOT SV34RLDS**

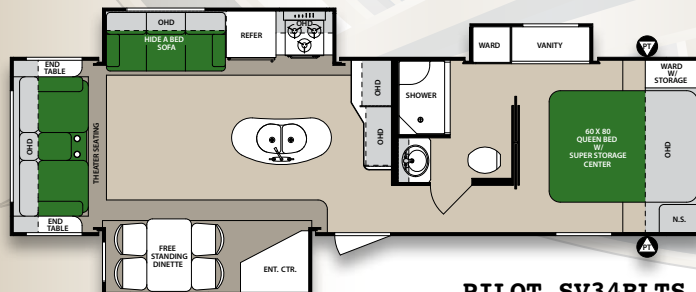

**PILOT SV34RLTS**

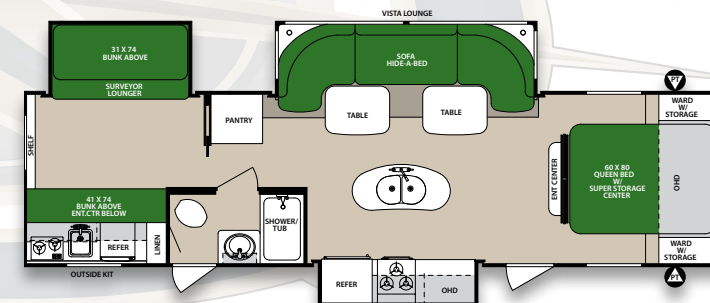

**PILOT SV34BHTS**

## SPECIFICATIONS

MODEL	SV27RBS	SV32RBDS	SV34RKDS	SV34RLDS	SV34RLTS	SV34BHTS
*TOTAL DRY WEIGHT	6293	6934	7164	7034	7442	7931
LOAD CAPACITY	3144	3476	3994	4031	3961	3121
HITCH WEIGHT	637	665	998	905	1198	892
OVERALL LENGTH	28'8"	32'2"	35'7"	36'0"	34'9"	36'0"
EXT. WIDTH	8'0"	8'0"	8'0"	8'0"	8'0"	8'0"
EXT. HEIGHT (W/ AC)	11'3"	11'3"	11'3"	11'3"	11'3"	11'3"
FRESH WATER (GAL)	46	46	46	46	46	46
GREY WATER (GAL)	40	75	60	40	75	40
BLACK WATER (GAL)	30	35	30	30	35	30
AWNING SIZE	20'	20'	20'	20'	20'	17'

\*We know weights and dimensions are an important part of your buying decision. Surveyor weighs every model to ensure accuracy, although refinements to the product can create variations to weights and dimensions. Review a current model at your nearest authorized Surveyor Dealer today.





# FIFTH 'S

# ACTUALLY, THERE IS A PLACE LIKE HOME



## SVF293RLTS JAVA

Features and quality you expect. Our handcrafted furniture built in the USA, 8 cubic foot refer, 22" oven and a standard fireplace are just a few of the high end items you will find in a Surveyor Fifth Wheel.



## SVF293RLTS JAVA

No need to make sacrifices while you travel. The Surveyor Fifth Wheel series boasts standard solid surface countertops, an undermount sink with solid surface covers, and a residential pull out sprayer faucet. Modern conveniences on the road.





# FIFTH 'S

# HALF TON TOWABLE



## SVF278RLDS SADDLE

The SVF278RLDS is perfect for the traveler that doesn't want to own a gas guzzler, our half ton Fifth Wheel line up takes advantage of today's more economical pickup trucks.



# FIFTH'S

## FLOORPLANS AND SPECIFICATIONS

ST=STORAGE PT=PASS THRU STORAGE OHD=OVERHEAD CABINET

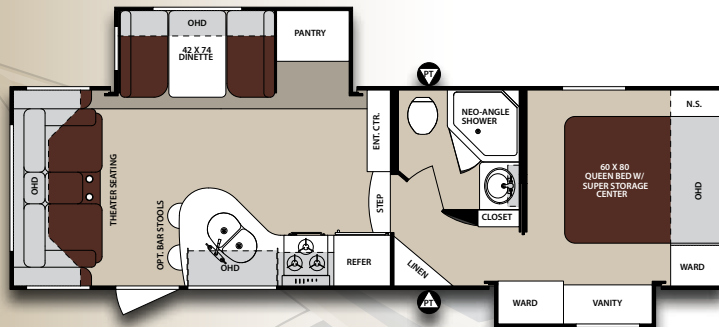

FIFTH WHEEL SVF278RLDS

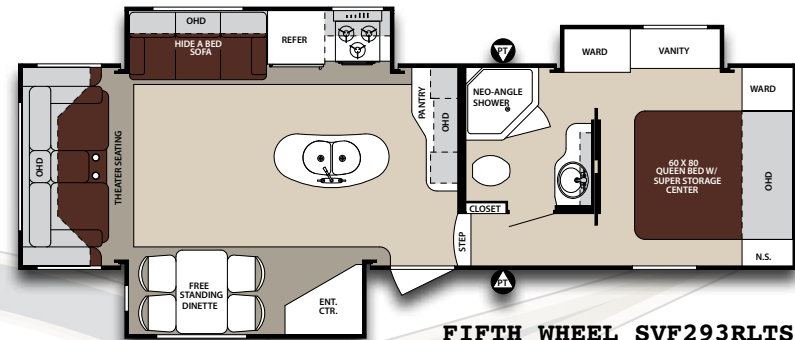

FIFTH WHEEL SVF293RLTS

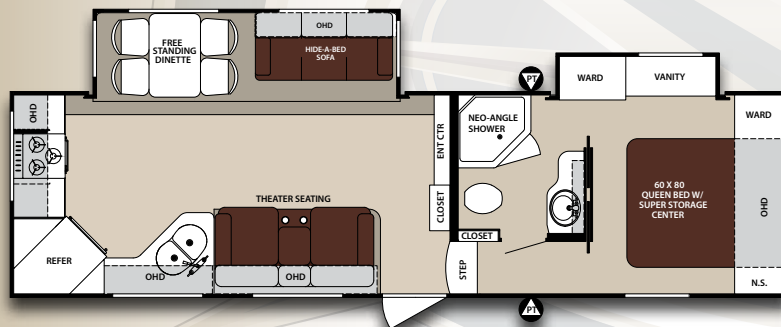

FIFTH WHEEL SVF292RKDS

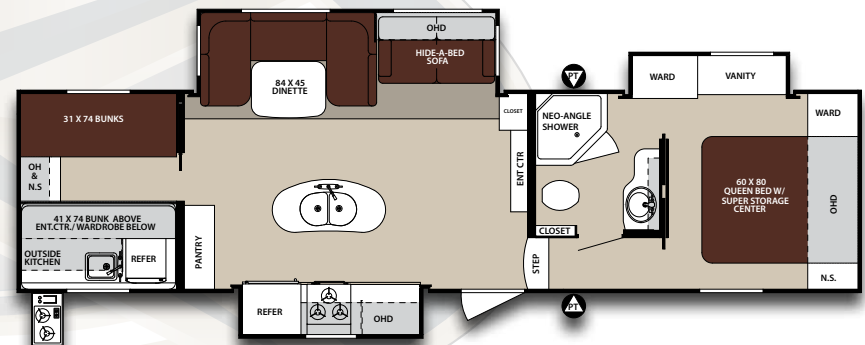

FIFTH WHEEL SVF320BHTS

## SPECIFICATIONS

MODEL	SVF278RLDS	SVF292RKDS	SVF293RLTS	SVF320BHTS
*TOTAL DRY WEIGHT	7769	8266	8496	8943
LOAD CAPACITY	2481	3398	3456	2690
HITCH WEIGHT	1450	1504	1792	1473
OVERALL LENGTH	30'4"	32'10"	32'10"	35'8"
EXTERIOR WIDTH	8'0"	8'0"	8'0"	8'0"
EXTERIOR HEIGHT W A/C	12'5"	12'3"	12'7"	12'10"
FRESH WATER(GAL)	47	47	47	47
GREY WATER(GAL)	75	75	75	75
BLACK WATER(GAL)	35	35	35	35
AWNING SIZE	12'	20'	20'	20'

\*We know weights and dimensions are an important part of your buying decision. Surveyor weighs every model to ensure accuracy, although refinements to the product can create variations to weights and dimensions. Review a current model at your nearest authorized Surveyor Dealer today.







# SURVEY THE ADVANTAGES

*Cadet*

*Sport*

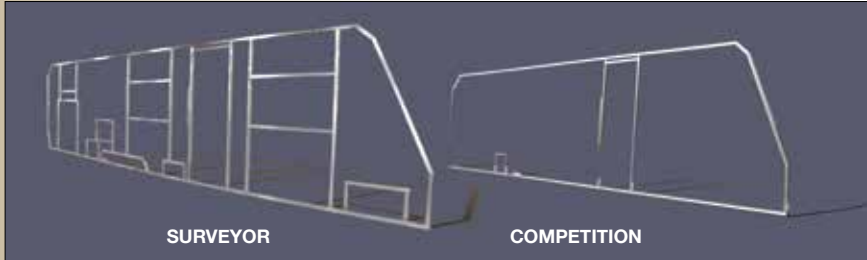

SURVEYOR

COMPETITION



## SUPERIOR CONSTRUCTION

Surveyor is one of the strongest light weight trailers because of our aluminum framed openings and lamination process. High quality materials, 100% glue coverage and fully framed aluminum floor, roof, walls, front and backs provide you a structure for peace of mind. Not found in most RV's today.

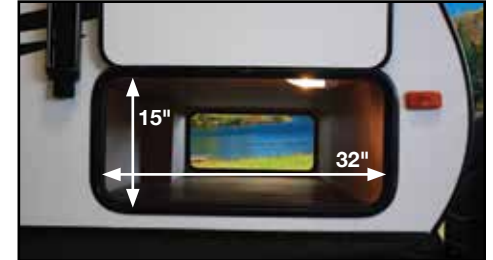

## PASS THRU STORAGE

You will find all the room you need in your fully finished exterior compartment, the large 32" X 15" baggage door gives you plenty of room for all your camping needs. No raw wood or exposed aluminum here, just the quality and peace of mind you deserve.



## LED AWNING LIGHT

The integrated LED awning light provides you with an abundance of light for added safety and security. (Standard in Exterior Luxury package)



## FRESH WATER

Like to carry this much fresh water? You can now, Surveyor's 46 gallon fresh water tank allows you to camp longer.



## RADIUS SHOWER CURTAIN

You will have a little more room to move around in your shower with our residential style radius door. With the curved design and sliding door you won't have to worry about that plastic shower curtain sticking to you or allowing water to get out.



## SOLID OAK CABINETRY

Quality, solid built cabinet doors are all raised panel, not only the upper doors but the lower doors as well. Some manufacturers put in the raised uppers, but not the lowers to save money, just open and close the doors a and you will feel the quality of our doors. You will also quickly notice our residential hidden and adjustable hinges.



## EZ GLIDE TABLE

Setting up your dinette for eating or sleeping is made "EZ" with our convenient swing up and down table, no more lifting that heavy bulky table, just pull the release, it's that "EZ". Want to use it in more ways? In the down position it makes a great coffee table or even take it outside.

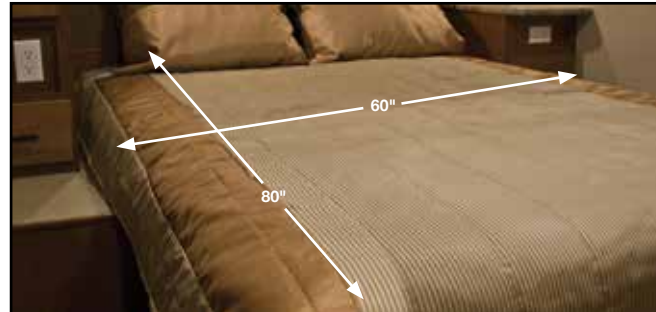

## 60" X 80" MATTRESS

You'll sleep like a King on our fully sized bed, don't be fooled by those "RV" or "short" queen sized beds. We give you the extra room so you can stretch out and not have you feet hanging off the end of the bed. We can also provide you an upgraded Serta™ mattress for even more comfort.



## BARRELED ROOF CONSTRUCTION

Our barreled roof gives you the height you deserve, the 82 1/2" interior headroom is one of the highest in its class. The radius aluminum roof rafters on 16" centers and consistent thickness of the rafters gives you one of the strongest roofs today, we even offer a rear ladder for easy access to clean and maintain your seals. If the trailer that you are considering doesn't offer this, there is a pretty simple reason for that, they don't want you on their roof. Makes you wonder how strong is it?





*Pilot*



**FIFTH WHEEL**



**ONE PIECE PAINTED FIBERGLASS FRONT CAPS**

Surveyor's one piece painted fiberglass front caps provide superior aerodynamics to help save fuel and protect from road debris. Our convenient LED docking lights help you light up when hooking or unhooking at night.

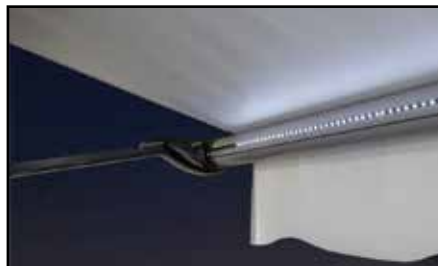

**LED AWNING LIGHT**

The integrated LED awning light provides you with an abundance of light for added safety and security. (Standard in Exterior Luxury package)

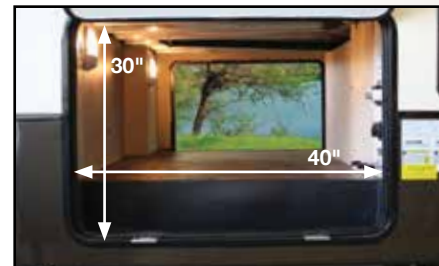

**EXTERIOR STORAGE**

Our Fifth Wheels give you even more room with our 40" X 30" storage door and our "Z" frame design, largest storage in its class.



**BATTERY DISCONNECT**

Standard in all Fifth Wheels, this convenient switch lets you power down all 12V.



**UTILITY CENTER (FW)**

Our centralized utility center provides all of your hook-ups in one convenient location. Standard on all Fifth Wheels.



**FIREPLACE AND 50 AMP SERVICE**

Standard on Fifth Wheels and optional on Pilots. No worries about having enough power to run all of your appliances. The fireplace offers additional electric heat, saves on your propane costs.



**8 CUBIC FOOT REFRIGERATOR**

Standard on all Fifth Wheels and Pilot travel trailers, this large refrigerator provides you more room for all your perishables.

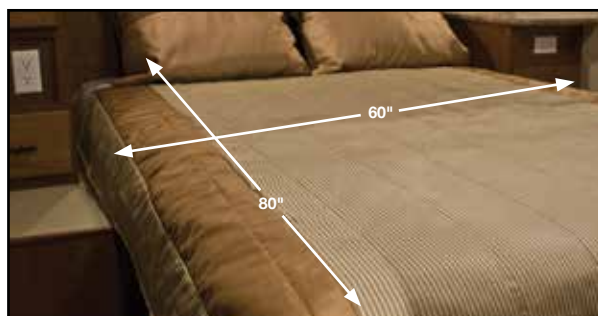

**60" X 80" MATTRESS**

You'll sleep like a King on our fully sized bed, don't be fooled by those "RV" or "short" queen sized beds. We give you the extra room so you can stretch out and not have your feet hanging off the end of the bed. We can even provide you an upgraded Serta™ mattress for even more comfort.



**40" SHOWER**

Our spacious 40" one piece fiberglass shower with triple sliding doors and 59" adjustable slide shower head.



**DYSON CLOSET**

Standard on Fifth Wheels, the portable Dyson Vacuum allows you to sweep on any surface, vinyl or carpet. With the easy clean out, you don't have to worry about dusty, damp bags you have to dump.



**SOLID SURFACE COUNTERTOP**

Standard on all Fifth Wheels and Pilot travel trailers, our solid surface countertops give you the high end amenities you deserve.



**BARRELED ROOF CONSTRUCTION (TT)**

Our barreled roof gives you the height you deserve, the 82 1/2" interior headroom is one of the highest in its class. The radius aluminum roof rafters on 16" centers and consistent thickness of the rafters gives you one of the strongest roofs today, we even offer a rear ladder for easy access to clean and maintain your seals. If the trailer that you are considering doesn't offer this, there is a pretty simple reason for that, they don't want you on their roof. Makes you wonder how strong is it?



# PACKAGES

## CADET

**INTERIOR LUXURY PACKAGE:** RAISED PANEL CABINET DOORS WITH RESIDENTIAL HIDDEN HINGES, AM/FM/CD/DVD STEREO SYSTEM WITH REMOTE CONTROL, 6 GAL. G/E DSI WATER HEATER, DUCTED AIR CONDITIONING WITH "QUICK COOL" FEATURE, DOUBLE DOOR REFRIGERATOR, SKYLIGHT OVER TUB/SHOWER QUILTED TENT/BUNK MATTRESSES (WHERE APPLICABLE).

**EXTERIOR LUXURY PACKAGE:** LED AWNING LIGHT BAR, 20# LP BOTTLES WITH ABS COVER, DETACHABLE 30 AMP POWER CORD, DUAL BATTERY RACK, BLACK TANK FLUSH, OUTSIDE SHOWER, OUTSIDE STEREO SPEAKERS, FOUR SCISSOR STABILIZING JACKS, SPARE TIRE WITH COVER & LARGER HOLDING TANKS (46 GALLON FRESH WATER/40 GALLON GREY TANK).

**CROWN PACKAGE:** JENSEN "BLUETOOTH" AM/FM/CD/DVD STEREO SYSTEM WITH REMOTE CONTROL, 40" ACOUSTIK SOUND BAR, KEYLESS ENTRY DOOR LOCK, RESIDENTIAL GOOSE NECK FAUCET WITH PULL OUT SPRAYER, POWER TONGUE JACK AND SATELLITE CONNECTIONS FOR BEDROOM AND OUTSIDE TV.

## SPORT

**INTERIOR LUXURY PACKAGE:** RAISED PANEL CABINET DOORS WITH RESIDENTIAL HIDDEN HINGES, SKYLIGHT OVER TUB/SHOWER, AM/FM/CD/DVD STEREO SYSTEM WITH REMOTE CONTROL, 28" LED JENSEN FLAT SCREEN TV, E-Z GLIDE DINETTE TABLE, 6 GAL. G/E DSI WATER HEATER, QUILTED BUNK MATTS AND RADIUS SHOWER CURTAIN WITH TRACK (WHERE APPLICABLE).

**EXTERIOR LUXURY PACKAGE:** ELECTRIC AWNING WITH LED LIGHT BAR, 30# LP BOTTLES WITH ABS COVER, DETACHABLE 30 AMP POWER CORD, EXTERIOR TV BRACKET, OUTSIDE STEREO SPEAKERS, LARGE FOLDING ASSIST HANDLE, FULLY ENCLOSED UNDERBELLY, BLACK TANK FLUSH, OUTSIDE SHOWER AND LARGER HOLDING TANKS (46 GALLON FRESH WATER/40 GALLON GREY TANK).

**CROWN PACKAGE:** JENSEN "BLUETOOTH" AM/FM/CD/DVD STEREO SYSTEM WITH REMOTE CONTROL, 40" ACOUSTIK SOUND BAR, KEYLESS ENTRY DOOR LOCK, RESIDENTIAL GOOSE NECK FAUCET WITH PULL OUT SPRAYER, POWER TONGUE JACK, FOLD DOWN BIKE RACK AND SATELLITE CONNECTIONS FOR BEDROOM AND OUTSIDE TV.

## PILOT

**INTERIOR LUXURY PACKAGE:** JENSEN 32" LED TV, RAISED PANEL CABINET DOORS WITH RESIDENTIAL HIDDEN HINGES, 22" OVEN & 3 BURNER RANGE, 40" FIBERGLASS SHOWER WITH TRIPLE SLIDING GLASS DOOR, RESIDENTIAL SHOWER HEAD WITH 59" SLIDE BAR, PLEATED NIGHT SHADES, FREE STANDING DINETTE WITH FOUR CHAIRS, SOFA HIDE-A-BED, 80" QUEEN BED WITH "EVERGREEN" MATTRESS AND 82" BARRELED CEILING.

**EXTERIOR LUXURY PACKAGE:** ELECTRIC AWNING WITH LED LIGHT BAR, PAINTED FIBERGLASS FRONT CAP WITH LED DOCKING LIGHTS, ALUMINUM SPLIT SPOKE RIMS, SLAM LATCH BAGGAGE DOORS, "COOL VANILLA" GEL-COATED FIBERGLASS, 30" ENTRANCE DOOR, OUTSIDE STEREO SPEAKERS, BLACK TANK FLUSH, FOLDING ASSIST GRAB HANDLE AND DETACHABLE POWER CORD.

**CROWN PACKAGE:** JENSEN "BLUETOOTH" AM/FM/CD/DVD STEREO SYSTEM WITH REMOTE CONTROL, 40" ACOUSTIK SOUND BAR, KEYLESS ENTRY DOOR LOCK, SOLID SURFACE KITCHEN COUNTERTOPS WITH UNDER MOUNT SINK, SOLID SURFACE SINK COVERS, RESIDENTIAL KITCHEN FAUCET WITH SPRAYER, SATELLITE READY AT LIVING ROOM, BEDROOM & OUTSIDE TV LOCATIONS, 8 CU. FT. DOUBLE DOOR REFRIGERATOR AND POWER TONGUE JACK.

## FIFTH'S

**INTERIOR LUXURY PACKAGE:** 32" LED JENSEN FLAT SCREEN TV, SOLID SURFACE KITCHEN COUNTERTOPS WITH UNDER MOUNT SINK AND SOLID SURFACE SINK COVERS, STOVE COVER, RAISED PANEL CABINET DOORS WITH RESIDENTIAL HIDDEN HINGES, SKYLIGHT OVER SHOWER, 6 GAL. G/E DSI WATER HEATER, PLEATED NIGHT SHADES, ELECTRIC FIREPLACE, HIDE-A-BED SOFA, 8 CU. FT. REFRIGERATOR AND QUILTED BUNK MATTS, (WHERE APPLICABLE).

**EXTERIOR LUXURY PACKAGE:** 15K AIR CONDITIONER, REAR ELECTRIC STABILIZER JACKS, ELECTRIC FRONT LANDING GEAR WITH SNAP PINS, ELECTRIC AWNING WITH LED LIGHT BAR, OUTSIDE SPEAKERS, LARGE FOLDING ASSIST HANDLE, 12V BATTERY DISCONNECT SWITCH, BLACK TANK FLUSH, OUTSIDE SHOWER WITH 15' SPRAYER HOSE, BUILT IN UTILITY CENTER, FULLY ENCLOSED UNDERBELLY, SLAM LATCH BAGGAGE DOORS, ALUMINUM SPLIT SPOKE RIMS, DETACHABLE 50 AMP POWER CORD AND LED DOCKING LIGHTS.

**CROWN PACKAGE:** JENSEN "BLUETOOTH" AM/FM/CD/DVD STEREO SYSTEM WITH /REMOTE CONTROL, 40" ACOUSTIK SOUND BAR, KEYLESS ENTRY DOOR LOCK, RESIDENTIAL GOOSE NECK FAUCET WITH PULL OUT SPRAYER, FOLD DOWN BIKE RACK AND SATELLITE CONNECTIONS FOR BEDROOM AND OUTSIDE TV.

### APPLIANCES/EQUIPMENT

	CADET	SPORT	PILOT	FIFTH'S
Dometic, G/E Flush-Mount Refrigerator	X	X	X	X
Power Range Hood w/ Light	X	X	X	X
Six Gallon G/E DSI Water Heater				
w/ Quick Recovery	X	X	X	X
Three Burner Range Top	X	X	X	X
Gas Oven with Piezo Ignition	X	X	X	X
Microwave Oven	X	X	X	X
20,000 BTU Furnace (Ducted 23'-26')	X	X	N/A	N/A
30,000 BTU Ducted Furnace (27' and Above)	X	X	X	X
13.5K Air Conditioning (Ducted ALL MODELS)	X	X	X	N/A
15K Air Conditioning (Ducted ALL MODELS)	O	O	O	X
Digital Wall Thermostat	X	X	X	X
Stereo CD/DVD with MP3/SD Card/USB				
Ports and Remote Control	X	X	X	X

### BATH

Fiberglass Tub/Shower	X	X	X	X
Adjustable Shower Head/Faucet	X	X	X	X
Lavatory Sink and Faucet	X	X	X	X
Wood Medicine Cabinet with Mirror	X	X	X	X
Thetford Commode with Foot Flush	X	X	X	X
Skylight in Tub/Shower	X	X	X	X
Monitor Panel	X	X	X	X

### CONSTRUCTION

Full Aluminum Cage Construction	X	X	X	X
Full Walk on Roof	X	X	X	X
Radius Roof with Aluminum Trusses				
16" on Center (82" of headroom)	X	X	X	X
3/8" Decking	X	X	X	X
2" Laminated Sidewall (R9)	N/A	N/A	X	X
1-1/2" Laminated Sidewall (R7)	X	X	N/A	N/A
2" Laminated Floor (R9)	X	X	X	X
Electric Powered Slide-Out Mechanism				
with/ Manual Override	X	X	X	X

### ELECTRICAL

Detachable 28', 30-amp Power Cord	X	X	X	NA
Detachable 28', 50-amp Power Cord	O	O	O	X
Outside TV Bracket	N/A	X	X	X
Cable Connection on Door Side	X	X	X	X
55 amp Converter with Charger	X	X	X	X
Exterior 120 volt Recept	X	X	X	X
Patio Light with Amber Lens	X	X	X	X
Hitch Light	X	X	X	X
Pass Thru Storage Light	X	X	X	X
12-volt Interior Lighting	X	X	X	X
120-volt GFI Protected Circuit Safety	X	X	X	X
Cable & Satellite Ready	X	X	X	X

### EXPANDABLE BEDS

Attached Vinyl Weathershield Tent(s)	X	N/A	N/A	N/A
Automotive Rubber Gasket				
and Compression Latches	X	N/A	N/A	N/A
Quilted Bunk Cushions	X	N/A	N/A	N/A
Radius Door w/ Hinge	X	N/A	N/A	N/A
1,000# Capacity	X	N/A	N/A	N/A



# STANDARDS AND OPTIONS

## SAFETY

	CADET	SPORT	PILOT	FIFTH'S
Break-Away Switch	X	X	X	X
Fire Extinguisher	X	X	X	X
LP Detector	X	X	X	X
Smoke Detector	X	X	X	X
Ground Fault Protected Electrical Circuit(s)	X	X	X	X
Dead-Bolt Door Lock	X	X	X	X
Safety Chains	X	X	X	N/A
CO <sup>2</sup> Detector	X	X	X	X
Tinted Safety Glass	X	X	X	X

## EXTERIOR

One Piece Roof Membrane with 12 Year Warranty	X	X	X	X
Radius Corner Windows	X	X	X	X
Flush Mount Outside Storage Compartment(s) w/ Rubber D-Seal	X	X	X	X
Flush Mount "Slam Latch" Outside Storage Compartment(s) w/ Rubber D-Seal	N/A	N/A	X	X
Self-Storing Double Entrance Step(s)	X	X	X	N/A
Self-Storing Triple Entrance Steps (Some models)	X	X	X	X
Butyl Tape Sealant on Seams	X	X	X	X
Combination Entrance/Screen Door w/ Dead-Bolt Lock	X	X	X	X
Designer Exterior Graphics	X	X	X	X
20# LP tanks w/ Molded Cover	X	N/A	N/A	N/A
30# LP tanks w/ Molded Cover	N/A	X	X	X
Enclosed Underbelly	O	X	N/A	N/A
Heated Enclosed Underbelly (Select models sport)	N/A	X	X	X
Extended Drip Rail and Down Spout	X	X	X	X
Electric Awning w/ Adjustable Rain Dump	O	X	X	X
Manual Awning	X	N/A	N/A	N/A
LED Awning Light	X	X	X	X
Heavy Duty Scissor Jacks	X	X	X	N/A
Omni-Directional TV Antenna	X	X	X	X
Dual Battery Rack	X	X	X	X
4" Square Bumper w/ Sewer Hose Storage	X	X	X	X
Outside Shower	X	X	X	X
Spare Tire w/ Carrier	X	X	X	X

## INTERIOR

Deep Double-Bowl Kitchen Sink w/ High Rise Faucet	X	X	X	X
Knife Block Behind Stove	X	X	X	X
Panoramic Galley Window	X	X	X	X
Valances with Mini-Blinds	X	X	N/A	N/A
Designer Carefree® Flooring	X	X	X	X
Solid Lumber Core Cabinet Fronts Assembled w/ Screws	X	X	X	X
Residential Style Cabinet Doors w/ Concealed Hinges	X	X	X	X
Power Range Hood with Light	X	X	X	X
Residential Style Wood Drawers w/ Ball Bearing Glides	X	X	X	X
In-Floor Heat Ducts (Where available)	N/A	X	X	X
82 1/2" Interior Height	X	X	X	X
80# Gas Bed Struts (Queen beds)	X	X	X	X
Adjustable Shelves in Pantry (Where applicable)	X	X	X	X
E-Z Glide Dinette Table	N/A	X	X	X
Ceiling Light Switch at Entrance Door	X	X	X	X
60x80 Queen Beds	X	X	X	X
Screwed & Glued Cabinetry	X	X	X	X
Sink Cover(s)	O	O	X	X
Stove Cover	O	O	X	X
Shaw® r2x Stain and Soil Resistant Carpet	N/A	X	X	X

## PLUMBING

Black Tank Flush	X	X	X	X
Color-Coded Water Lines	X	X	X	X
Copper Gas Lines, Double Flared	X	X	X	X
Rotocast Holding Tanks, Underfloor	X	X	X	X
Rotocast Fresh Water Tank, Underfloor	X	X	X	X
Demand Waterpump, 12-volt	X	X	X	X
City Water Fill	X	X	X	X
Gravity Water Fill	X	X	X	X
Water Heater Bypass Kit	X	X	X	X
Winterization Kit	X	X	X	X

## RUNNING GEAR

Super-Lube Hubs	X	X	X	X
Galvanized Steel Wheel Wells	X	X	X	X
Equa-Flex Suspension System (N/A SC-191T)	O	O	O	O
Leaf Spring Axle(s)	X	X	X	X
Radial Trailer Tires	X	X	X	X
Nev-R-Adjust® Electric Brakes, All Wheels	X	X	X	X
Tough, Powder Coated Frame	X	X	X	X
2-5/16" Coupler	X	X	X	N/A
205/75/R14C Tires (Model specific)	X	X	N/A	N/A
225/75/R15D Tires (Model specific)	X	X	X	X

## SURVEYOR OPTIONS

Crown Package	X	X	X	X
Interior Luxury Package	X	X	X	X
Exterior Luxury Package	X	X	X	X
15K Air Conditioner IPO 13.5 BTU A/C	O	O	O	X
Serta® Mattress	O	O	O	O
Pleated Night shades	O	O	X	X
Roof Ladder (N/A SC192T, SC225T, SC224T & SC226RBDs)	O	O	O	O
Outside Gas Grill	O	O	O	O
Jensen 19" LED TV (SC191T, SC192T, SC224T & SC225T)	O	N/A	N/A	N/A
Jensen 28" LED TV (SC201RBS, SC226RBDs, SC280BHS, SC291BHSS & SC321BHTS)	O	ILP	N/A	N/A
Jensen 28" LED TV for Bedroom	N/A	O	O	O
Jensen 32" LED TV	N/A	N/A	ILP	ILP
Raised Panel Refer Door Inserts	O	O	O	O
Hide-A-Bed Sofa (Select models)	O	O	X	X
Arctic Package (12V heat pads)	O	O	O	O
Power Tongue Jack	O	O	O	N/A
Slide-Out Awning Topper	O	O	O	O
CO <sup>2</sup> Detector (Required in all models)	X	X	X	X
Power Stabilizer Jacks	N/A	O	O	O
Fantastic Fan	O	O	O	O
Two (2) Bar stools (SC291BHSS, SV27RBS & SVF278RLDS)	O	O	O	O
8' cu. ft. Refer	N/A	N/A	X	X
Aluminum Wheels	O	O	X	X
Fireplace	O	O	O	X
Detachable 28', 50-amp Power Cord	O	O	O	X
Dyson Cordless Vacuum	N/A	N/A	N/A	X

X = STANDARD EQUIPMENT, O = OPTIONAL, ILP= INTERIOR LUXURY PACKAGE  
N/A = NOT APPLICABLE

## SURVEYOR WARRANTY INFORMATION

For Details on Surveyor's complete warranty program, see your Surveyor dealer. Surveyor offers the following additional limited warranties to the original purchasers. Consult written warranty for details.

1. Twelve year roof membrane warranty
2. Two year fiberglass warranty
3. Two year axle warranty
4. One year bumper to bumper warranty
5. Available second-year warranty



JAVA



SADDLE



PEBBLE





**PRE-DELIVERY INSPECTION FACILITY**  
20,000 square feet of quality assurance. The bare essentials for a premium product. This state-of-the-art facility gives immediate daily feedback to production for quality assurance in every unit built.

#### 24/7 EMERGENCY ROADSIDE ASSISTANCE

For a worry-free ownership experience Forest River includes one year of Coach-Net RV Technical & Roadside Assistance with each RV purchase. Whether new to the RV lifestyle or an experienced RV enthusiast, Forest River owners have 24/7 access to technical, operational and emergency road service coverage throughout the US & Canada. Coach-Net's fast, dependable service is just a phone call away.

**Coach-Net®**

RV Technical & Roadside Assistance



Forest River, Inc. encourages our customers to purchase their Forest River products from a local dealership whenever possible for the following reasons:

- 1) Forest River, Inc. dealers are independently owned and operated businesses so priority service and scheduling is at their discretion and is often provided to customers that purchased their unit at that dealership.
- 2) Purchasing locally allows customers to establish meaningful relationships with a dealer, enhancing the RV experience through assistance with product questions, user tips or RV regulations for your state or country, and much more!
- 3) Canadian customers must meet requirements to bring an RV purchased out of the country to their home. These requirements may involve additional inspections and certifications, taxes and fees. Your local Canadian Dealer is a professional at meeting these requirements.
- 4) Scheduling timely warranty repairs and adjustments through a local dealership provides far greater flexibility and convenience to you, the customer!

It is the goal of Forest River, Inc. that all of our RV owners fully enjoy the RV experience and that customer satisfaction meets or exceeds their expectations!



**Learn More**  
Scan this barcode using a QR Reader on your smart phone to learn more about Forest River.



A Berkshire Hathaway company.

Forest River, Inc.  
2405 Century Dr.  
Goshen, IN 46528  
(574) 642-3119  
[www.forestriverinc.com/surveyor](http://www.forestriverinc.com/surveyor)  
[www.forestriveraccessories.com](http://www.forestriveraccessories.com)