

# ZINGER



**CROSSROADS**  
*Recreational Vehicles*

\*LITE MODELS

\*STANDARD MODELS

| MODEL    | DRY WT. | GVWR  | HITCH | FRESH  | BLACK  | GRAY   | CC   | LENGTH  | HEIGHT |
|----------|---------|-------|-------|--------|--------|--------|------|---------|--------|
| ZR-18BH  | 3246    | 4520  | 520   | 27 Gal | 30 Gal | 30 Gal | 1274 | 21' 11" | 9' 7"  |
| ZR-18RD  | 3290    | 4520  | 524   | 27 Gal | 30 Gal | 30 Gal | 1230 | 21' 6"  | 9' 7"  |
| ZR-18RK  | 3410    | 4470  | 476   | 27 Gal | 30 Gal | 30 Gal | 1060 | 22' 6"  | 9' 7"  |
| ZR-18BS  | 3694    | 4490  | 496   | 27 Gal | 30 Gal | 30 Gal | 796  | 22' 6"  | 9' 7"  |
| ZR-18DS  | 4350    | 5570  | 466   | 45 Gal | 30 Gal | 30 Gal | 1220 | 22' 6"  | 10' 3" |
| ZR-205BH | 4407    | 7540  | 540   | 45 Gal | 30 Gal | 30 Gal | 3133 | 24' 11" | 10' 5" |
| ZR-211RD | 4364    | 6500  | 552   | 45 Gal | 30 Gal | 30 Gal | 2136 | 25' 2"  | 10' 5" |
| ZR-229RB | 5510    | 7730  | 730   | 51 Gal | 44 Gal | 88 Gal | 2220 | 26' 9"  | 10' 5" |
| ZR-252BH | 5003    | 7560  | 564   | 45 Gal | 30 Gal | 30 Gal | 2557 | 28' 11" | 10' 5" |
| ZR-254RB | 6042    | 7810  | 818   | 51 Gal | 44 Gal | 88 Gal | 1768 | 29' 6"  | 11' 2" |
| ZR-258BH | 6308    | 9610  | 810   | 51 Gal | 44 Gal | 88 Gal | 3302 | 29' 11" | 11' 2" |
| ZR-280BH | 6589    | 9480  | 680   | 51 Gal | 44 Gal | 88 Gal | 2891 | 32' 6"  | 11' 2" |
| ZR-280RK | 6660    | 9610  | 808   | 51 Gal | 44 Gal | 88 Gal | 2950 | 32' 11" | 11' 2" |
| ZR-285RL | 6521    | 9520  | 720   | 51 Gal | 44 Gal | 44 Gal | 2999 | 32' 6"  | 11' 2" |
| ZR-288RR | 5828    | 7930  | 934   | 51 Gal | 44 Gal | 44 Gal | 2102 | 32' 11" | 11' 0" |
| ZR-290KB | 6619    | 9670  | 868   | 51 Gal | 44 Gal | 44 Gal | 3051 | 33' 6"  | 11' 2" |
| ZR-292RE | 7117    | 9600  | 802   | 51 Gal | 44 Gal | 44 Gal | 2483 | 33' 6"  | 11' 2" |
| ZR-298BH | 6814    | 9620  | 828   | 51 Gal | 88 Gal | 88 Gal | 2806 | 33' 11" | 11' 2" |
| ZR-320FB | 7600    | 9840  | 1040  | 51 Gal | 44 Gal | 44 Gal | 2240 | 35' 11" | 11' 3" |
| ZR-326BH | 7892    | 9800  | 1008  | 51 Gal | 88 Gal | 88 Gal | 1908 | 36' 11" | 11' 3" |
| ZR-328SB | 7756    | 9740  | 942   | 51 Gal | 44 Gal | 44 Gal | 1984 | 36' 6"  | 11' 3" |
| ZR-330BH | 7916    | 9800  | 1004  | 51 Gal | 88 Gal | 44 Gal | 1884 | 37' 6"  | 11' 3" |
| ZR-331BH | 8770    | 11400 | 1208  | 51 Gal | 88 Gal | 44 Gal | 2630 | 37' 6"  | 11' 3" |
| ZR-333DB | 8214    | 10400 | 904   | 51 Gal | 88 Gal | 44 Gal | 2186 | 37' 7"  | 11' 3" |
| ZR-338RR | 7302    | 9990  | 1194  | 51 Gal | 44 Gal | 88 Gal | 2688 | 37' 6"  | 11' 3" |

www.crossroadsrv.com • (260) 593 - 3850

\*SEE WEBSITE FOR ADDITIONAL SPECS



18BH



18RD



18RK



18BS

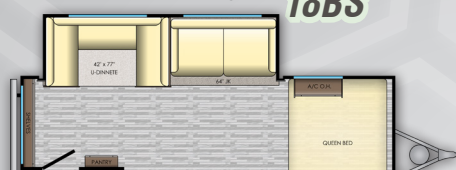

18DS



205BH



211RD



229RB

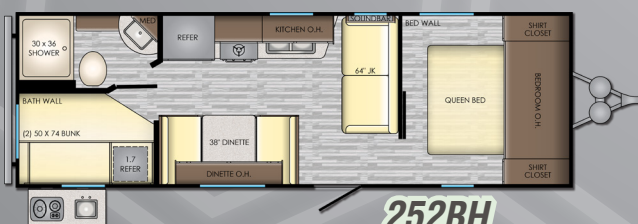

252BH



254RB

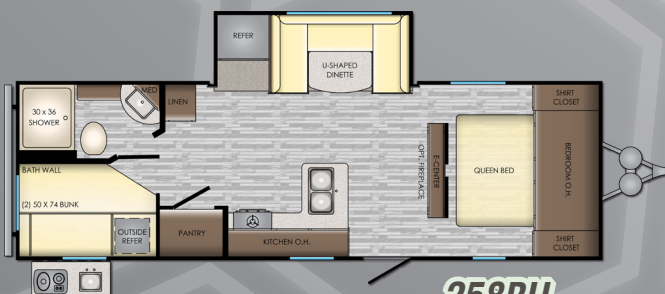

258BH



280BH



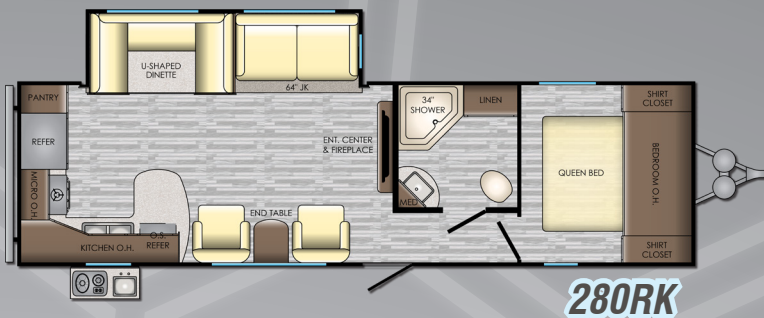

**280RK**

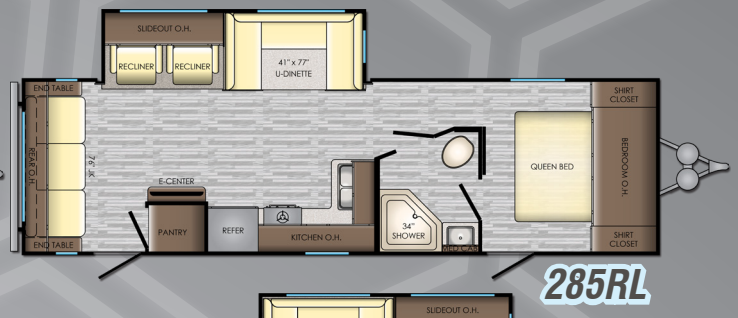

**285RL**

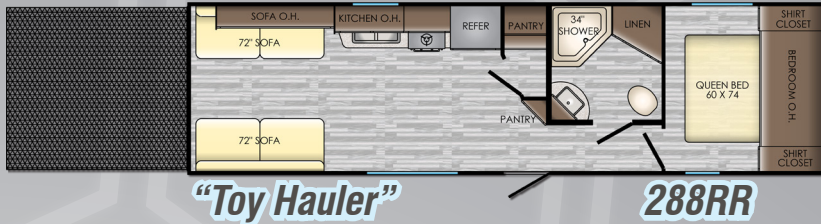

**"Toy Hauler"**

**288RR**



**290KB**

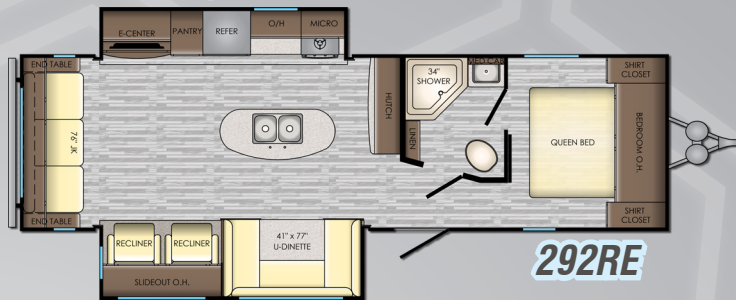

**292RE**

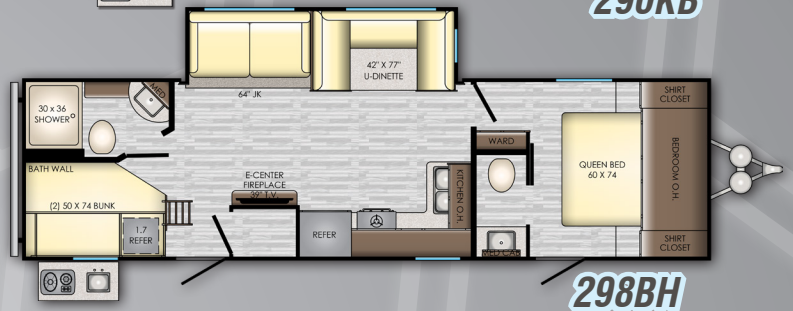

**298BH**

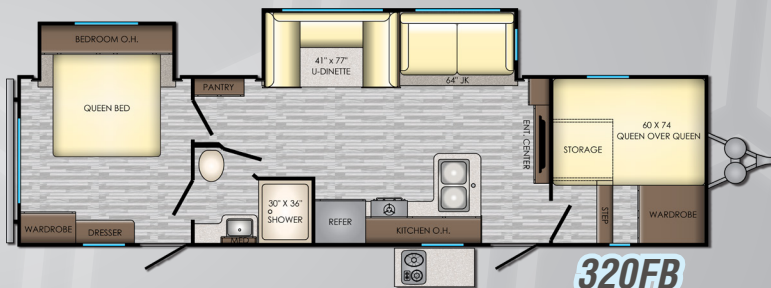

**320FB**

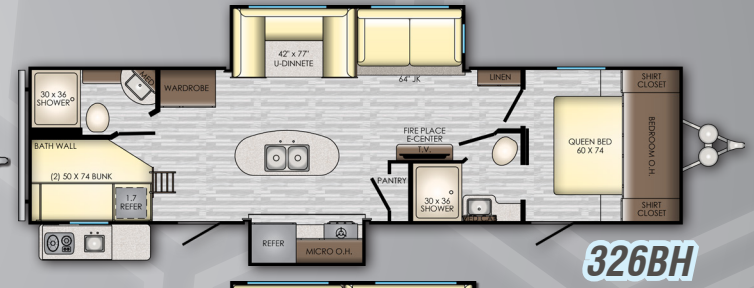

**326BH**



**328SB**



**330BH**

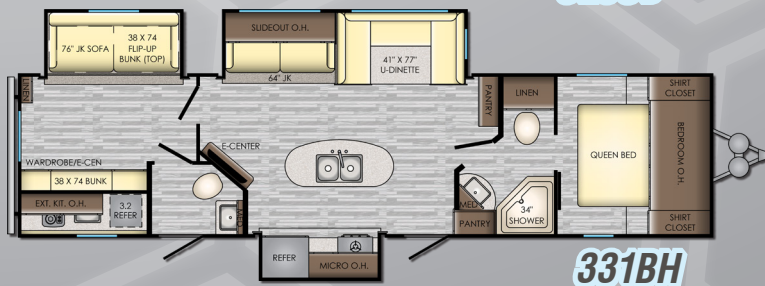

**331BH**

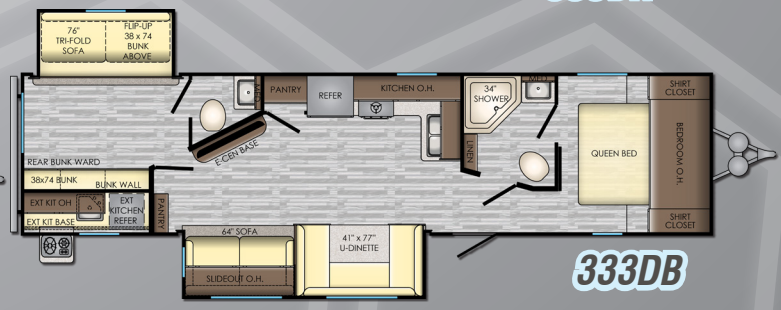

**333DB**

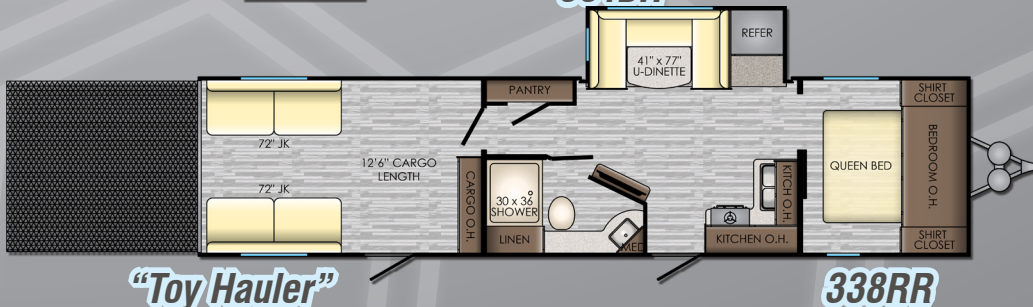

**"Toy Hauler"**

**338RR**

**ZINGER**



# STANDARDS & OPTIONS

## STANDARDS

### LIVING ROOM

- Designer Valances
- Storage Doors Below Booth Dinette (VBM)
- Three Decor Options
- Wood Slide-Out Fascia
- AM/FM Stereo System w/ Bluetooth Soundbar
- Residential Wood Blinds (VBM)
- Chair Rail in Slide-Out
- Flush Floor Slide-Out w/ Large Dinette Windows
- Sleeper Sofa
- LED Lighting
- LED Accent Lighting
- Generous Storage
- 81" Interior Ceiling Height
- USB Port
- Fireplace (VBM)
- Super Booth Dinette (VBM)

### KITCHEN

- Stainless Steel High Rise Faucet
- Backsplash (VBM)
- Stainless Steel Sink
- Range Hood w/ Light & Exhaust Fan
- Wall Mounted System Monitor Panel (VBM)
- Maple Cabinet Doors
- 6 Cu. Ft. Gas/Electric Refrigerator (VBM)
- Maple Cabinet Drawers
- Steel Ball Bearing Drawer Guides
- Oven
- Microwave

### BATHROOM

- Large Lavatory Bowl
- Spacious Shower/Tub & One-Piece Surround
- Foot Flush Toilet
- Mirrored Medicine Cabinet
- Linen Storage (VBM)
- Glass Shower Door & Neo Angle Shower (VBM)
- Shower Curtain w/ Curved Shower Track (VBM)

### BEDROOM

- 60" X 74" Mattress
- TV Hook-up
- Coordinated Window Treatments
- Bedspread
- Night Stands w/ Outlets on Each Side
- USB Outlet

### EXTERIOR

- Fully Enclosed and Forced Air Heated Underbelly (VBM)
- Backup Camera Prep
- Solar Prep
- Friction Hinge Entry Door
- Keyed-A-Like Exterior Doors
- Aerodynamic Front End
- Easy Open Entry Step
- Bumper with Drain Hose Storage and End Caps
- Speakers w/ LED Accents
- Molded Rain Gutters with 3" Drip Spouts
- Large Assist Grab Handle - (VBM)
- Black Tank Flush - (VBM)
- Secure Stance Steps (Main Door) (VBM)
- 6 Gal Gas/Elec DSI Water Heater (VBM)
- Outside Shower (VBM)
- Radial Tires

## OPTIONS

- Upgraded Insulation
- Rear Ladder
- 15K BTU Main A/C
- 50 Amp Service w/ 2<sup>nd</sup> A/C Prep (2+ Slides Only)
- 2<sup>nd</sup> A/C in Bedroom (13.5K)
- 39" TV (VBM)
- 50" TV (VBM)

### SINGLE AXLE OPTIONS

- 13.5K A/C (8K Standard)
- 2 Stabilizer Jacks - Lite Single Axle
- Spare Tire - Lite Single Axle

\*VBM: Varies By Model

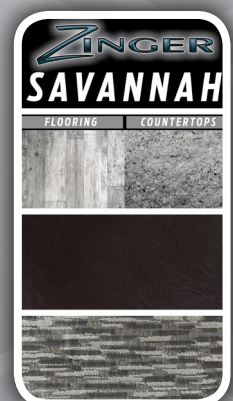

www.crossroadsrv.com • 1140 W. Lake St Topeka, IN 46571 • (260) 593 - 3850

DISCLAIMER: Product information is as accurate as possible as of the date of publication of this brochure. All features, floor plans, and specifications in this brochure are subject to change without notice. Please also consult CrossRoads' web site at [www.crossroadsrv.com](http://www.crossroadsrv.com) for more current product information and specifications. Tow Vehicle Disclaimer. CAUTION: Owners of CrossRoads recreational vehicles are solely responsible for the selection and proper use of tow vehicles. All customers should consult with a motor vehicle manufacturer or their dealer concerning the purchase and use of suitable tow vehicles for CrossRoads products. CrossRoads disclaims any liability or damages suffered as a result of the selection, operation, use or misuse of a tow vehicle. CROSSROADS' LIMITED WARRANTY DOES NOT COVER DAMAGE TO THE RECREATIONAL VEHICLE OR THE TOW VEHICLE AS A RESULT OF THE SELECTION, OPERATION, USE OR MISUSE OF THE TOW VEHICLE. REFERENCE CROSSROADS RV COMPANY OWNERS MANUAL FOR LIMITED WARRANTY DETAILS. \*Length is defined as the distance from the centerline of hitch pin/coupler to rear bumper of trailer.



Sept. 2018