

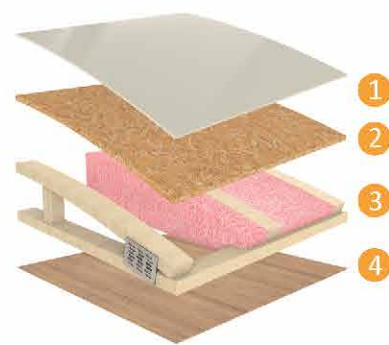

## DUTCHMEN® CONSTRUCTION ADVANTAGE



### Durable Roof Structure

- 1 TPO Roof
- 2 3/8" Decking
- 3 Fiberglass Insulation
- 4 Lauan Interior Panel

- ### Insulated Structure
- 1 Metal Exterior Panel
  - 2 Wood Frame with R7 Thermal Insulation
  - 3 Lauan Interior Panel

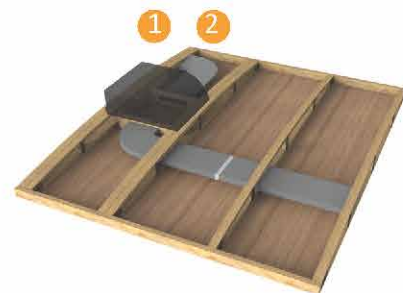
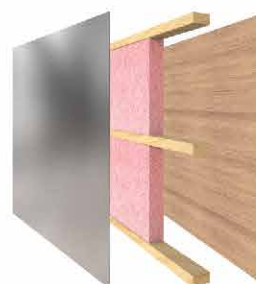

### Superior AC Cooling

- 1 Insulated Ducting
- 2 Even Cooling Throughout

## MORE STANDARD FEATURES MORE VALUE

Dutchmen RVs turn more heads on the lot and in the campground than any other. Why? While other manufacturers offer features as options, Dutchmen tends to make those same features standard. Call it "bang for the buck," "more for your money," or simply "more value." **We've built a reputation for bringing RV owners more standard features for less money** for more than 25 years . . . and it's a reputation we plan to keep.



### 100% PRE-DELIVERY INSPECTION

At Dutchmen, quality is standard. Every single Dutchmen RV that comes off the line receives its own pre-delivery inspection. Every unit undergoes a thorough 253-point check to ensure accurate measurements, fully-functional electronics and components.



### THE INDUSTRY'S BEST RV WARRANTY

With this industry-best warranty, we take the guessing game out of what is and isn't covered. So, that means you don't have to wrangle over the details, because we deliver value by clearly outlining the major components we back during the first three years.



### THE LEADER IN PARTS AND SERVICE

Replacement parts. Routine checkups. Expert advice. You name it and we've got it covered. When only the best RV services will suffice, our industry-leading parts and service department is ready to help you get back on the road - and stay there longer than ever before.



# ASPEN TRAIL



**Dutchmen**  
Legendary Innovation. Trailblazing Value.

Travel Trailers

PO BOX 2000 | 2164 CARAGANA COURT | GOSHEN, IN 46527 | SALES 574.537.0600

[www.dutchmen.com](http://www.dutchmen.com)

Visit us online to see all the Dutchmen brands, innovative models and spacious floor plans.



\*Length is defined as the distance from the centerline of hitch pin/coupler to rear bumper of trailer. \*\*Our weights represent how most units are built, inclusive of many commonly-ordered options. \*\*\*Fresh water capacity includes water heater capacity.

DISCLAIMER: Product information is as accurate as possible as of the date of brochure publication. All features, floor plans and specifications in this brochure are subject to change without notice. Please consult Dutchmen's website at [www.Dutchmen.com](http://www.Dutchmen.com) for current product information and specifications. Tow Vehicle Disclaimer: CAUTION: Owners of Dutchmen recreational vehicles are solely responsible for the selection and proper use of tow vehicles. All customers should consult with a motor vehicle manufacturer or their dealer concerning the purchase and use of suitable tow vehicles for Dutchmen products. Dutchmen disclaims any liability or damages suffered as a result of the selection, operation, use or misuse of a tow vehicle. DUTCHMEN'S LIMITED WARRANTY DOES NOT COVER DAMAGE TO THE RECREATIONAL VEHICLE OR THE TOW VEHICLE AS A RESULT OF THE SELECTION, OPERATION, USE OR MISUSE OF THE TOW VEHICLE. REFERENCE DUTCHMEN MANUFACTURING OWNERS MANUAL FOR LIMITED WARRANTY DETAILS. © 2020 Dutchmen 12-2019-ASPENTRAIL-LE-Printed in U.S.A



# ASPEN TRAIL LE

## Adventure Awaits

Whether your trail leads across this great country or simply a staycation, the Aspen Trail LE is your basecamp. Aspen Trail LE is a lightweight travel trailer offering floor plans designed to maximize space and comfort yet engineered to accommodate smaller tow vehicles.

- **Aspen Trail Power Package** - Aspen Trail Power Stabilizers, Power Awning and Power Tongue Jack make setting up and breaking down your campsite a breeze.
- **Larger Refrigerator** - large 7 cu. ft. gas/electric refrigerator to store all your essentials with less trips to the store.



### INTERIOR DECOR



Titanium

### Standard Features In Every Floor Plan



Power Stabilizer Jacks



Power Tongue Jack



Dual 20lb Propane Tanks



Residential Queen Bed



Prepped for WIFI 4G LTE

\* Not all features available on Single Axle Models

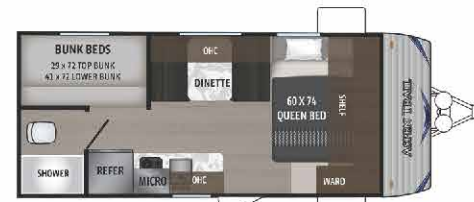

ASPEN TRAIL LE 1760BH

Length: 21' 5" Weight: 3,202 lbs. Sleeps: 4-6

Hitch: 407 lbs. Height: 9'9"



ASPEN TRAIL LE 1950BH

Length: 23' 5" Weight: 3,730 lbs. Sleeps: 6-8

Hitch: 502 lbs. Height: 9'11"



ASPEN TRAIL LE 1850RB

Length: 21' 5" Weight: 3,121 lbs. Sleeps: 2-4

Hitch: 440 lbs. Height: 9'9"



ASPEN TRAIL LE 1980BHS

Length: 23' 8" Weight: 4,226 lbs. Sleeps: 4-6

Hitch: 564 lbs. Height: 10'8"

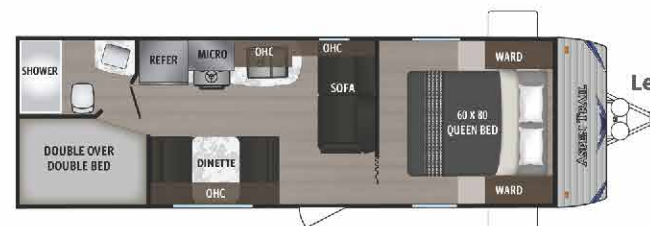

ASPEN TRAIL LE 25BH

Length: 28' 8" Weight: 4,588 lbs. Sleeps: 6-8

Hitch: 492 lbs. Height: 10'6"



### EXTERIOR

High Output Furnace  
6 Gal. Gas Water Heater  
13.5K Roof Mount A/C  
Backup Camera Prep  
Solar Prep  
Spare Tire  
35 Amp Converter  
30 Amp Power Cord  
Power Awning w/LED Light  
Power Stabilizer Jacks  
Power Tongue Jack

### INTERIOR

3 Burner Range (select models)  
Galley Sink w/High Rise Faucet  
LED Interior Lighting  
Upgraded Residential Flooring  
7 cu. ft. Gas/Electric Refrigerator  
AM/FM/MP3 Player  
Full Extension Drawer Guides  
Throughout

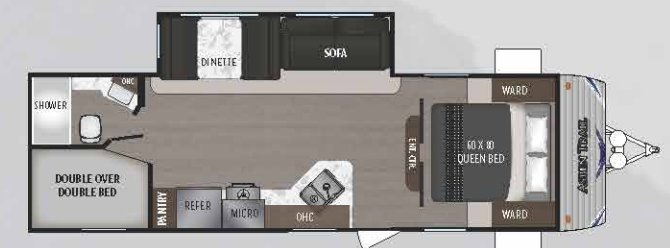

ASPEN TRAIL LE 26BH

Length: 30' 8" Weight: 5,719 lbs. Sleeps: 7-9

Hitch: 810 lbs. Height: 11'1"



ASPEN TRAIL LE 29BH

Length: 33' 3" Weight: 6,458 lbs. Sleeps: 7-9

Hitch: 818 lbs. Height: 11'3"

\*All information & specifications are for units manufactured after 09/15/2019



To learn more visit our website [dutchmen.com](http://dutchmen.com)





# ASPEN TRAIL LE

## FLOORPLANS

**NEW**



**ASPEN TRAIL LE 17BH**

Length: TBD Weight: TBD Sleeps: TBD



**ASPEN TRAIL LE 1760BH**

Length: 21' 5" Weight: 3,396lbs Sleeps: 4-6



**ASPEN TRAIL LE 1850RB**

Length: 21' 5" Weight: 3,309lbs Sleeps: 2-4



**ASPEN TRAIL LE 1950BH**

Length: 23' 5" Weight: 3,815lbs Sleeps: 6-8



**ASPEN TRAIL LE 25BH**

Length: 28' 8" Weight: 4,785lbs Sleeps: 6-8



**ASPEN TRAIL LE 26BH**

Length: 30' 10" Weight: 5,839lbs Sleeps: 7-9



**ASPEN TRAIL LE 29BH**

Length: 33' 3" Weight: 6,356lbs Sleeps: 7-10



**COMING SOON**

**ASPEN TRAIL LE 29DB**

Length: TBD Weight: TBD Sleeps: TBD

**Dutchmen®**  
*Legendary Innovation. Trailblazing Value.*  
[www.dutchmen.com](http://www.dutchmen.com)

Visit us online to see all of the Dutchmen brands, spacious floor plans, and detailed specifications.

**MORE STANDARD FEATURES. MORE VALUE.**

We've built a reputation for bringing RV owners more standard features for less money for more than 25 years... and it's a reputation we plan to keep.