

# HURRICANE®

HURRICANE CLASS A MOTORHOMES  
ARE READY FOR ANY ADVENTURE.



 **THOR**  
MOTOR COACH





# HURRICANE®

No matter how you choose to spend your time, there's a Hurricane® that fits your needs. The Hurricane offers outstanding functionality, beauty and affordability.



# EXTERIOR OPTIONS



EMMY GOLD 



HOLLYWOOD RED 



OSCAR NIGHT PARTIAL-PAINT 

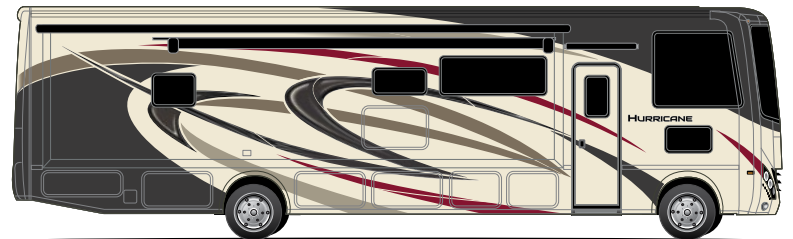

RED CARPET PARTIAL-PAINT 





#### TRITON® V10 ENGINE

The 6.8L V10 engine has a proven track record of durability and low-hassle maintenance. Extremely smooth running with a commanding 320-horsepower and 460 lb.-ft. of torque.

#### POWER 4-WHEEL DISC ANTI-LOCK BRAKES

Maintains brake balance in heavy use and varying road conditions. Reduces wheel lock up and helps maintain superior steering control.

#### TORQSHIFT™ 6-SPEED AUTOMATIC TRANSMISSION

Provides crisp, firm and quick shifting without sacrificing driver comfort.

#### LIMITED WARRANTY

The Ford® Motorhome Chassis has a Limited Warranty for 3 years or 36,000 miles and a Powertrain Limited Warranty for 5 years or 60,000 miles, whichever comes first.











HURRICANE PHOTO GALLERY

# FLOOR PLANS

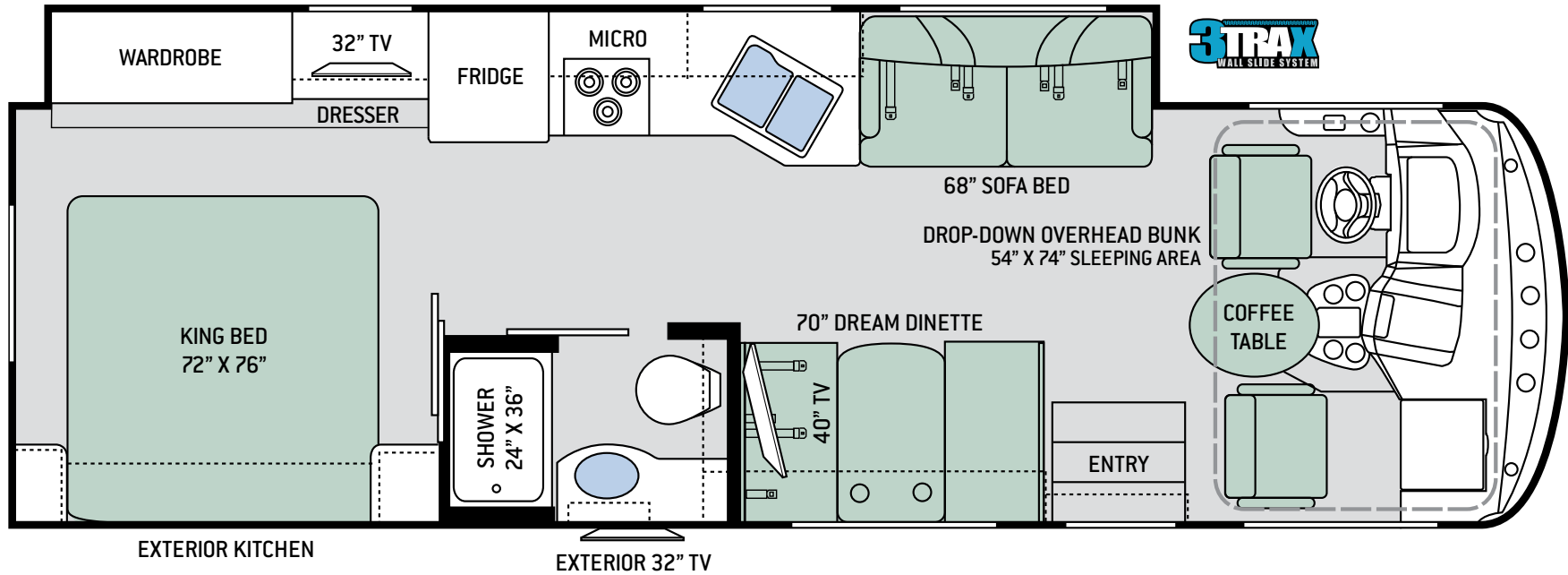

29M



# S P E C I F I C A T I O N S

	29M
CHASSIS	Ford
GROSS VEHICLE (GVWR)	18,000
GROSS COMBINED (GCWR)	23,000
WHEEL BASE	190"
EXTERIOR LENGTH (W/O LADDER)	30'-8"
EXTERIOR HEIGHT (W/AC)	12'-2"
EXTERIOR WIDTH (W/O MIRRORS)	99"
INTERIOR HEIGHT (LIVING AREA)	84"
AWNING SIZE	18'
FUEL (GAL)	80
LPG (LBS)	88
FRESH/WASTE/GRAY WATER (GAL)	50 / 40 / 40
WATER HEATER (GAL)	6
FURNACE (BTUS)	35,000
EXTERIOR STORAGE CAPACITY (CU. FT.)	64
HITCH WEIGHT RATING (LBS)	8,000

FLOOR PLANS

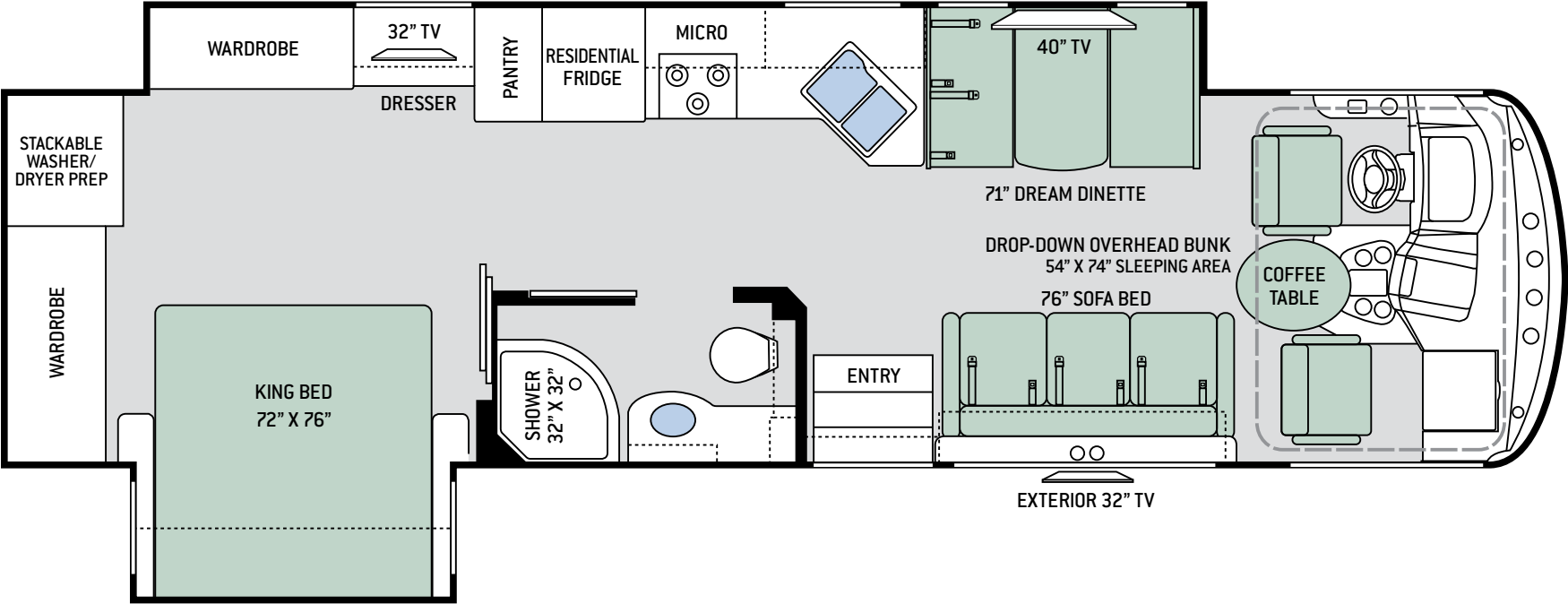

33X



# S P E C I F I C A T I O N S

	33X
CHASSIS	Ford
GROSS VEHICLE (GVWR)	20,500
GROSS COMBINED (GCWR)	26,000
WHEEL BASE	228"
EXTERIOR LENGTH (W/O LADDER)	34'-8"
EXTERIOR HEIGHT (W/AC)	12'-2"
EXTERIOR WIDTH (W/O MIRRORS)	99"
INTERIOR HEIGHT (LIVING AREA)	84"
AWNING SIZE	18'
FUEL (GAL)	80
LPG (LBS)	88
FRESH/WASTE/GRAY WATER (GAL)	50 / 40 / 47
WATER HEATER (GAL)	6
FURNACE (BTUS)	35,000
EXTERIOR STORAGE CAPACITY (CU. FT.)	103
HITCH WEIGHT RATING (LBS)	8,000

# FLOOR PLANS

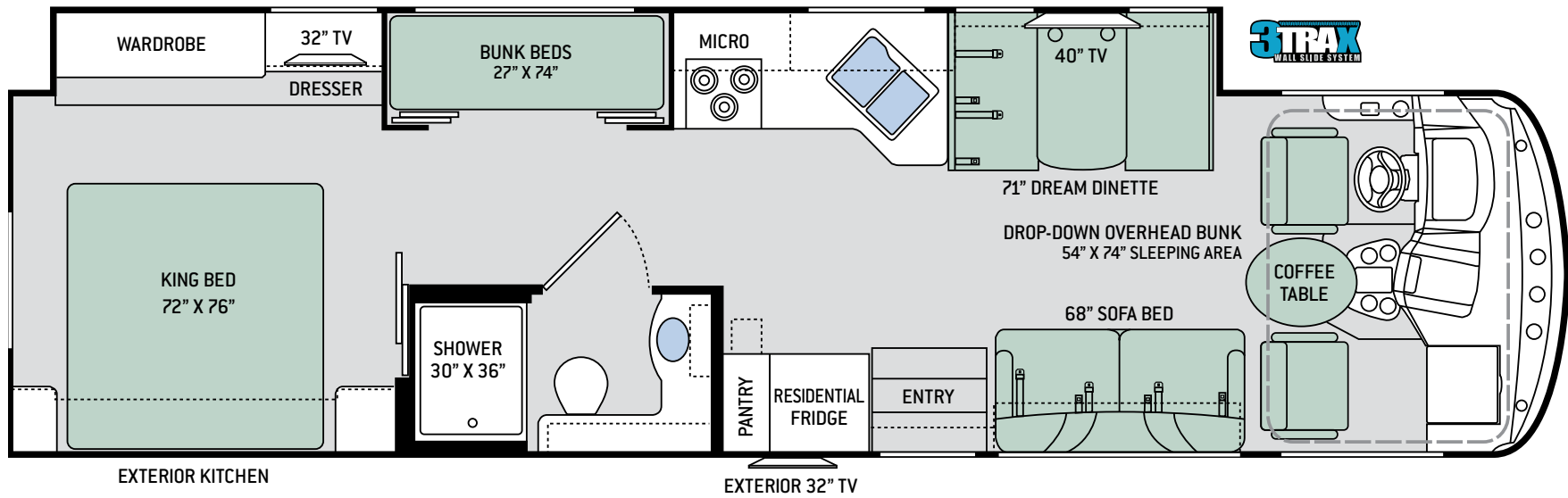

34J



# S P E C I F I C A T I O N S

	34J
CHASSIS	Ford
GROSS VEHICLE (GVWR)	22,000
GROSS COMBINED (GCWR)	26,000
WHEEL BASE	242"
EXTERIOR LENGTH (W/O LADDER)	35'-7"
EXTERIOR HEIGHT (W/AC)	12'-2"
EXTERIOR WIDTH (W/O MIRRORS)	99"
INTERIOR HEIGHT (LIVING AREA)	84"
AWNING SIZE	18'
FUEL (GAL)	80
LPG (LBS)	88
FRESH/WASTE/GRAY WATER (GAL)	50 / 40 / 40
WATER HEATER (GAL)	6
FURNACE (BTUS)	35,000
EXTERIOR STORAGE CAPACITY (CU. FT.)	116
HITCH WEIGHT RATING (LBS)	8,000

# FLOOR PLANS

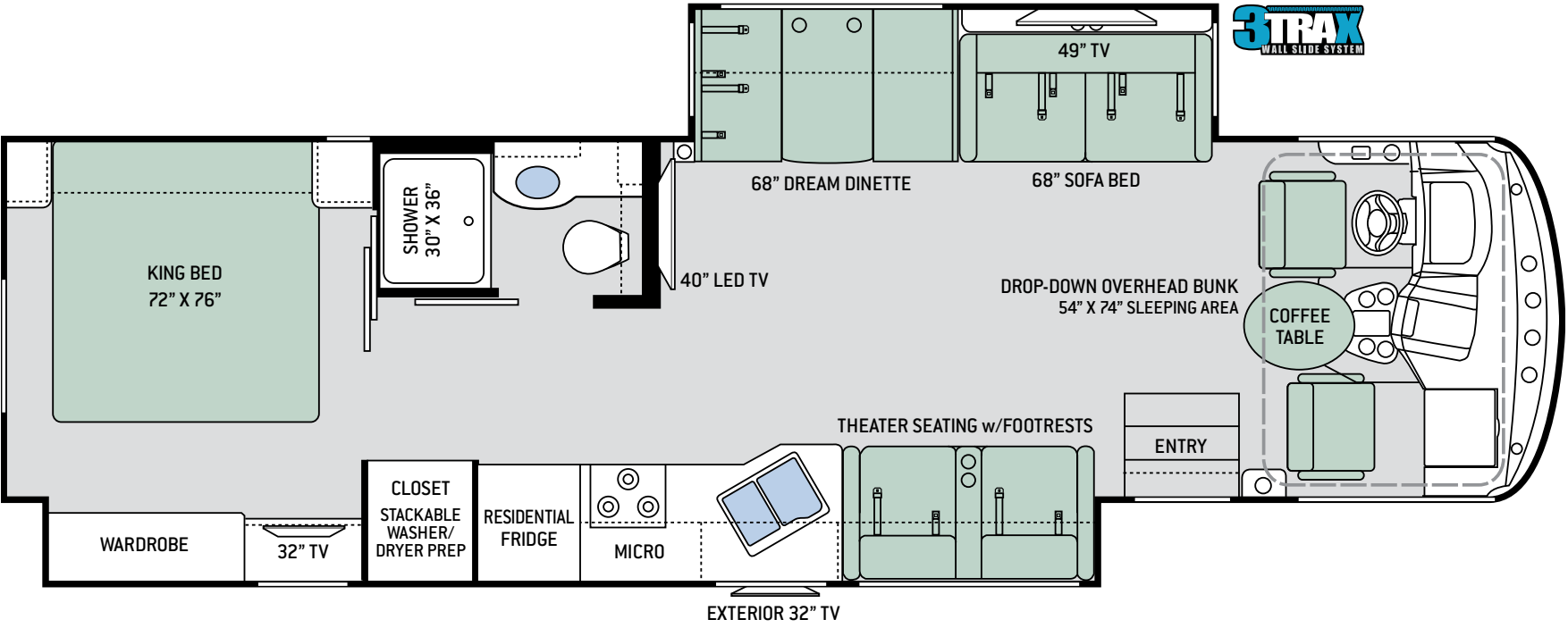

34R



# S P E C I F I C A T I O N S

	34R
CHASSIS	Ford
GROSS VEHICLE (GVWR)	22,000
GROSS COMBINED (GCWR)	26,000
WHEEL BASE	242"
EXTERIOR LENGTH (W/O LADDER)	36'
EXTERIOR HEIGHT (W/AC)	12'-2"
EXTERIOR WIDTH (W/O MIRRORS)	99"
INTERIOR HEIGHT (LIVING AREA)	84"
AWNING SIZE	18'
FUEL (GAL)	80
LPG (LBS)	88
FRESH/WASTE/GRAY WATER (GAL)	50 / 40 / 40
WATER HEATER (GAL)	6
FURNACE (BTUS)	35,000
EXTERIOR STORAGE CAPACITY (CU. FT.)	109
HITCH WEIGHT RATING (LBS)	8,000

# FLOOR PLANS

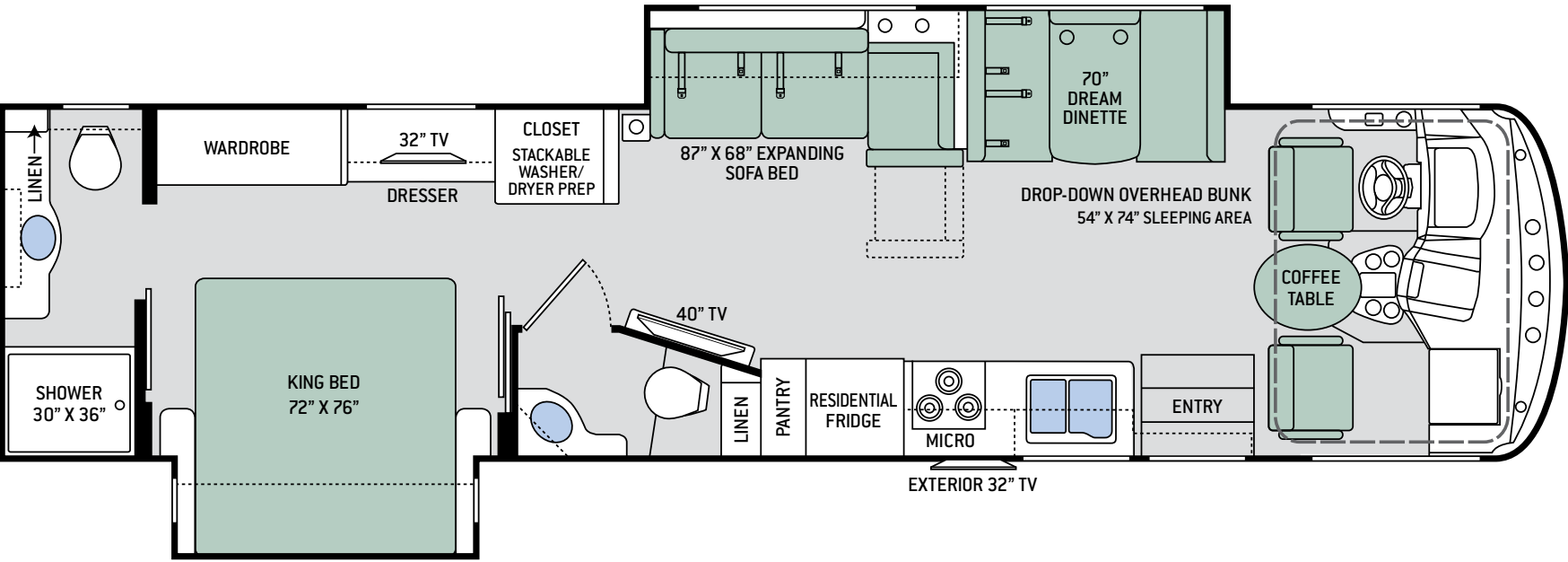

35M

# S P E C I F I C A T I O N S

	35M
CHASSIS	Ford
GROSS VEHICLE (GVWR)	22,000
GROSS COMBINED (GCWR)	26,000
WHEEL BASE	242"
EXTERIOR LENGTH (W/O LADDER)	36'-9"
EXTERIOR HEIGHT (W/AC)	12'-2"
EXTERIOR WIDTH (W/O MIRRORS)	99"
INTERIOR HEIGHT (LIVING AREA)	84"
AWNING SIZE	18'
FUEL (GAL)	80
LPG (LBS)	88
FRESH/WASTE/GRAY WATER (GAL)	50 / 40F-39R / 40F-39R
WATER HEATER (GAL)	6
FURNACE (BTUS)	35,000
EXTERIOR STORAGE CAPACITY (CU. FT.)	112
HITCH WEIGHT RATING (LBS)	8,000



# INTERIOR OPTIONS

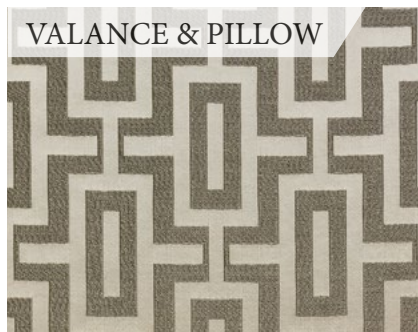

CHICAGO BLUES



SADDLEBACK

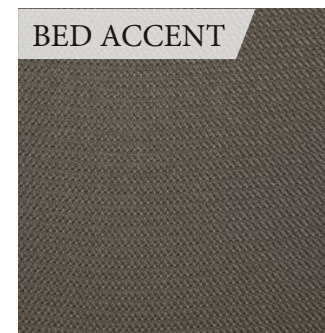
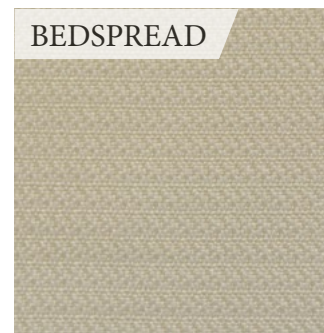

STERLING MIST II



MALIBU MAPLE

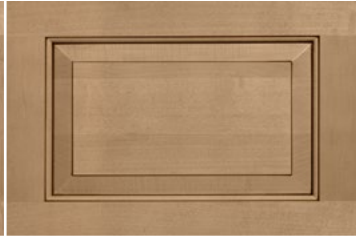

BRAZILIAN CHERRY



FLAT PANEL

RAISED PANEL

KITCHEN COUNTERTOP

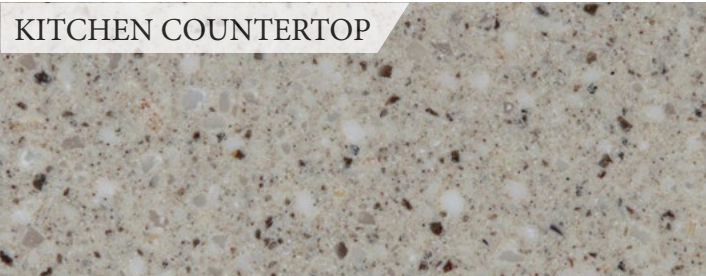

DINETTE COUNTERTOP



BED & BATH COUNTERTOP



FURNITURE



FURNITURE ACCENT



FLOORING











HURRICANE PHOTO GALLERY

# SPECIAL FEATURES



10" Touchscreen AM/FM  
Dash Radio with Bluetooth®



Multiplex Wiring Control  
System with 7" Touchscreen



Wifi Ranger® - Wifi Extender



Solar Charge Controller  
Solar Panel Ready



360° Siphon® Vent Cap for  
Tank Odor Prevention



Exterior TV on Manual Swivel  
with Sound Bar

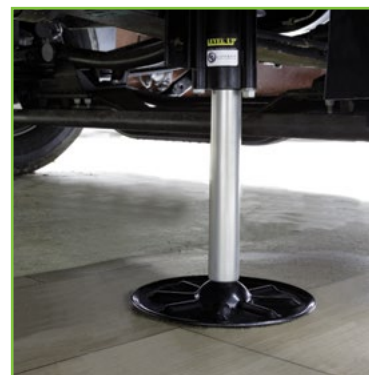

Automatic Leveling Jacks  
with Touchpad Controls

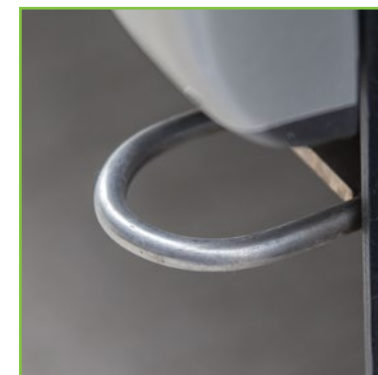

Pet-Link™ Multi-Purpose  
Tie-Down



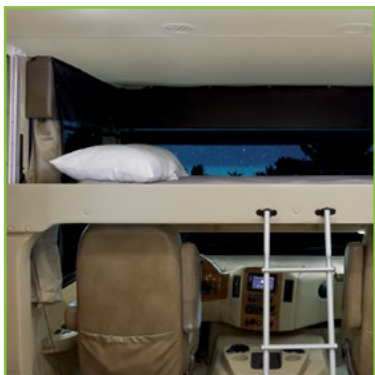

Power Drop-Down Hide-Away  
Overhead Bunk with Cotton Cloud™  
Mattress and Bunk Ladder



8,000-lb. Trailer Hitch with  
7-pin Round Connector





# FEATURED HIGHLIGHTS

---

## CONSTRUCTION & EXTERIOR

- » Ford® F-53 Chassis – 6.8L Triton® V10 Engine, 320HP, 460 lb.-ft. Torque – TorqShift® 6-Speed Automatic with Overdrive Transmission
- » One-Piece Fiberglass Front & Rear Caps
- » One-Piece Windshield
- » HD-MAX® Exterior with Graphics Package
- » Rotocast Storage Compartments
- » Side-Hinged Flush Mount Radius Compartment Doors
- » Premium One-Piece TPO Roof
- » Automatic Leveling Jacks with Touchpad Controls
- » Legless Lateral Power Patio Awning with Integrated LED Lighting
- » Power Entry Door Awning (34R)
- » 3TRAX® Wall Slide System (29M, 34J & 34R)
- » Slideout Room Topper Awning(s)
- » Pet-Link™ Multi-Purpose Tie-Down
- » Electric Entry Step
- » Roof Ladder
- » Frameless Windows
- » 8,000-lb. Trailer Hitch with 7-pin Round Connector

## CONSTRUCTION & EXTERIOR OPTIONS

- » Partial Paint on HD-MAX® Exterior with Graphics Package
- » Frameless Dual Pane Windows

## AUTOMOTIVE & COCKPIT

- » 10" Touchscreen Dash Radio with Bluetooth® and iGo Primo™ Navigation
- » Back-Up Monitor
- » Heated/Remote Exterior Mirrors with Integrated Side View Cameras
- » Reclining/Swivel Leatherette Captain's Chairs with Stow-Away Coffee Table
- » Power Driver's Seat
- » Emergency Engine Start Switch
- » Generator Start Switch
- » Tilt Steering Wheel
- » Cruise Control
- » Dash Fans
- » Map Lights
- » Fog Lights
- » Conversation Mirrors in Front Overhead Cabinets
- » Power Privacy Shade & Sunvisor at Windshield
- » Privacy Curtain on Side Windows
- » Dash Workstation with 110-volt & 12-volt Outlets
- » 19.5" Tires with Stainless Steel Wheel Liners
- » Valve Stem Extenders on Rear Wheels
- » Power Drop-Down Hide-Away Overhead Bunk with Cotton Cloud™ Mattress & Bunk Ladder

## INTERIOR

- » Rubber Tread Entry Steps with Lighted Step Well
- » Residential Vinyl Flooring
- » 84" Interior Ceiling Height
- » LED Lighting
- » Ceiling Ducted Air Conditioning System
- » Raised Panel Upper Cabinet Doors with Nickel Finish Hardware & Glass Inserts on Select Doors
- » Dream Dinette® Booth with Cup Holders
- » Dinette Storage Drawer (N/A 29M)
- » Leatherette Sofa Bed (N/A 35M)
- » Leatherette Expanding Sofa Bed (35M)
- » Leatherette Theater Seats with Integrated Footrests (34R)
- » Window Privacy Shades

## INTERIOR OPTION

- » Single Child Safety Tether in Dinette

## KITCHEN

- » Double Door Refrigerator (29M)
- » 11 cu. ft. Residential Refrigerator with Ice Maker (33X, 34J, 34R & 35M)
- » 3-Burner Gas Cooktop/Oven with Bi-Fold Glass Cover
- » 30" Over-the-Range Microwave Oven
- » Decorative Glass & Tile Backsplash
- » Solid Surface Countertops & Pressed Laminate Dinette Countertop



- » Large Double Stainless Steel Bowl Sink with Single Handle Faucet & Pull-Down Sprayer
- » Pantry (33X, 34J & 35M)
- » 12-volt Attic Fan with Cover

#### **BEDROOM & BATHROOM**

- » Denver Mattress® King Size Bed
- » Designer Headboard, Bedspread & Pillow Shams
- » Bunk Beds in Hallway Slideout (34J)
- » Foot Flush Porcelain Toilet
- » Shower with Glass Door
- » Dedicated CPAP Machine Outlet

#### **BEDROOM & BATHROOM OPTION**

- » 12-volt Attic Fan with Cover in Bedroom (29M – N/A when Dual 13,500 BTU Roof Air Conditioners is Optioned)

#### **ENTERTAINMENT**

- » 49" TV in Living Area (34R)
- » 40" TV in Living Area
- » 32" TV in Bedroom
- » Blu-Ray Player in Living Area
- » 15.5" & 24" TVs & DVD Player in Bunk Bed Area (34J)
- » Exterior 32" TV on Manual Swivel with Bluetooth® Soundbar

- » Power Charging Center for Electronics
- » Speakers in Sofa Overhead
- » HDMI Video Distribution
- » Cable TV Ready
- » Digital TV Antenna
- » Wifi Ranger® - WiFi Extender
- » Exterior Kitchen with Refrigerator & Sink (29M & 34J)

#### **ELECTRICAL & PLUMBING**

- » Onan® RV QG 4000 Gas Generator & 30-amp Detachable Shoreline Power Cord (29M)
- » 15,000 BTU Front Roof Air Conditioner (29M)
- » Onan® RV QG 5500 Gas Generator & 50-amp Detachable Shoreline Power Cord, with Dual 13,500 BTU Roof Air Conditioners (33X, 34J, 34R & 35M)
- » Solar Prep - Includes Solar Controller
- » Exterior LP Connection
- » Second Auxiliary House Battery
- » Battery Tray that Holds up to (4) Four Batteries (33X, 34J, 34R & 35M)
- » 1000-watt Inverter (29M)
- » 1800-watt Inverter (33X, 34J, 34R & 35M)
- » Automatic Generator Start
- » Battery Disconnect Switch
- » Multiplex Wiring Control System with 7" Touchscreen
- » 6-gallon DSI Gas/Electric Water Heater

- » Water Heater Bypass System
- » Enclosed & Heated Holding Tanks (34J, 34R & 35M)
- » Enclosed Holding Tanks with Heat Pads (29M & 33X)
- » 360° Siphon RV Holding Tank Vent Cap
- » Black Tank Flush System
- » 1" Fresh Water Tank Drain
- » Stackable Washer/Dryer Prep (33X, 34R & 35M)
- » Outside Shower
- » Systems Control Center

#### **ELECTRICAL & PLUMBING OPTION**

- » Onan® RV QG 5500 Gas Generator & 50-amp Detachable Shoreline Power Cord, with Dual 13,500 BTU Roof Air Conditioners (STD 33X, 34J, 34R & 35M) / (12-volt Attic Fan in Bedroom N/A on 29M when Optioned)

***For a complete listing of available features visit:  
[thormotorcoach.com/hurricane](http://thormotorcoach.com/hurricane).***





**Made to fit.**

**IMPORTANT—PLEASE READ:** This brochure reflects product design, fabrication, material, components and specifications at the date of printing, which date is disclosed below. Please visit us online at [ThorMotorCoach.com](http://ThorMotorCoach.com) or consult with your selling dealership for the latest in standards, options, specification and technical information. Photographs in the brochure may depict optional equipment or may only be available in certain floor plans. Components, appliances and the chassis may have been manufactured in a calendar year before the vehicle's designated model year. All capacities are approximate. The actual length of the vehicle may differ from that indicated in the brochure due to variances in the manufacturing processes and/or installed components. All dry weights are based on standard model features and do not include optional features or equipment. Component part and appliance manufacturers issue limited warranties covering portions of the vehicle not covered under the limited warranty we issue. Copyright Thor Motor Coach, Inc. © OH 10/01/18



[thormotorcoach.com/hurricane](http://thormotorcoach.com/hurricane)  
P.O. Box 1486, Elkhart, IN 46515 Sales Department: 800.860.5658 Customer Service: 877.855.2867