

Jayco | 2024 Eagle HT Fifth Wheel

EAGLE HT FW

ADVENTURES AROUND EVERY BEND



INTERIOR DESIGN



CLASSIC FARMHOUSE



Main Wood



Accent Wood



Floor

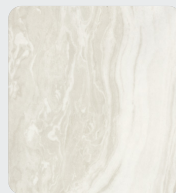

Countertop



Main Fabric



Accent Fabric

- STORAGE
- MICRO** MICROWAVE
- OHC** OVERHEAD CABINETS
- FRIDGE** REFRIGERATOR
- WARD** WARDROBE

OPTIONS

- A**

Dinette
- B**

Griddle/Sink
- C**

Tri-fold Sofa

25RUC OPTION: B

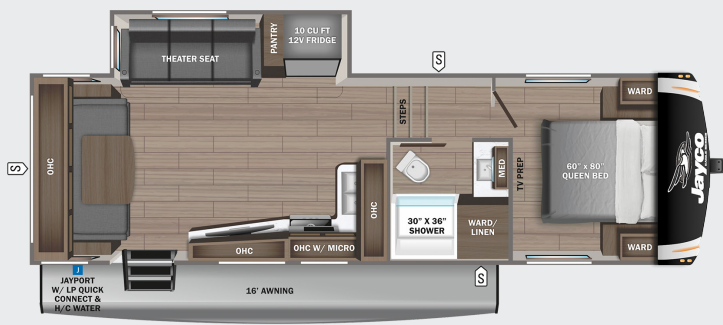

26REC OPTIONS: A, B, C

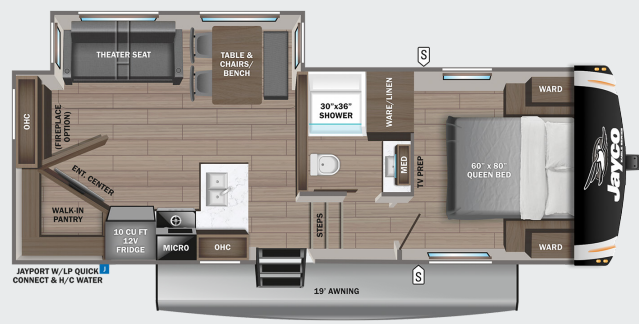

29ddb OPTION: C

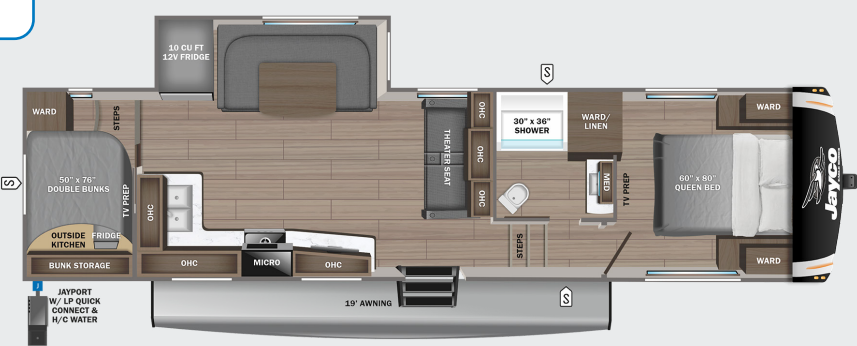

29RLC OPTIONS: A, B, C

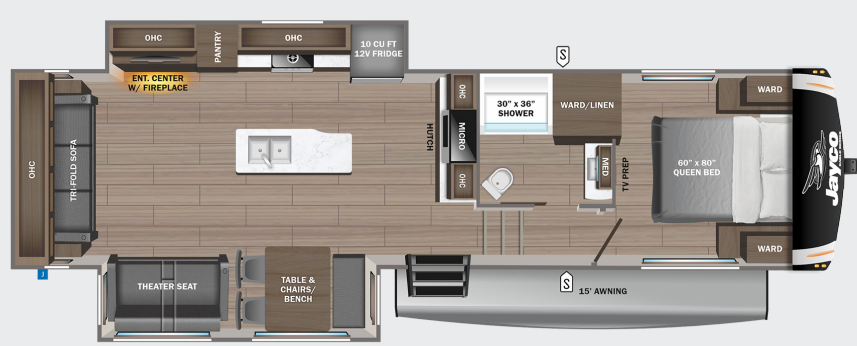

STANDARDS & OPTIONS

EXTERIOR

- 1.5 in fresh water drain valve
- 5 in. Magnum Truss™ Roof System with Alpha roof membrane system with limited lifetime warranty
- 50-amp detachable power cord
- Auto-grade vinyl graphics
- Automotive style painted front cap with max turn radius
- Black tank flush
- Climate Shield™ zero-degree tested weather protection:
 - Fully enclosed and heated underbelly (ducted)
 - 35,000 BTU furnace
 - Double layer fiberglass batt insulation in ceiling and floor
 - Double sided radiant barrier insulation (roof, floor and behind cap)
 - PEX plumbing
- Commercial grade rubber flooring in pass through area
- Digital TV antenna with WiFi prep
- Dual 30 lb. LP bottles
- Dual channel exterior speaker
- Factory installed roof ladder
- Galvaniel steel coated outside kitchens
- HELIX Cooling System™ (industry exclusive):
 - Jayco exclusive insulated dual duct design
 - Directional and closeable A/C vents
 - Larger return air vents with user accessible filters
- Independent satellite and cable hookups
- LED exterior lighting package
- LP quick connect for gas griddle (next to JayPort)
- Metal slam latch baggage doors
- Nautilus 2.5 water connections
- Nitrogen filled undermount spare tire (15 in.)
- Quick connect water connections (door side hot/cold and off door side cold only)
- Slide topper/awning prep
- Stronghold VBL™ walls (laminated sidewalls, rear walls and slide out walls)

INTERIOR

- 2 piece high gloss bathroom surround
- 5/8 in. tongue-and-groove plywood flooring
- 75 lb. full extension drawer guides
- Bathroom skylight
- Bedroom TV prep

- C.P.A.P. prepped bedroom
- Extra 120V power outlets in kitchen and slide rooms (where applicable)
- Gas strutted under bed storage
- Handcrafted and glazed door/drawer fronts (new sizes)
- Inverter pre-wire (multiple locations) ((7) 110 outlets) (4 USB's 12V)
- Matte black kitchen faucet with pull-out sprayer
- Porcelain foot flush toilet
- Residential vinyl flooring throughout
- Solid hardwood slide fascia
- Stainless steel kitchen sink
- Theater seating (select models)
- Tri-fold hide-a-bed sofa with residential memory foam sleep surface (select models)
- USB charging ports (multiple locations throughout)

CUSTOMER VALUE PACKAGE (MANDATORY)

- 15K BTU "Whisper Quiet" A/C and bedroom A/C prep
- 4K Ultra LED HD Smart TV in living room (39 in.)
- 50-amp service with dual A/C ducts
- 60K on-demand water heater with mixing tank
- Custom machined aluminum rims
- Electric patio awning with integrated LED lights
- GE black and stainless 17 in. range with edge to edge grates
- GE microwave
- Hidden hinges on cabinet doors
- Keyed-Alike™ lock system
- Rain proof bathroom power vent
- Rear 2 in. towing receiver (4-pin connector on fifth wheels only)
- Security monitor prep (rear)
- Upgraded friction hinge entrance door

LUXURY PACKAGE (MANDATORY)

- Blackout roller shades with reflective side throughout
- Electric auto-leveling
- GE 10 cu.ft. 12V refrigerator
- JayPort 2 in. mount (for outside accessories)
- Residential style glass shower door
- XL grab handle

4-STAR HANDLING PACKAGE (MANDATORY)

- Dexter® Axles with NEV-R-Adjust® brakes and E-Z Lube® hubs
- Goodyear® Endurance® tires (load range E)
- MORryde® CRE-3000™ rubberized suspension
- Wet bolt fasteners with bronze bushings

OPTIONS

- 15K bedroom A/C
- 22 in. outside griddle with deep sink attachment for JayPort system
- Booth dinette (select models)
- Free standing table with leaf and bench seat
- LED fireplace with 5,000 BTU electric space heater (select models)
- Overlander 1 Solar Package: (1) 200W panels, MPPT 30-amp solar controller
- Residential 60 in. x 80 in. queen size mattress
- Theater seating in place of tri-fold sofa (select models)

*Indicates split tanks

FLOORPLAN	TOTAL EXTERIOR LENGTH	EXTERIOR WIDTH	EXTERIOR HEIGHT (WITH A/C)	INTERIOR HEIGHT (MAIN)	INTERIOR HEIGHT (UPPER DECK)	UNLOADED VEHICLE WEIGHT	DRY HITCH WEIGHT	GVWR	CARGO CARRYING CAPACITY	FRESH WATER CAPACITY	GRAY WASTE WATER CAPACITY	BLACK WASTE WATER CAPACITY	SLEEPING CAPACITY
25RUC	29' 5"	8' 1"	12' 5"	8' 5"	6' 3"	8,010	1,610	9,500	1,490	52	82*	45	3-5
26REC	29' 5"	8' 1"	13' 0"	8' 5"	6' 3"	8,055	1,615	9,750	1,695	52	82*	45	1-2
29DDB	34' 7"	8' 1"	12' 11"	8' 5"	6' 3"	9,040	1,715	10,175	1,710	52	82*	45	5-7
29RLC	34' 1"	8' 1"	12' 6"	8' 5"	6' 3"	9,205	1,690	10,750	1,545	52	82*	45	3-4

Meet your Jayco Dealer



Scan QR code for specification definitions

Some specs at the time of print may include estimates. For the most updated information, please visit Jayco.com

Jayco, Inc. | P.O. Box 460 | Middlebury, IN 46540

See dealer for further information and prices. All information in this brochure and on www.jayco.com is the latest available at the time of publication approval. Jayco reserves the right to make changes and to discontinue models without notice or obligation. Photography may show optional equipment or props used for decoration purposes only. RVs built for sale in Canada may differ to conform to Canadian codes. JAYCO and the JAYCO BIRD IN FLIGHT are registered trademarks of Jayco, Inc. Printed in USA 3/24 ©2024 Jayco, Inc.



Jayco - Part of Jayco Family of Companies