

WILDWOOD



Capture the memories.





1/2 Barrel Hidden Storage.  
Wildwood products are  
designed with a focus  
on storage.



## More for your Money.

The 28DBUD and all Wildwood models offer more value for your money. Over the last 6 years, this has helped make Wildwood the value buyers choice. The beautiful interiors are one reason. Wildwoods look like an RV costing \$5,000 - \$10,000 more. The kitchen countertop, slide-out treatments, cabinet storage, window appointments, wood grain linoleum, bedspreads, shower curtains, and the finishes on appliances, cabinets and hardware, are major elements to our success. See for yourself. Compare and make the wise and obvious choice to own a Wildwood RV by Forest River, Inc.

- 1 Shown are LG Solid surface countertops, over slide LED accent lighting, and wide open floorplan that the 28DBUD affords.
- 2 Wildwood master bedroom includes full walkaround bed, dual hanging wardrobes, and private entertainment center
- 3 Spacious bathrooms with optional overhead skylight accommodate couples and families alike with ease.



Shown with optional tub surround

**28DBUD**

DÉCOR COLOR:

*Tiffany Leather*

**6,140 LBS**

Shown with  
Standard Beauflor®  
Plank Wood Linoleum



**27RKSS**

DÉCOR COLOR:

*Onyx*

**6,355 LBS**

Shown with  
Standard Beauflor®  
Plank Wood Linoleum



## Committed to quality.

Wildwood doesn't skimp on windows, drawers, solid interior doors, cabinets or other features. We are committed to manufacturing quality built products.

- 1 Full extension ball bearing drawer guides with cabinet-grade plywood drawer slides
- 2 One or two recliners are standard equipment on all one bedroom (non-bunk) units.
- 3 This attractive shower is included on all one bedroom (non-bunk) units.
- 4 "Double Deep" kitchen overhead cabinets provide a kitchen with the best storage space in the business.
- 5 We have added a new high quality vinyl coated back splash in the kitchen that is wonderfully wrinkle-free and heat-resistant.
- 6 LED lighting is a popular standard feature that eliminates heat and reduces energy consumption.





**31KQBSTS**

DÉCOR COLOR:

*Tiffany Leather*

**7,902 LBS**

Shown with  
Standard Beauflor®  
Plank Wood Linoleum

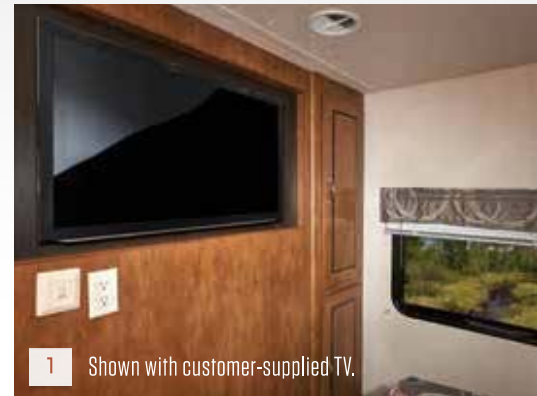

1 Shown with customer-supplied TV.



2



3 Shown with customer-supplied TV.

## We have room for everyone.

Wildwood has plenty of room for friends and family. With unique floorplans, and maximized space utilization, you'll always feel right at home.

- 1 Private master bedroom entertainment center allows for separate TV up to 48".
- 2 Large durable storage standards under dinettes and sofa keep life organized and living space clutter free.
- 3 Functional kitchens show with solid surface counters, designer spring faucet, and undermount sinks make meal prep a breeze. (Limited Program Features \*)
- 4 Plush Teddy Bear brand bunk mattresses, deep slides, and an independent entertainment center make this separate bunk room perfect for kids or adults.



4 Shown with customer-supplied TV.

WILDWOOD

# Construction



- 1 Radius entry Steps
- 2 2" x 3" floor joists 12" on center
- 3 5/8" 5-ply tongue in groove plywood floor decking
- 4 2" wall studs 16" or less on center
- 5 30" fiberglass radius entry door
- 6 .024 aluminum siding
- 7 5" bowed truss roof rafters
- 8 One piece seamless roof (12 yr. warranty)
- 9 R-7 fiberglass insulation throughout
- 10 Extra large full pass-thru storage w/ 20" x 30" Door (per floorplan)
- 11 Smooth rolled skirting
- 12 In floor ducted heat
- 13 Diamond plate rockguard
- 14 3/8" roof decking (full walk-on roof)
- 15 LP bottle cover w/ easy access
- 16 13.5K ducted roof, high output AC w/ quick cool
- 17 Hitch light & 0.40 aluminum front cap
- 18 Stain resistant carpet
- 19 One piece plank wood look linoleum flooring
- 20 Safety glass windows
- 21 Polystyrene foam insulated A/C duct work
- 22 "Darco" anti-puncture underbelly wrap

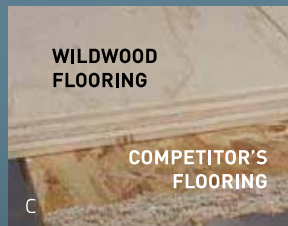

## FORM FOLLOWS FUNCTION.

At Wildwood your satisfaction is serious business and it shows. Our commitment to your satisfaction includes:

- A. Extra large pass-thru storage
- B. Heated and enclosed fresh water tank
- C. Wildwood 5/8" Tongue and groove plywood (top) vs. OSB (below)
- D. 6 gallon Gas/Electric DSI water heater with Quick Recovery
- E. New Centralized Command Center



# standards & options

## CONSTRUCTION & EXTERIOR

- **5/8" tongue & groove plywood floor**
- Full walk on one-piece seamless **Super-Flex®** roof w/ 12 year warranty
- Extra large full pass through storage (per floorplan)
- Cold crack and mildew resistant vinyl patio awning
- Safety glass windows
- **Metal framed 30" smooth radius corner fiberglass main entry door**
- Powder coated I-beam frame
- Cambered chassis
- **Enclosed fresh water tank in a heated compartment**
- 16-gal. per hour **Gas/Electric** quick recovery DSI water heater
- Water heater by-pass
- Nitrogen filled tires
- 2" wall construction, 16" (or less) on center
- R-7 fiberglass insulation throughout
- 13 ply cross micro-laminated beam header above slide out
- **Triple seal slide out system**
- Electric slide out systems (flush floor)
- Swing arm entry assist handle
- Two marine grade exterior speakers
- Electric front jacks (fifth wheels)
- **Fiberglass front cap (fifth wheels)**
- **Aerodynamic front radius**
- Smooth aluminum front cap

## KITCHEN

- Dometic® double door refrigerator (2 yr. warranty)
- High Rise Faucet (Limited Program Option)
- Residential style sink
- Stainless steel finish microwave w/ carousel
- 3-Burner, high output range with oven (2 yr. warranty) Stainless steel finish on door
- Undermount kitchen sink
- Stainless steel finish range hood w/ 12-volt exhaust fan and light
- One piece Beauflor® vinyl flooring
- 27" tall overhead cabinet (kit)

- Wood drawers w/ furniture-grade plywood slides
- Full extension ball bearing drawer guides
- Knife rack (behind cook top)
- **Shelving** in overhead cabinets in kitchen
- Central switch location for command center
- Brushed stainless finish hardware
- Abundant cabinet storage
- **Large pots and pans drawer under dinette**

## LIVING ROOM

- **Recliner or recliners included in one bedroom models**
- 80" interior height in travel trailers (101" interior height in fifth wheel models)
- Ducted 13,500 BTU roof air conditioner w/ quick cool
- **Huge storage drawer under jiffy sofa**
- Booth dinette w/ large storage drawer (most models) (U-shaped dinette, some models)
- Large dinette picture window
- Antenna with booster
- Bluetooth FM stereo w/ CD/DVD and four cube speakers
- Patio door w/ vertical blinds (36BHBS, 37BHSS2Q, 38RLTS)
- Decorative wall light
- 25K BTU suburban forced air DSI furnace w/ digital thermostat (2 yr. warranty)
- In-floor ducted heat
- Cable TV hookup living room and bedroom
- **Wall switch controls for ceiling lights at key locations**

## BEDROOM

- **Strut lifted storage area under bed (master bedroom)**
- Bedside mirrored wardrobes w/ shelf above bed
- Bedside 110-volt power outlets (2)
- **Increased space at the foot of the bed (most models)**

- Solid bedroom privacy doors (most models)
- Shoe nook at the foot of the bed (most models)
- Bedside hamper access (most models)

## BATHROOM

- 12-volt power bath roof exhaust vent
- Wooden medicine cabinet w/ mirrored door
- Foot flush toilet
- Tooth brush holder and towel ring
- Vinyl tub surround (radius angle showers have an enclosure) (select floorplans)
- One-piece slip-resistant Beauflor® vinyl flooring

## SECURITY AND SAFETY

- LED docking lights (fifth wheels)
- LP leak detector
- Smoke detector
- Carbon monoxide detector
- Fire extinguisher
- Hitch light (travel trailers)
- Welded heavy duty safety chains (travel trailers)
- Electric brakes (all wheels)
- GFI receptacles
- ANSI 119.2 certified
- Meets all national highway administration specifications
- RVIA approved product
- Beauflor® vinyl floor with "SafetyGrip"

## WILDWOOD OPTIONS

- Stabilizer jacks [travel trailer (4) or fifth wheel (2)]
- Skylight over tub
- 30-lb LP bottles w/ cover and auto change over (travel trailers)
- 12v power four corner stabilizer jacks (Limited Program Option)
- Power awning with colored LED awning light and remote (Limited Program Options)
- 15,000 BTU ducted air w/ quick cool

- Remote control for slide outs and power awning (Limited Program Options)
- LG solid surface (Particle-board free) kitchen counter tops (Limited Program Options)
- Undermount sink
- Electric front jacks (Limited Program Options)
- LED Interior lights (Limited Program Options)
- Radial tires (Mandatory option)
- 10.7 cu. ft. Whirlpool® Refrigerator with Power Inverter

Contact your Wildwood dealer for a complete list of options.



Power awning with colored LED awning light with remote (Limited Program Option)



High Rise Spring Faucet



LED Lights

16 x 24 Residential Style Cabinets with Glass Inserts and Base Shelves (Where applicable)

80" CEILING HEIGHT

Dhalia Cherry Mouldings and Accents Throughout

Decorative Curtain Rods and Curtains

Night Shades

Designer Spring Faucet (Limited Program Option)

LG® Solid Surface Countertops

Stainless Steel Appliance Package

Standard Plush Recliners

Beauflor® Linoleum Scratch, Tear, and Cold, Crack Resistant Flooring

Full Extension, Extra-Deep Pot and Pan Drawer

# Interior Features

SOME FEATURES SHOWN HAVE LIMITED AVAILABILITY.



1



2



3



4



5



8



6



7

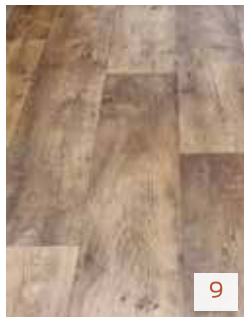

9



10



14



11



12

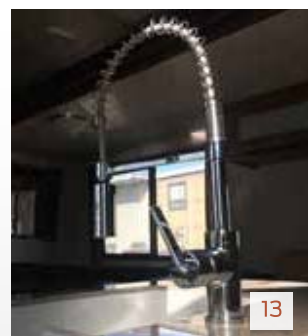

13

## WILDWOOD *Popular Options*

MORE REASONS WHY  
PEOPLE CHOOSE SALEM

1. Over Slide LED Accent Lighting (Limited Time Options\*)
2. Full Extension Ball Bearing Drawer Guides
3. Shoe Nook (Most Models)
4. Colored LED Awning Lights (Limited Time Options\*)
5. Blue LED undercarriage lighting (Limited Time Options\*)
6. Extra Large Pass-Through Storage
7. Bluetooth Stereo with DVD, FM, & CD (Limited Time Options\*)
8. New Deluxe Entertainment Center With Residential Entry Into Master Bedroom. Where applicable (Shown with customer supplied TV)
9. Beauflor® One Piece Plank Wood Linoleum Flooring
10. Copper Vein Weatherproof Countertop on Outside Kitchen (Outside Kitchen Models Only)
11. Solid Surface Countertops (Limited Time Options\*)
12. Hinged 1/2 Barrel Storage (Most Models)
13. Designer spring faucet (Limited Time Options)
14. Optional 10.7 cu. ft. Whirlpool® Refrigerator with Power Inverter

\* See your dealer for more details about our Limited Time Options

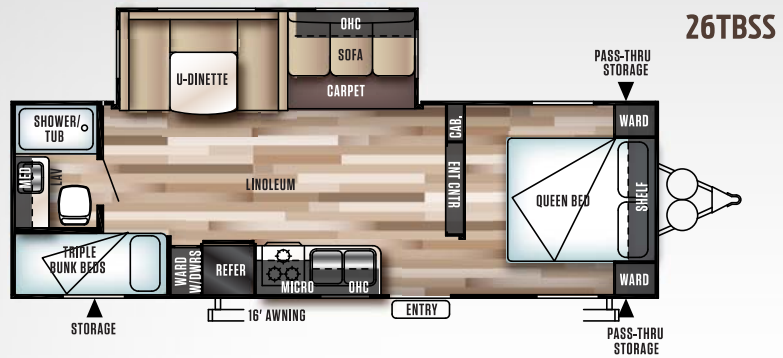

5,730  
DRY WEIGHT

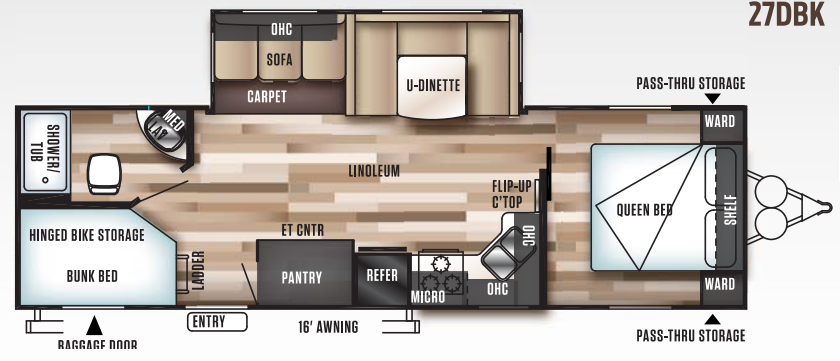

6,380  
DRY WEIGHT

New!

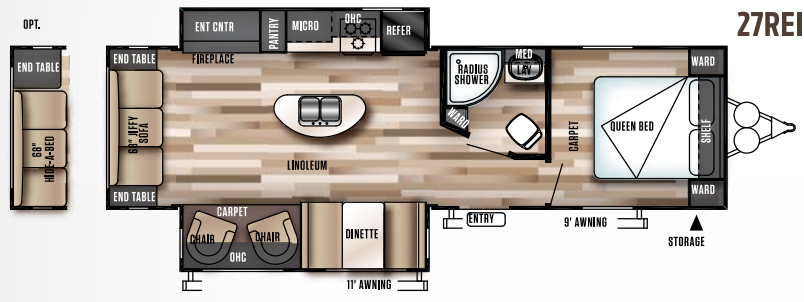

7,558  
DRY WEIGHT

New!

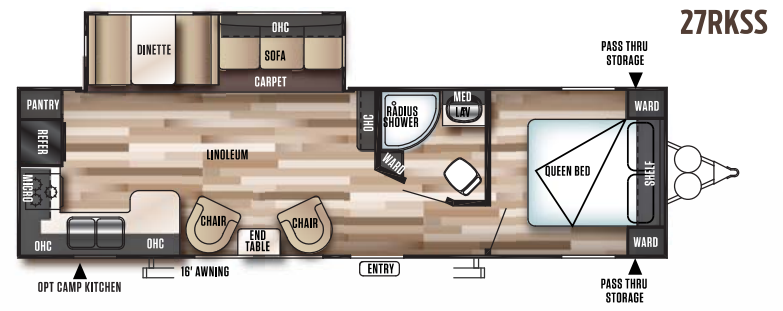

6,355  
DRY WEIGHT

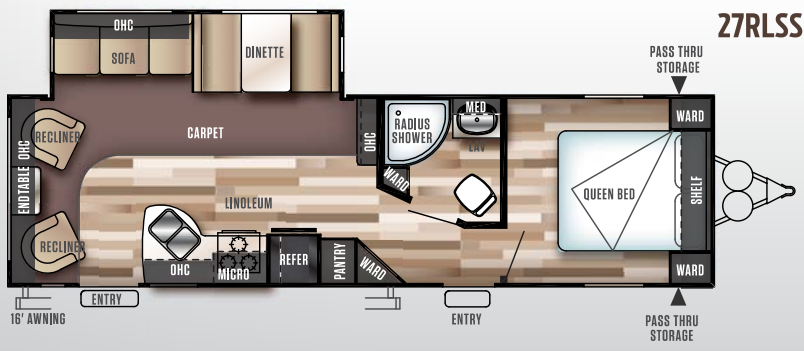

6,782  
DRY WEIGHT

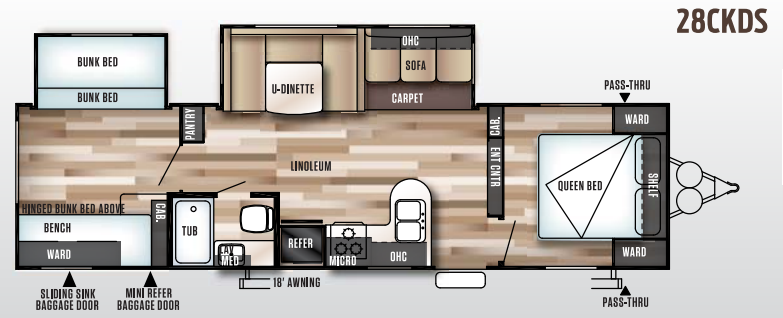

7,622  
DRY WEIGHT

New!

WILDWOOD  
Travel Trailers

	26TBSS	27DBK	27REI	27RKSS	27RLSS	28CKDS
HITCH WEIGHT (LBS.)	815	701	831	720	650	838
DRY SHIP WEIGHT (LBS.)	5730	6380	7558	6355	6372	7622
CARGO CARRYING CAPACITY (LBS.)	2047	1283	3374	1327	1240	1978
EXTERIOR LENGTH	28' 8"	32' 0"	33' 1"	33' 3"	32' 2"	34' 6"
EXTERIOR HEIGHT	11' 2"	11' 4"	11' 5"	11' 2"	11' 2"	11' 5"
FRESH WATER CAPACITY (GAL.)	40	40	40	40	40	40
BLACK WATER CAPACITY (GAL.)	30	41	27	27	27	30
GREY WATER CAPACITY (GAL.)	27	60	42	60	60	30
AWNING SIZE (FT.)	16'	18'	11' / 9'	16'	16'	18'

28DBUD

6,140  
DRY WEIGHT

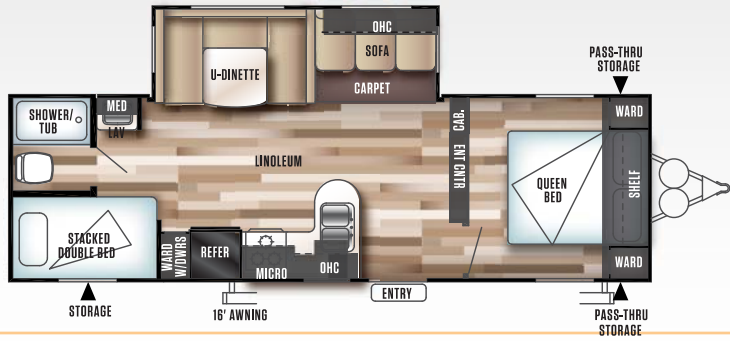

28RLDS

6,782  
DRY WEIGHT

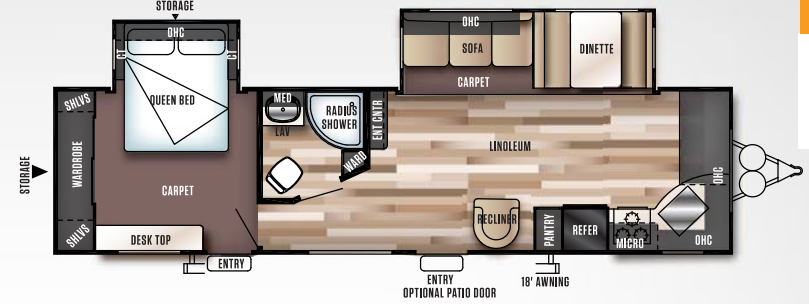

29FKBS

7,513  
DRY WEIGHT

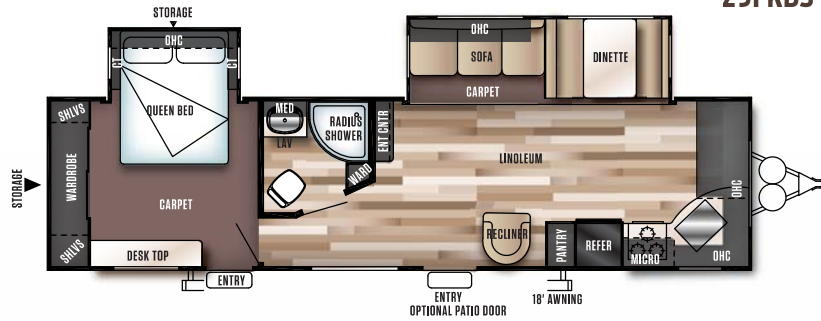

30KQBSS

6,884  
DRY WEIGHT

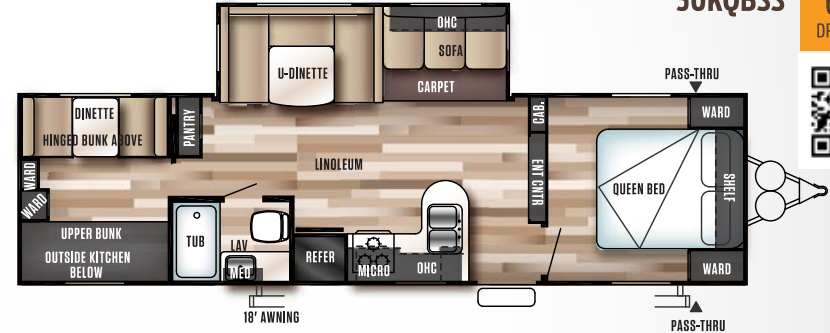

30QBSS

6,575  
DRY WEIGHT

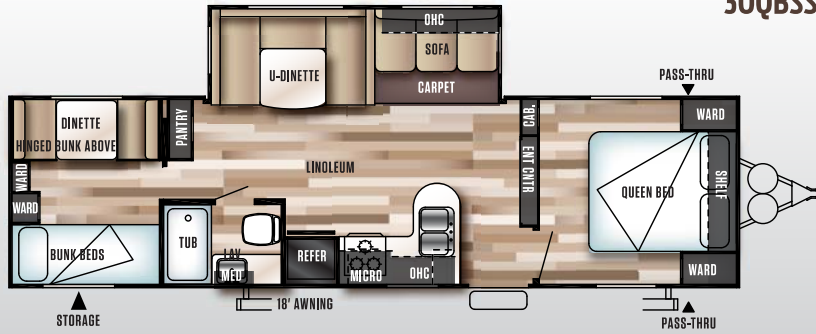

	28DBUD	28RLDS	29FKBS	30KQBSS	30QBSS
HITCH WEIGHT (LBS.)	772	882	826	899	980
DRY SHIP WEIGHT (LBS.)	6140	6782	7513	6884	6575
CARGO CARRYING CAPACITY (LBS.)	1549	1062	3414	2777	3167
EXTERIOR LENGTH	29' 6"	32' 3"	35' 3"	33' 0"	33' 2"
EXTERIOR HEIGHT	11' 2"	11' 2"	11' 2"	11' 2"	11' 2"
FRESH WATER CAPACITY (GAL.)	40	40	40	40	40
BLACK WATER CAPACITY (GAL.)	30	27	30	27	27
GREY WATER CAPACITY (GAL.)	27	60	57	57	30
AWNING SIZE (FT.)	16'	16'	18'	18'	18'

## WILDWOOD Floorplan Key

Pillows and blankets shown on beds and bunks are for demonstration purposes only and do not come with your new coach.

- OHC OVERHEAD CABINET
- WARD WARDROBE
- MICRO MICROWAVE
- LAV BATHROOM SINK

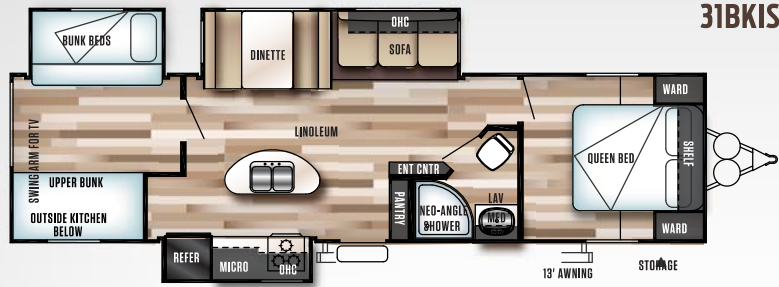

31BKIS

8,350  
DRY WEIGHT

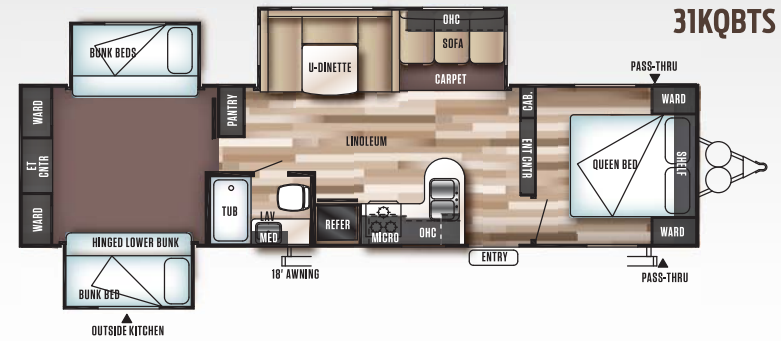

31KQBT5

7,902  
DRY WEIGHT

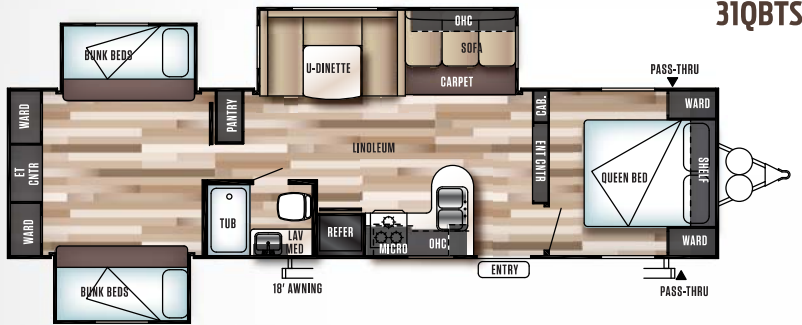

31QBTS

8,140  
DRY WEIGHT

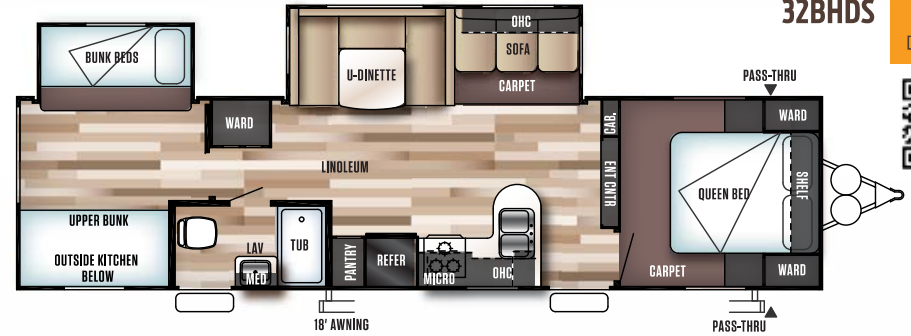

32BHDS

7,955  
DRY WEIGHT

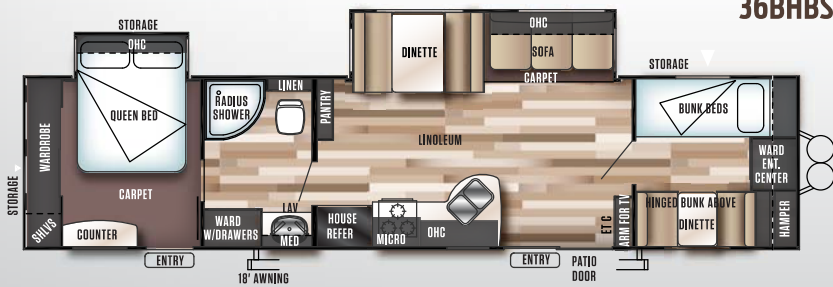

36BHBS

7,891  
DRY WEIGHT

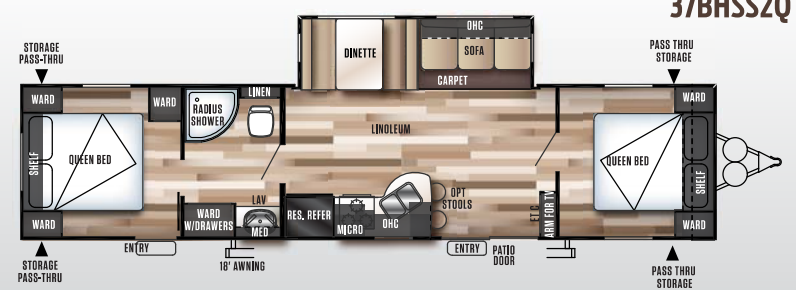

37BHSS2Q

7,600  
DRY WEIGHT



WILDWOOD  
*Travel Trailers*

	31BKIS	31KQBT5	31QBTS	32BHDS	36BHBS	37BHSS2Q
HITCH WEIGHT (LBS.)	970	793	885	859	720	970
DRY SHIP WEIGHT (LBS.)	8350	8140	7902	7955	7891	7600
CARGO CARRYING CAPACITY (LBS.)	2742	3013	2867	3026	2951	3492
EXTERIOR LENGTH	35' 8"	36' 1"	35' 6"	35' 8"	36' 7"	39' 0"
EXTERIOR HEIGHT	11' 3"	11' 3"	11' 2"	11' 2"	11' 2"	11' 2"
FRESH WATER CAPACITY (GAL.)	40	40	40	40	40	40
BLACK WATER CAPACITY (GAL.)	30	27	27	30	27	27
GREY WATER CAPACITY (GAL.)	60	54	27	57	30	30
AWNING SIZE (FT.)	13'	18'	16'	16'	18'	18'

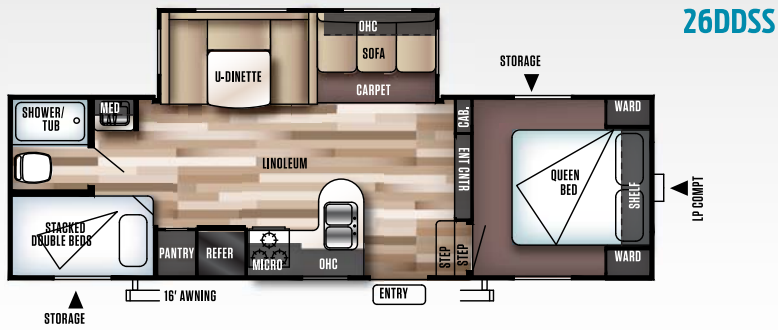

**26DDSS**  
**7,103**  
 DRY WEIGHT

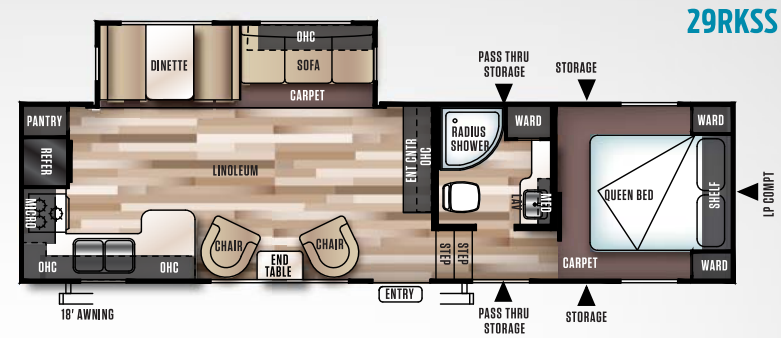

**29RKSS**  
**7,832**  
 DRY WEIGHT

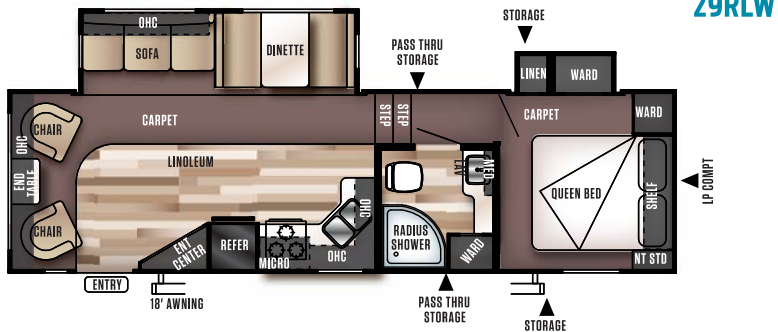

**29RLW**  
**7,394**  
 DRY WEIGHT

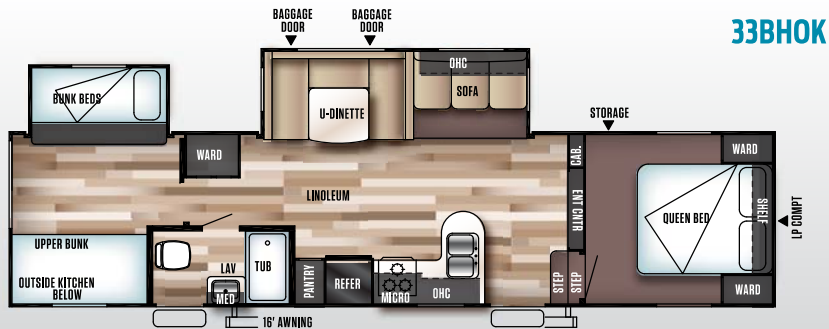

**33BHOK**  
**9,107**  
 DRY WEIGHT



## America's Choice

Wildwood brand trailers are becoming America's choice for another reason beyond interior appointments. The quality in construction of this unit makes it the wise choice in "Family Affordability." We start with a foundation of 5/8" tongue and groove exterior-grade plywood flooring. This is glued and "ring shank" nailed to 2"x3" floor joists. This glue is so strong many refer to it as a "wood weld." Here is a list of outstanding construction exterior features.

1. Overpowered drive motor for the slideout mechanism
2. One-piece seamless SuperFlex® roof
3. Smooth fiberglass entrance and compartment doors
4. Heated enclosed fresh water tanks for extended season use.
5. Triple seal on slideout openings, with maximum duty perimeter strength.
6. Select axles with fully machined spindles, manufactured to exacting tolerances. The best spindle in the business helps your unit to pull arrow straight.
7. Our (CCC) cargo carrying capacities are as good or better than any brand in the business.
8. Towability is maximized, with the right combination of balance, axle placement, weight and aerodynamics.

## WILDWOOD Fifth Wheels

	26DDSS	29RKSS	29RLW	33BHOK
HITCH WEIGHT (LBS.)	1272	1418	1441	1704
DRY SHIP WEIGHT (LBS.)	7103	7832	7394	9107
CARGO CARRYING CAPACITY (LBS.)	4291	3708	4169	2719
EXTERIOR LENGTH	30'9"	34'1"	31'8"	37'9"
EXTERIOR HEIGHT	12'3"	12'6"	12'6"	12'9"
FRESH WATER CAPACITY (GAL.)	40	40	40	40
BLACK WATER CAPACITY (GAL.)	30	30	27	30
GREY WATER CAPACITY (GAL.)	27	54	27	57
AWNING SIZE (FT.)	16'	18'	18'	16'

## WILDWOOD Floorplan Key

Pillows and blankets shown on beds and bunks are for demonstration purposes only and do not come with your new coach.

- OHC  
OVERHEAD CABINET
- WARD  
WARDROBE
- WARDROBE
- MICRO  
MICROWAVE
- LAV  
BATHROOM SINK

# The Wildwood product lineup



WILDWOOD



X-LITE



HERITAGE GLEN



DLX | LODGE



Forest River, Inc. encourages our customers to purchase their Forest River products from a local dealership whenever possible for the following reasons:

It is the goal of Forest River, Inc. that all of our RV owners fully enjoy the RV experience and that customer satisfaction meets or exceeds their expectations!

- 1) Forest River, Inc. dealers are independently owned and operated businesses so priority service and scheduling is at their discretion and is often provided to customers that purchased their unit at that dealership.
- 2) Purchasing locally allows customers to establish meaningful relationships with a dealer, enhancing the RV experience through assistance with product questions, user tips or RV regulations for your state or country, and much more!
- 3) Canadian customers must meet requirements to bring an RV purchased out of the country to their home. These requirements may involve additional inspections and certifications, taxes and fees. Your local Canadian Dealer is a professional at meeting these requirements.
- 4) Scheduling timely warranty repairs and adjustments through a local dealership provides far greater flexibility and convenience to you, the customer!

**FREE MEMBERSHIP**  
to Forest River Owners' Group

[www.forestriverfrog.com](http://www.forestriverfrog.com)



**Learn More**  
Scan this barcode using a QR Reader on your smart phone to learn more about Forest River.



A Berkshire Hathaway company.

FOREST RIVER, INC. 55470 C.R. 1 ELKHART, IN 46515 | (574) 533-5934  
[WWW.FORESTRIVERINC.COM/WILDWOOD](http://WWW.FORESTRIVERINC.COM/WILDWOOD) | [WWW.FORESTRIVERACCESSORIES.COM](http://WWW.FORESTRIVERACCESSORIES.COM)

## Specification Definitions

**GVWR (Gross Vehicle Weight Rating)** - is the maximum permissible weight of the unit when fully loaded. It includes all weights, inclusive of all fluids, cargo, optional equipment and accessories. For safety and product performance do NOT exceed the GVWR.

**GAWR (Gross Axle Weight Rating)** - is the maximum permissible weight, including cargo, fluids, optional equipment and accessories that can be safely supported by a combination of all axles.

**UVW (Unloaded Vehicle Weight)\*** - is the typical weight of the unit as manufactured at the factory. It includes all weight at the unit's axle(s) and tongue or pin and LP Gas. The UVW does not include cargo, fresh potable water, additional optional equipment or dealer installed accessories.

\*Estimated average based on standard build optional equipment.

**CCC (Cargo Carrying Capacity)\*\*** - is the amount of weight available for fresh potable water, cargo, additional optional equipment and accessories. CCC is equal to GVWR minus UVW. Available CCC should accommodate fresh potable water (8.3 lbs per gallon). Before filling the fresh water tank, empty the black and gray tanks to provide for more cargo capacity.

\*\* Estimated average based on standard build optional equipment

Each Forest River RV is weighed at the manufacturing facility prior to shipping. A label identifying the unloaded vehicle weight of the actual unit and the cargo carrying capacity is applied to every Forest River RV prior to leaving our facilities.

The load capacity of your unit is designated by weight, not by volume, so you cannot necessarily use all available space when loading your unit.

All information contained in this brochure is believed to be accurate at the time of publication. However, during the model year, it may be necessary to make revisions and Forest River, Inc., reserves the right to make all such changes without notice, including prices, colors, materials, equipment and specifications as well as the addition of new models and the discontinuance of models shown in this brochure. Therefore, please consult with your Forest River dealer and confirm the existence of any materials, design or specifications that are material to your purchase decision. Litho. U.S.A P/W: 2014.09.17

## 24/7 EMERGENCY ROADSIDE ASSISTANCE

For a worry-free ownership experience Forest River includes one year of Coach-Net RV Technical & Roadside Assistance with each RV purchase. Whether new to the RV lifestyle or an experienced RV enthusiast, Forest River owners have 24/7 access to technical, operational and emergency road service coverage throughout the US & Canada. Coach-Net's fast, dependable service is just a phone call away.

**Coach-Net®**  
RV Technical & Roadside Assistance



## PRE-DELIVERY INSPECTION FACILITY

20,000 square feet of quality assurance. The bare essentials for a premium product. This state-of-the-art facility gives immediate daily feedback to production for quality assurance in every unit built.

YOUR WILDWOOD DEALER

2017