

# PASSPORT

MINI / SL / GT TRAVEL TRAILERS



KEYSTONE  
RV COMPANY

CAMP BETTER  
KINDNESS · COMMUNITY · PLANET

# KEYSTONE OWNER'S SUPPORT

Keystone makes operating and maintaining your new RV easy with world-class resources and support. Owners have access to a wide variety of support tools and services via the MyKeystone mobile app and the Owner's section of [KeystonerRV.com](http://KeystonerRV.com).

## FIRST TIME CAMPER'S VIDEO SERIES

A comprehensive guide to RV camping basics with Keystone's Matt & Bart.

## PRO TIPS DIY OPERATION & MAINTENANCE VIDEO LIBRARY

Visit our growing collection of step-by-step video and written guides to operating, maintaining, and repairing your Keystone RV.

## DIGITAL OWNER'S MANUAL

Our new online owner's manual is fully searchable and features helpful visual and video support.

## DIY REPAIR PROGRAM\*

which includes free parts for small repairs within your first year of ownership

## 1-YEAR LIMITED BASE WARRANTY\*

## 3-YEAR LIMITED STRUCTURAL WARRANTY\*

\*See [KeystoneRV.com](http://KeystoneRV.com) for full details. PRO TIP: Owners should work with their dealers or other Keystone authorized service center or mobile tech to document all warranty claims within the warranty period.

VISIT OUR WEBSITE FOR PHOTOS,  
360° TOURS, AND FULL PRODUCT DETAILS



## PASSPORT SPECIFICATIONS

\*Estimated Weights And Lengths Listed, Visit [Keystonerv.com](http://Keystonerv.com) For Full Specifications

MODEL	WEIGHT	CARRYING CAPACITY	HITCH WEIGHT	FRESH WATER**	WASTE WATER	GRAY WATER	LPG	LENGTH*	WIDTH	HEIGHT	AWNING
170BH	3485	1340	425	37	30	30	20	21' 4"	8'	10' 5"	11'
190RD	3510	1310	420	37	30	30	20	21' 11"	8'	10' 5"	11'
189RB/WE	4883	2465	615	37	30	30	40	23' 1"	8'	10' 8"	10'
219BH/WE	4794	2332	535	37	30	30	40	25' 10"	8'	10' 8"	15'
221BH/WE	5330	2241	625	37	30	60	40	26' 4"	8'	10' 8"	15'
229BH/WE	5155	1845	720	54	38	38	40	26' 9"	8'	10' 8"	15'
229RK/WE	5590	2549	700	54	38	38	40	27' 4"	8'	10' 8"	19'
253RD/WE	5709	1940	835	54	38	60	40	29' 10"	8'	10' 8"	21'
268BH/WE	6170	2125	700	54	38	76	40	30' 10"	8'	10' 8"	19'
282QB/WE	6166	2100	750	54	38	76	40	33' 3"	8'	10' 8"	21'
2600FK	7085	1415	1205	54	38	76	40	30' 3"	8'	11' 3"	19'
2605RB/WE	6226	1374	725	54	38	76	40	30' 6"	8'	10' 8"	21'
2870RL/WE	7110	2150	860	54	38	76	40	33' 0"	8'	11' 2"	10'/10'
2900BH/WE	6380	1220	705	54	30	60	40	33' 6"	8'	10' 8"	21'
3100RE	7945	1255	920	54	38	76	40	36' 0"	8'	11' 2"	11'/11'
3300BK	7995	1805	1165	54	76	76	40	31' 11"	8'	11' 4"	21'
3401QD	7929	1741	980	37	38	76	40	39' 3"	8'	11' 2"	21'

# SOLAR FLEX™



**NEW** 2024 PACKAGE UPDATES

For more information scan the QR code or visit [keystonerv.com](http://keystonerv.com).

## TAKE CHARGE OF HOW YOU CAMP

EXCEPTIONAL QUALITY, IMPOSSIBLY VERSATILE, SolarFlex™ IS SHATTERING CUSTOMER'S EXPECTATIONS OF FACTORY-INSTALLED SOLAR POWER. EXCLUSIVELY AVAILABLE ON ALL KEYSTONE RV MODELS.



Keystone RV is proud to partner with Dragonfly Energy to offer their legendary heated Lithium-ion batteries exclusively on all Keystone models.



FOLLOW US FOR THE LATEST!



DISCLAIMER: Product information is as accurate as possible as of the date of publication of this brochure. All features, floor plans, and specifications in this brochure are subject to change without notice. Please also consult Keystone's web site at [www.keystonerv.com](http://www.keystonerv.com) for more current product information and specifications. Tow Vehicle Disclaimer. CAUTION: Owners of Keystone recreational vehicles are solely responsible for the selection and proper use of tow vehicles. All customers should consult with a motor vehicle manufacturer or their dealer concerning the purchase and use of suitable tow vehicles for Keystone products. Keystone disclaims any liability or damages suffered as a result of the selection, operation, use or misuse of a tow vehicle. KEYSTONE'S LIMITED WARRANTY DOES NOT COVER DAMAGE TO THE RECREATIONAL VEHICLE OR THE TOW VEHICLE AS A RESULT OF THE SELECTION, OPERATION, USE OR MISUSE OF THE TOW VEHICLE. \*Length is defined as the distance from the centerline of hitch pin/coupler to rear bumper of trailer. \*\* Fresh water capacity includes water heater. Please review owner's manual prior to purchase for more information on service warranties, extended use, towing and maintenance. Owner's manuals can be found at [keystonerv.com](http://keystonerv.com).

PRINT 09.2023

# LIMITLESS ADVENTURE AWAITS

Step into a world of limitless possibilities with Passport Ultra-Light travel trailers, where towing confidence, agility, and the thrill of spontaneity reigns supreme. Embrace a new level of adventure on the open road, where Passport becomes your gateway to unforgettable journeys. With two distinct product lines, Grand Touring (GT) and Super-Light (SL), Passport offers options tailored to your preferences and tow vehicle. The GT boasts larger floorplans and enhanced features, while the SL delivers nimble, compact layouts, ensuring an array of choices to match your towing needs and fulfill your desire for exploration.

**Discover the joy of effortless travel, and let Passport be your companion in navigating the boundless landscapes of your next adventure.**

## ALL PASSPORT MODEL FEATURES

\*N/A ON MINI FLOORPLANS (170BH & 190RD)

- **NEW** Exterior Graphics
- **NEW** Dexter TORFLEX® Rubber Torsion Suspension Axles
- **NEW** Bumper Utility Hitch\*
- Power Stabilizer Jacks, Tongue Jack\*
- Power Awnings
- Fully Walkable Roof & Rear Ladder\*
- Norco Frame, Specifically Engineered for Each Floorplan (EASTERN FLOORPLANS ONLY)
- Hyperdeck™ High-Performance, Water-Resistant RV Floors
- Heated & Enclosed Underbelly for Extended Season Camping\*
- Furrion® 15K BTU Chill HE Air Conditioner w/ 30° Delta T & Alternating Dual Fan
- TST Tire Pressure Monitoring System\*
- Girard Tankless On-Demand Water Heater
- Exterior Docking Station\*
- Lippert SolidStep® Entry Steps\*
- Giggy Box 12V Distribution Center w/ Battery Disconnect\*
- Continuous Edge Countertops\*
- Stainless Steel Farmhouse Sink\*
- **NEW** 12V Refrigerator
- **NEW** Do-More Portable Dinette\* (most floorplans)
- **NEW** Furrion® Appliances\*
- **NEW** Sprayer Faucet\*
- Pillow-Side Shelving to Accommodate CPAP Machine\*
- Large Pass-Through Storage w/ Peg Board Storage Panel
- 12V Smart TV\*
- SolarFlex™ Ready, Protect 220 & Discover 440i\* Solar Power Packages
- Winegard™ Air 360+ Omnidirectional Antenna w/ Wi-Fi/4G LTE
- 1-Year Limited Base Warranty & 3-Year Limited Structural Warranty (SEE KEYSTONERV.COM FOR DETAILS)

## PASSPORT SL EXCLUSIVE FEATURES

- **NEW** Front-end Metal Skin
- 20,000 BTU Furnace
- Rear Ladder Prep (180BH & 190RD)
- Rear Ladder (ALL DUAL-AXLE MODELS)

## PASSPORT GT EXCLUSIVE FEATURES

- **NEW** High-Impact Thermoset Resin Front Cap
- 30,000 BTU Furnace
- Domed Ceilings
- Residential, 60" X 80" Queen-Sized Bed
- **NEW** Black Roller Shades
- Convertible Cabinets
- **NEW** Dinette Storage w/ Drawers

## MINI TRAVEL TRAILERS

\*Estimated Weights And Lengths Listed, Visit [Keystonerv.com](http://Keystonerv.com) For Full Specifications

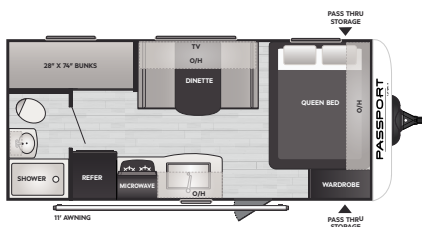

**170BH** | WEIGHT **3485** | LENGTH **21' 4"**

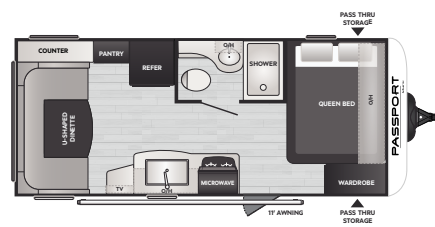

**190RD** | WEIGHT **3510** | LENGTH **21' 11"**

WE = OREGON PRODUCTION MODEL, SPECIFICATIONS MAY VARY SLIGHTLY

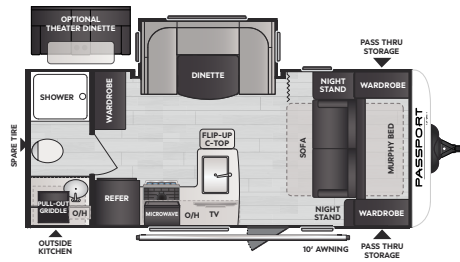

**189RB/WE** | WEIGHT **4883** | LENGTH **23' 1"**

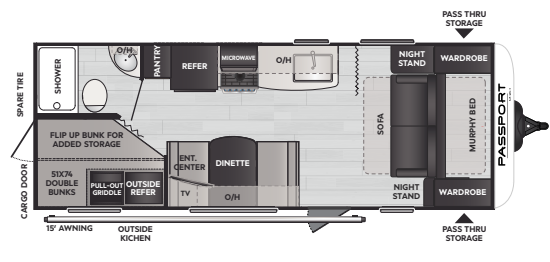

**219BH/WE** | WEIGHT **4794** | LENGTH **25' 10"**

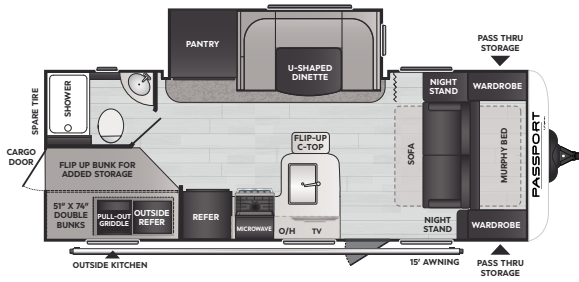

**221BH/WE** | WEIGHT **5330** | LENGTH **26' 4"**

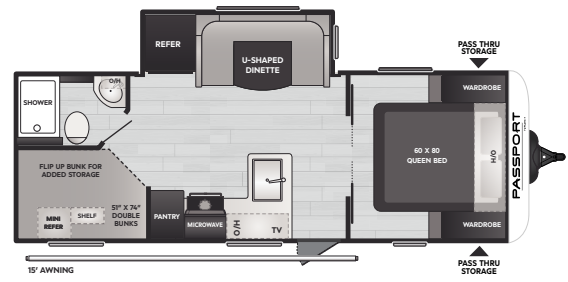

**229BH/WE** | WEIGHT **5590** | LENGTH **27' 4"**

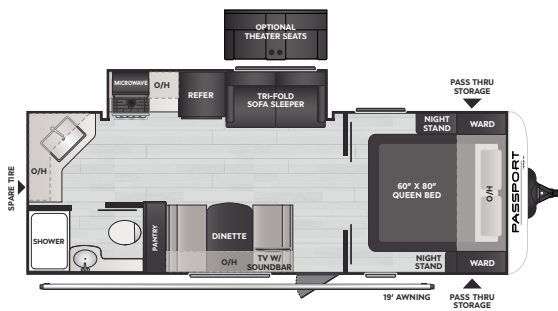

**229RK/WE** | WEIGHT **5590** | LENGTH **27' 4"**

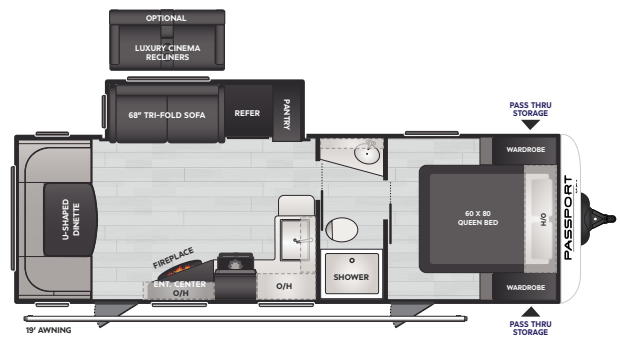

**253RD/WE** | WEIGHT **5709** | LENGTH **29' 10"**

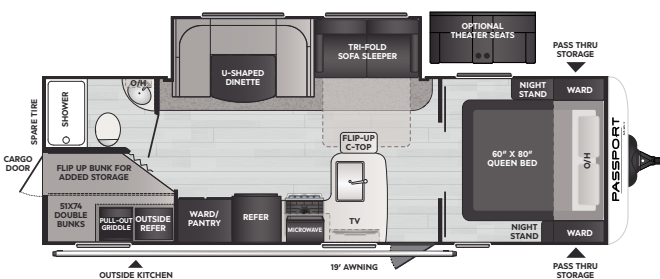

**268BH/WE** | WEIGHT **6170** | LENGTH **30' 4"**

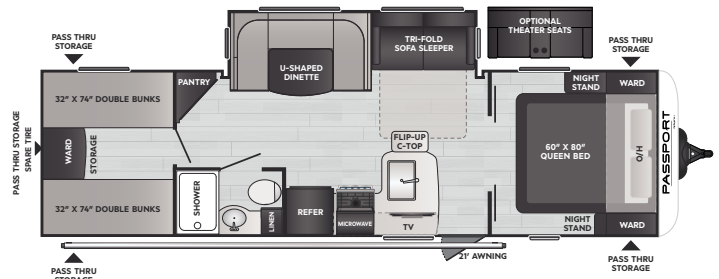

**282QB/WE** | WEIGHT **6166** | LENGTH **33' 3"**

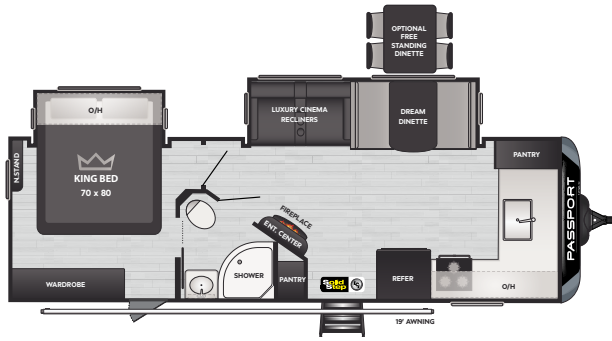

**2600FK** | WEIGHT 7085 | LENGTH 30' 3"

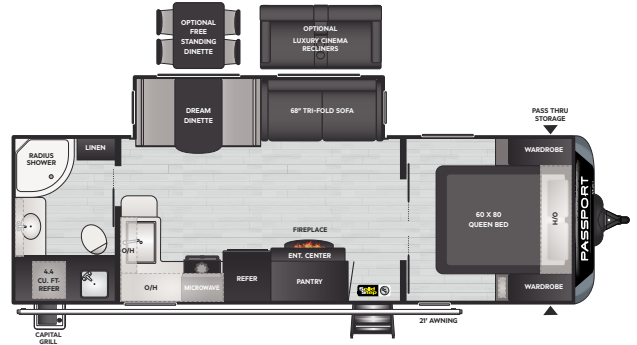

**2605RB/WE** | WEIGHT 6226 | LENGTH 30' 6"

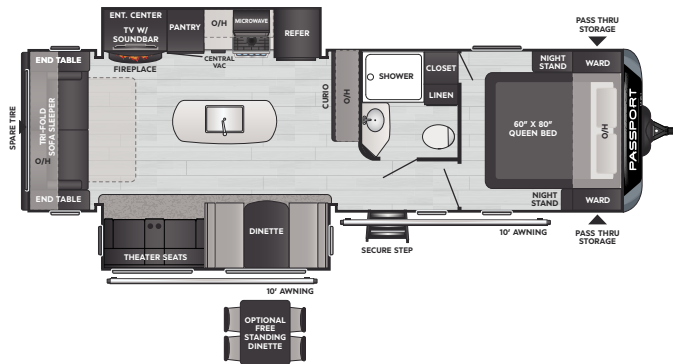

**2870RL/WE** | WEIGHT 7110 | LENGTH 33' 0"

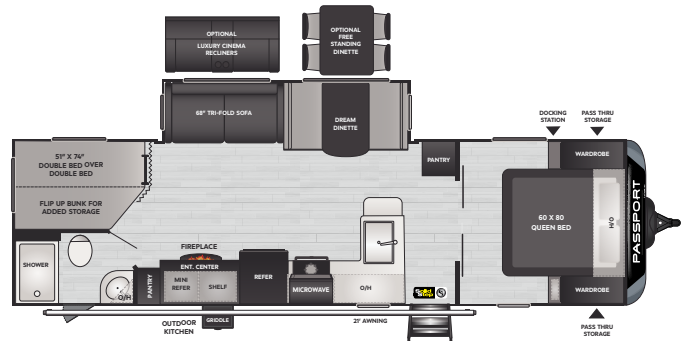

**2900BH/WE** | WEIGHT 6380 | LENGTH 33' 6"

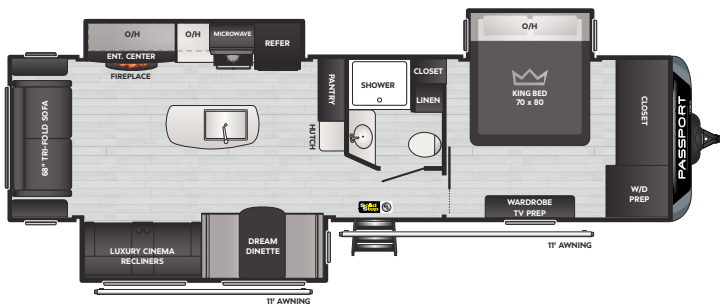

**3100RE** | WEIGHT 7945 | LENGTH 36' 10"

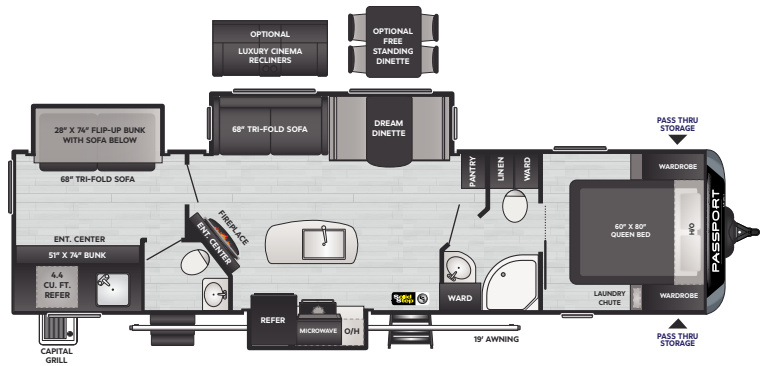

**3300BK** | WEIGHT 7995 | LENGTH 31' 11"

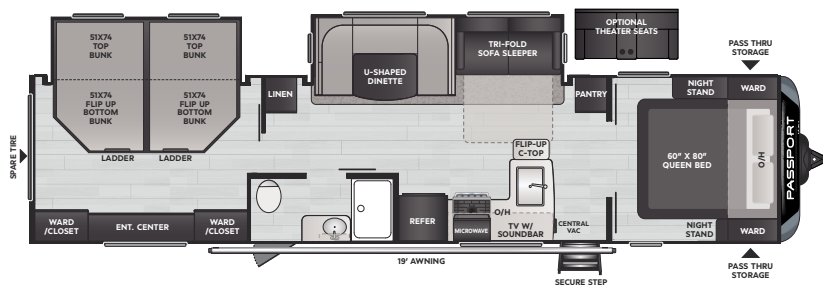

**3401QD** | WEIGHT 7929 | LENGTH 39' 3"