

FREEDOM EXPRESS ♦ ULTRA LIGHT TRAVEL TRAILERS ♦ DEEP SLIDES ♦ TOY HAULERS ♦ EXPANDABLES

FREEDOM TO EXPLORE

FREEDOM *Express*



FREEDOM EXPRESS ♦ ULTRA LIGHT TRAVEL TRAILERS ♦ DEEP SLIDES ♦ TOY HAULERS ♦ EXPANDABLES



321 FEDSLE

Experience game day action in style on this 55" Smart TV. The front living room in the 321 FEDSLE is so expansive, there's enough room to jump up and dance with every touch-down! There's not a bad seat in the house with theatre seating, plus an opposing Hide-a-Bed sofa and convenient service bar. Shown in Java decor.

Total Freedom - Ultra Light Selection

Escape from your busy life for a fun, hassle-free adventure with Freedom Express. These ultra light models are value packed with industry leading features. The Liberty Edition (Maple Leaf Edition in Canada) includes high end amenities usually reserved for travel trailers and fifth wheels costing thousands of dollars more. Most models come in three price points to fit any budget. Our 38" Deep Slide models offer expansive single, double and triple slide living areas. Storage and counter space are a top priority on all models. Choose from the industry's best bunk and rear lounge floor plans, plus Toy Hauler models.



This bath has a spacious, super-size 30" x 50" shower with a glass enclosure and abundant linen storage.



The 321 FEDSLE's private rear slide master suite has amazing wardrobe storage. The bed slide includes a handy cordless rechargeable Dyson® vacuum.



276 RKDSLE

Couples appreciate this comfortable model with spacious, 176 cu. ft. of interior storage, a 30" x 50" shower with a glass door, extended counter space, two convenient entrances and a wide awning that covers both doors. Shown in Willow decor.



276 RKDSLE

Liberty and Maple Leaf Editions feature a Gel Coat Fiberglass cap.



322 RLDSE



320BHDSLE



320 BHDSLE - The family cook will love this open concept floor plan with an accented wood kitchen island for extra counter space, a deep basin sink and pull-out faucet, plus large storage drawers. The plush hide-a-bed sofa converts for extra sleeping space. Shown in Java decor.



Freedom Express is TRA gold level rated. As a certified green RV, Freedom Express utilizes effective production techniques in combination with healthy materials, plus efficient usage of energy and water to produce a high quality RV with less environmental impact.



This popular 320 BHDSLE outdoor kitchen comes complete with a refrigerator, Coleman grill, TV outlet, storage, plus a sink with hot and cold running water!



The 320 BHDSLE bunkhouse model is loaded with storage. Kids enjoy climbing the Rock Blocks to the upper bunk. The large entry closet provides plenty of shelving for shoes, extra gear and a waste basket.



FREEDOM TO EXPLORE



FREEDOM VALUE PACKAGE

(Required)

- ♦ Aluminum Wheels
- ♦ Spare Tire Kit
- ♦ Detachable Power Cord
- ♦ Power Awning
- ♦ Tinted Safety Glass Windows
- ♦ TV and Radio Antenna with Booster
- ♦ E-Z Lube® Axles
- ♦ Spread Axle Design*
- ♦ Heated Enclosed Underbelly*
- ♦ Solar Port
- ♦ Folding Entry Assist Handle
- ♦ Exterior Shower Station
- ♦ Winterize Ready Kit
- ♦ Black Tank Flush
- ♦ Magnetic Catches Compartment Doors
- ♦ 2 Exterior Speakers, 4 Interior Speakers
- ♦ Ducted Furnace*
- ♦ Ducted Ceiling Air Conditioning (25' and above)
- ♦ AM/FM/CD/DVD/Bluetooth
- ♦ 24", 32", 39" or 55" LED TV
- ♦ Satellite Ready
- ♦ LED Interior Lighting Throughout
- ♦ Night Shades Throughout
- ♦ Congoleum Designer Carefree Flooring
- ♦ Mortise and Tenon Cabinet Doors
- ♦ Stonecast Sink
- ♦ Sink Covers
- ♦ Galley LED Strip Light
- ♦ Microwave
- ♦ Oven with 3 Burner Cooktop

- ♦ Butcher Block Stove Cover
- ♦ 6 Cu. Ft. Two Door Refrigerator
- ♦ Silverware Drawer (select models)
- ♦ 60" x 80" Queen Bed
- ♦ LED Swivel Crystal Reading/Night Light - Bedroom
- ♦ Electronic Charging Station
- ♦ Skylight in Bath
- ♦ RVIA
- ♦ LED 4" Recessed Lights in Living Area
- ♦ White LED Awning Light
- ♦ 12" LED Step Light
- ♦ LED Light Strip in Pass-through Storage
- ♦ 24" x 48" Resin Outdoor Table

LIBERTY/MAPLE LEAF EDITION PACKAGE (Upgrade)

- ♦ Gel Coated Fiberglass Cap with LED Hitch and Marker Lights
- ♦ Front Rock Guard on Cap
- ♦ Special Liberty/Maple Leaf Edition Graphics
- ♦ Slam Latch Baggage Doors on Pass Through Storage
- ♦ Enclosed and Heated Gate Valves
- ♦ Power Tongue Jack
- ♦ RG6 TV Hook-up Camp Side
- ♦ Camp Side Security Light
- ♦ Central Control Panel for Switches and Gauges
- ♦ Raised Panel (uppers) Glazed Independence Maple Doors
- ♦ Refer Inserts
- ♦ Solid Surface Kitchen Countertop Undermount Stonecast Sink with Sink Covers

- ♦ Silver Reeded Glass Backsplash
- ♦ Pull Out Sprayer Faucet
- ♦ Decorative Light over Dinette and matching Wall Sconce
- ♦ Hide-A-Bed Sofa
- ♦ Hinged Door, Slider Drawer and Pots and Pans Drawer Under Dinette
- ♦ Designer Bedspread with matching Pillows
- ♦ Porcelain Toilet with Foot Flush
- ♦ Three Upgrade Décors - Java, Sienna, Willow
- ♦ Electric Fireplace
- ♦ Large 8 Cu. Ft. Refrigerator
- ♦ 3" Recessed LED Lighting over Dinette
- ♦ LED Rope Light at Awning, 12" LED Strip Light Entry Step and Pass-through Storage (N/A 276 RKDS, 293 RLDS and 297 RLDS)
- ♦ Durable 24" x 48" Resin Outdoor Table

ADDITIONAL OPTIONS

- ♦ 15,000 BTU A/C
- ♦ 50 Amp Service with Second A/C Prep
- ♦ Push-button Power Stabilizer Jacks (25' and above)
- ♦ Coleman Slide-Out High Output Grill (Select models)
- ♦ Frameless Windows
- ♦ Thermal Pack
- ♦ Ladder
- ♦ Free Standing Dinette with 4 Chairs
- ♦ Canadian Compliance



279 RLSLE

The 279RLSLE has many windows and includes an L-shaped kitchen, a large bath with an oversized vanity and plenty of storage. It's the perfect size to tow with a small SUV. Shown in Sienna decor.



279 RLSLE

The comfortable 276 RKDSLE is spacious, with 176 cu. ft. of interior storage, a 30" x 50" shower with a glass door, extended counter space, two convenient entrances and a wide awning that covers both doors. Shown in Willow decor.



276 RKDSLE

DECOR

WILLOW



SIENNA



JAVA



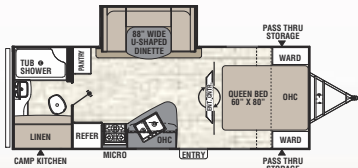

231 RBDSLE ♦ Exterior Length 26' 10"

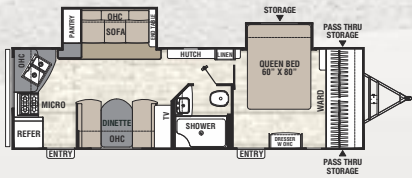

276 RKDSLE ♦ Exterior Length 31' 6"

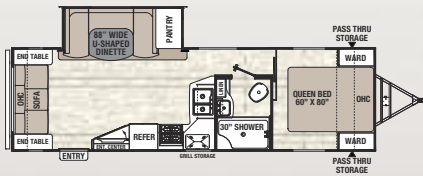

279 RLDLSLE ♦ Exterior Length 31' 11"

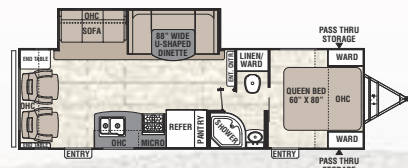

281 RLDLSLE ♦ Exterior Length 31' 8"

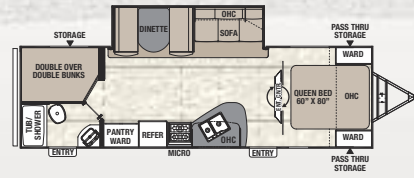

282 BHDLSLE ♦ Exterior Length 31' 11"

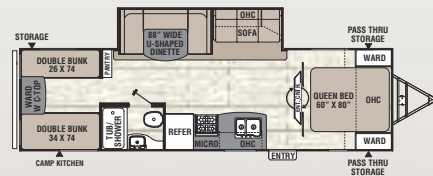

292 BHDLSLE ♦ Exterior Length 33' 5"

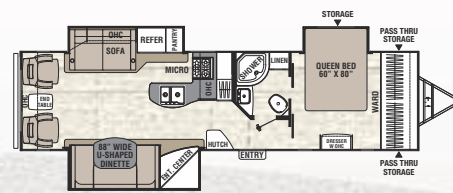

293 RLDLSLE ♦ Exterior Length 35' 11"

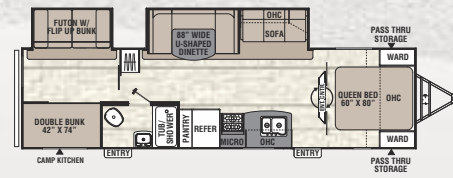

310 BHDLSLE ♦ Exterior Length 35' 7"

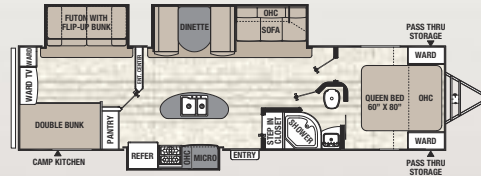

320 BHDLSLE ♦ Exterior Length 36' 11"

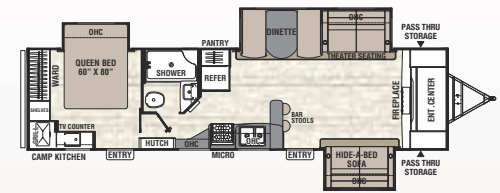

321 FEDSLE ♦ Exterior Length 36' 11"

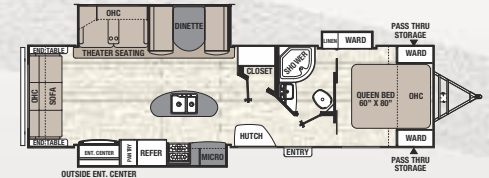

322 RLDLSLE ♦ Exterior Length 35' 11"

Deep Slides	231 RBDSLE	276 RKDSLE	279RLDSLE	281 RLDLSLE	282 BHDLSLE	292 BHDLSLE	293 RLDLSLE	310 BHDLSLE	320 BHDLSLE	321 FEDSLE	322 RLDLSLE
UVW*	5,268	6,365	5,949	6,003	6,205	6,384	7,851	7,454	7,952	7,906	7,449
Hitch Weight	645	791	741	712	819	747	985	937	879	1,071	954
Carrying Capacity	2,232	1,235	1,651	1,597	1,495	1,216	2,047	2,446	2,748	2,794	2,351
Exterior Length (Bumper to Hitch)	26' 10"	31' 6"	31' 11"	31' 8"	31' 11"	33' 5"	35' 11"	35' 7"	36' 11"	36' 11"	35' 11"
Exterior Height (Includes A/C)	10' 9"	10' 9"	10' 9"	10' 9"	10' 9"	10' 7"	11' 2"	11'	11' 2"	11' 2"	11' 2"
Interior Height (Coach)	81"	81"	81"	81"	81"	81"	81"	81"	81"	81"	81"
Awning Length	14'	20'	18'	18'	18'	18'	12' and 10'	18'	20'	17'	20'
Fresh/Grey/Waste Water Cap. (gal.)	49/33/33	49/66/33	49/33/33	49/33/33	49/33/33	49/33/33	49/33/33	49/33/33	49/66/33	49/63/33	49/33/33
Tire Size	ST205/75R14C	ST205/75R14C	ST205/75R14C	ST205/75R14C	ST205/75R14C	ST205/75R14C	ST225/75R15D	ST225/75R15D	ST225/75R15D	ST225/75R15D	ST225/75R15D

*Unloaded vehicle weights do not include options. Please refer to back cover for definitions of chart descriptions.



- ♦ 50% Lighter than wood
- ♦ No rot, mold or water damage
- ♦ R-2 thermal insulation
- ♦ Odorless, no formaldehyde
- ♦ Sound and energy absorbing
- ♦ Impact and puncture resistant
- ♦ Made in USA





257 BHS

Friends and family appreciate this private master suite and double-over-double bunks. It's great for entertaining with large counters, an extended butcher block stove cover, an 88" dinette and an outside kitchen. Shown in Chestnut decor.

Find Your Freedom - Ultra Lightweight Towability and Convenience

Lightweight Freedom Express has been designed for easy towing with today's half ton trucks, cross overs and mid-sized SUVs. All tanks are located under the floor to lower the center of gravity for increased storage capacity and improved handling.



257 BHS





248 RBS



This spacious floor plan has a sofa-facing entertainment center and is the perfect couple-friendly getaway RV with a radius shower and abundant bath storage. Shown in Cashmere decor.





248 RBS

This spacious, conversation-friendly kitchen has a butcher block stove cover for increased prep space and a private master bedroom. 248 RBS can be towed by smaller SUVs. Shown in Cashmere decor.

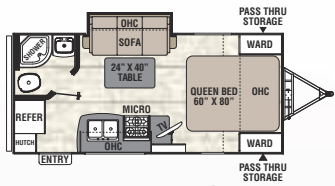

192 RBS ♦ Exterior Length 22' 6"

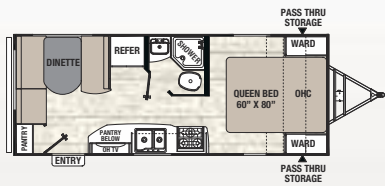

204 RD ♦ Exterior Length 24' 7"

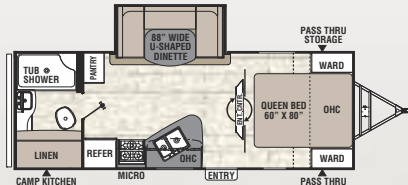

231 RBDS ♦ Exterior Length 26' 10"

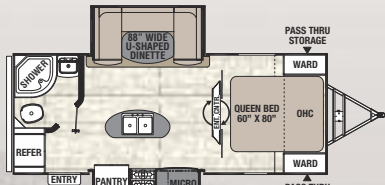

233 RBS ♦ Exterior Length 24' 11"

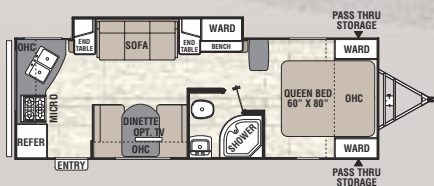

246 RKS ♦ Exterior Length 28' 3"

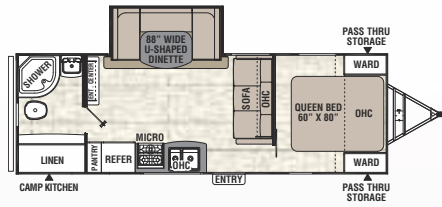

248 RBS ♦ Exterior Length 28' 11"

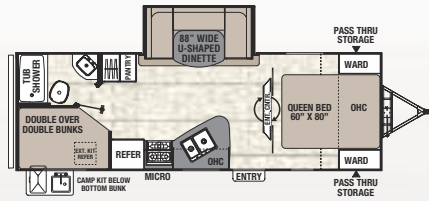

257 BHS ♦ Exterior Length 28' 7"

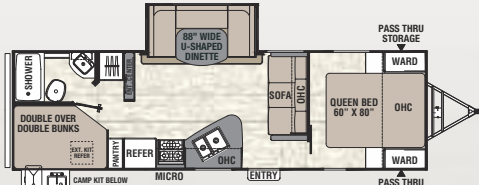

275 BHS ♦ Exterior Length 31' 8"

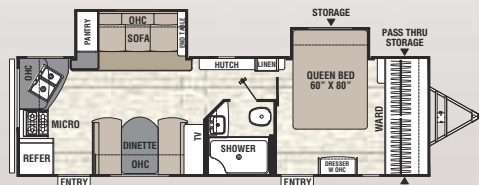

276 RKDS ♦ Exterior Length 31' 6"

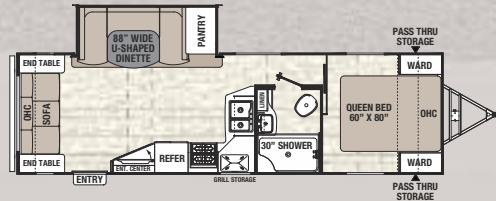

279 RLDS ♦ Exterior Length 31' 11"

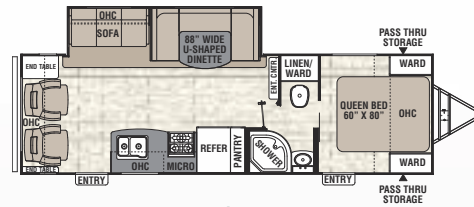

281 RLDS ♦ Exterior Length 31' 8"

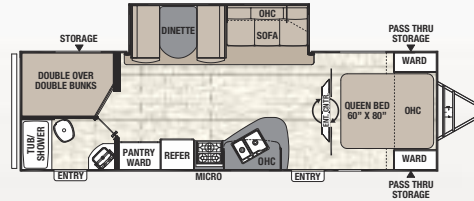

282 BHDS ♦ Exterior Length 31' 11"

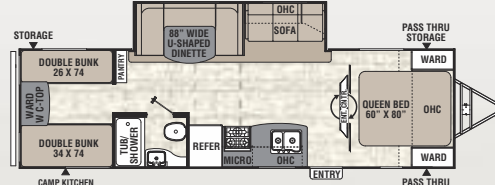

292 BHDS ♦ Exterior Length 33' 5"

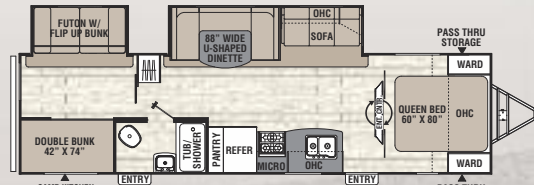

310 BHDS ♦ Exterior Length 35' 7"

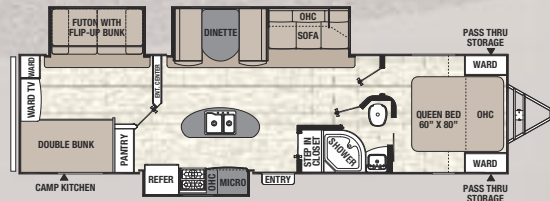

320 BHDS ♦ Exterior Length 36' 11"

FREEDOM TO EXPLORE

FREEDOM
Express

FREEDOM VALUE PACKAGE

(Required)

- ◆ ¾ Gel Coated Fiberglass Front Cap with LED Lights
- ◆ Aluminum Wheels
- ◆ Spare Tire Kit
- ◆ Detachable Power Cord
- ◆ Power Awning
- ◆ Magnetic Catch Compartment Doors
- ◆ Tinted Safety Glass Windows
- ◆ Front Diamond Plate
- ◆ TV & Radio Antenna with Booster
- ◆ E-Z Lube® Axles
- ◆ Spread Axle Design*

- ◆ Heated Enclosed Underbelly*
- ◆ Solar Port
- ◆ Folding Entry Assist Handle
- ◆ Exterior Shower Station
- ◆ Winterize Ready Kit
- ◆ Black Tank Flush
- ◆ 2 Exterior Speakers, 4 Interior Speakers
- ◆ Ducted Furnace*
- ◆ Ducted Ceiling Air Conditioning (25' and above)
- ◆ AM/FM/CD/DVD/Bluetooth
- ◆ 24", 32" or 39" LED TV
- ◆ Satellite Ready
- ◆ LED Interior Lighting Throughout

- ◆ Night Shades Throughout
- ◆ Congoleum Designer Carefree Flooring
- ◆ Mortise and Tenon Cabinet Doors
- ◆ Stonecast Sink
- ◆ Sink Covers
- ◆ Galley LED Strip Light
- ◆ Microwave
- ◆ Oven with 3 Burner Cooktop
- ◆ Butcher Block Stove Cover
- ◆ 6 Cu. Ft. Two Door Refrigerator
- ◆ Silverware Drawer (select models)
- ◆ 60" x 80" Queen Bed
- ◆ LED Swivel Crystal Reading/Night Light - Bedroom

- ◆ Electronic Charging Station
- ◆ Skylight in Bath
- ◆ RVIA
- ◆ LED 4" Recessed Lights in Living Area
- ◆ White LED Awning Light
- ◆ 12" LED Step Light
- ◆ LED Light Strip in Pass-through Storage (N/A 276 RKDS, 297 RLDS)
- ◆ 24" x 48" Resin Outdoor Table

OPTIONS

- ◆ 15,000 BTU A/C
- ◆ 50 Amp Service with Second A/C Prep
- ◆ Push-button Power Stabilizer Jacks (25' and above)

- ◆ Power Tongue Jack
- ◆ Coleman Slide-Out High Output Grill (Select models)
- ◆ Hide-A-Bed (Deep slides only)
- ◆ RV Eye Wi-Fi Cameras
- ◆ Frameless Windows
- ◆ Ladder (N/A 271 BL and 301 BLDS)
- ◆ 8 Cu. Ft. Refrigerator
- ◆ Thermal Pack
- ◆ Free Standing Dinette with 4 Chairs
- ◆ Canadian Compliance

*Not available on models under 25'

Freedom Express	192 RBS	204 RD	231 RBDS	233 RBS	246 RKS	248 RBS	257 BHS	275 BHS
UVW*	3,850	3,991	5,074	4,786	4,700	5,407	5,263	5,881
Hitch Weight	392	561	585	635	500	705	666	715
Carrying Capacity	2,050	2,009	2,426	2,214	2,300	2,093	2,237	1,719
Exterior Length (Bumper to Hitch)	22' 6"	24' 7"	26' 10"	24' 11"	28' 3"	28' 11"	28' 7"	31' 9"
Exterior Height (Includes A/C)	10' 3"	10' 9"	10' 9"	10' 9"	10' 4"	10' 9"	10' 9"	10' 9"
Interior Height (Coach)	81"	81"	81"	81"	81"	81"	81"	81"
Awning Length	14'	16'	14'	16'	18'	16'	20'	16'
Fresh/Grey/Waste Water Capacity (gal.)	36/30/30	49/33/33	49/33/33	36/30/30	49/33/33	49/33/33	49/33/33	49/33/33
Tire Size	ST205/75R14C	ST205/75R14C	ST205/75R14C	ST205/75R14C	ST205/75R14C	ST205/75R14C	ST205/75R14C	ST205/75R14C

*Unloaded vehicle weights do not include options. Please refer to back cover for definitions of chart descriptions.

Deep Slides	276 RKDS	279 RLDS	281 RLDS	282 BHDS	292 BHDS	310 BHDS	320 BHDS
UVW*	6,089	5,949	5,640	5,906	6,098	7,245	7,734
Hitch Weight	730	741	740	736	740	865	820
Carrying Capacity	1,511	1,651	1,960	1,794	1,502	2,655	2,966
Exterior Length (Bumper to Hitch)	31' 6"	31' 11"	31' 8"	31' 11"	33' 5"	35' 7"	36' 11"
Exterior Height (Includes A/C)	10' 9"	10' 9"	10' 9"	10' 9"	10' 9"	11'	11' 2"
Interior Height (Coach)	81"	81"	81"	81"	81"	81"	81"
Awning Length	20	18'	18'	18'	18'	18'	20'
Fresh/Grey/Waste Water Capacity (gal.)	49/66/33	49/33/33	49/33/33	49/33/33	49/33/33	49/33/33	49/66/33
Tire Size	ST205/75R14C	ST205/75R14C	ST205/75R14C	ST205/75R14C	ST205/75R14C	ST225/75R15D	ST225/75R15D

*Unloaded vehicle weights do not include options. Please refer to back cover for definitions of chart descriptions.



- ◆ 50% Lighter than wood
- ◆ No rot, mold or water damage
- ◆ R-2 thermal insulation
- ◆ Odorless, no formaldehyde
- ◆ Sound and energy absorbing
- ◆ Impact and puncture resistant
- ◆ Made in USA



DECOR

RUSSET



CHESTNUT

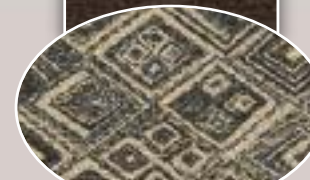

CASHMERE





Find your Freedom!
This large capacity,
open garage is an
outdoor enthusiast's
home base. Shown
in Chestnut decor.

Blast Toy Haulers

Whether you're hauling mini-bikes or motocross, four wheelers or Fat Boys, there's a Freedom Express Toy Hauler for you. The 271BL has a front walk-around queen bed, large bathroom with abundant storage and a 10' open garage to haul all of your toys. The Deep Slide 301BLDS has a 10' enclosed garage with a slider patio door. Both models have raised roof lines and a beavertail ramp transition.

- ◆ Frame Mounted Tie-Down D-Rings In Floor
- ◆ Adjustable High/Low Fresh Air Vents
- ◆ Zippered Roll-up Screen Wall with Privacy Panels at Ramp Door
- ◆ Two Jackknife Sofas In Cargo Area
- ◆ Large Indoor/Outdoor folding Table
- ◆ Raised Roof Line - 90" Interior Cargo Height
- ◆ Beavertail Ramp Transition
- ◆ Sliding Patio Door Between Cargo and Living Areas (301 BLDS Only)
- ◆ Helmet/Gear Storage in Cargo Area
- ◆ Hinge Mounted Spring Assist Ramp Door System
- ◆ Integrated Bar and Latch Locking System on Ramp Door
- ◆ A-Frame Mounted Generator/Storage Rack (N/A on Liberty/Maple Leaf Editions)

OPTIONS

- ◆ Freedom Toy Hauler Party Deck
- ◆ Electric Track Queen Bed

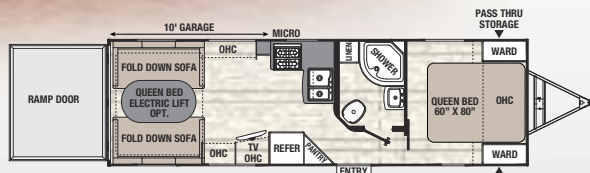

271 BL ◆ Exterior Length 30' 11"

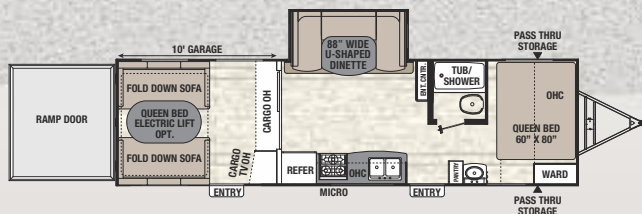

301 BLDS ◆ Exterior Length 33' 7"

271BL has a glass shower, linen storage and an extended counter, plus a private a 60" x 80" walk around bed in the Master bedroom with plenty of storage.

This versatile, lightweight 10' open garage model has a sliding glass door for two separate living areas and is perfect for taking your show on the road.



FREEDOM Express

This multi-purpose fold down sofa can be used on or off of the wall track, and converts to a sleeping area. The 60" x 80" queen overhead bunk shown is optional.



301 BLDS

Freedom Express Blast	271 BL	301 BLDS	301 BLDSLE
UVW*	5,806	6,819	6,993
Hitch Weight	799	901	953
Carrying Capacity	3,194	3,081	2,907
Exterior Length (Bumper to Hitch)	30' 11"	33' 7"	33' 7"
Exterior Height (Includes A/C)	11' 9"	11' 10"	11' 10"
Interior Height (Coach)	90"	90"	90"
Awning Length	20'	18'	18'
Fresh/Grey/Waste Water Capacity (gal.)	98/33/33	98/33/33	98/33/33
Tire Size	ST225/75R15D	ST225/75R15D	ST225/75R15D

*Unloaded vehicle weights do not include options.

Please refer to back cover for definitions of chart descriptions.



301 BLDS



28 SE

This family-friendly model includes easy access, double-over-double bunks, plenty of counter space, solid master bedroom doors for privacy, and two convenient entrances. Kid's have fun climbing to the upper bunk on the Rock Block wall. Shown in Jasmine decor.



Special Edition Packages

Enjoy all the comforts of home! Freedom Express has combined our most popular features to create a selection of value package models. They come complete with private master bedrooms, plenty of additional sleeping areas, seamless kitchen counters, and entertainment towers.

- ◆ Radial Tires with Silver Steel Wheels
- ◆ Spare Tire
- ◆ Black Fenders with Black Skirt Metal
- ◆ Detachable Power Cord
- ◆ Power Awning
- ◆ Solar Port
- ◆ Tinted Safety Glass Windows
- ◆ Front Diamond Plate
- ◆ TV and Radio Antenna with Booster
- ◆ E-Z Lube™ Axles
- ◆ Heated/Enclosed Underbelly
- ◆ 33/33 Gal Grey, Black Holding Tank
- ◆ 49 Gal Fresh Water Tank
- ◆ Two Exterior Speakers
- ◆ AM/FM/Bluetooth Stereo
- ◆ Two Interior Speakers
- ◆ Ducted AC
- ◆ Ducted Furnace
- ◆ 6 Gal DSI Gas/Electric Water Heater
- ◆ LED Interior Lighting
- ◆ Mortise and Tenon Cabinet Door
- ◆ Congoleum Diamond Flooring
- ◆ Night Shades
- ◆ Microwave
- ◆ Oven with 3-Burner Cooktop
- ◆ 6 Cu. Ft. Two-door Refrigerator
- ◆ Silverware Drawer (select models)
- ◆ Double Basin Sink
- ◆ Bath Skylight
- ◆ 60" x 80" Queen Mattress with Decorative Bedspread
- ◆ RVIA

LEISURE PACKAGE (Upgrade)

- ◆ 32" LED TV
 - ◆ Power Tongue Jack
 - ◆ Awning Light
- The value-priced 28.1 SE is loaded with amenities and conveniences.*

OPTIONS

- ◆ 15,000 BTU A/C
- ◆ Canadian Compliance

The Ultimate in Towability



28 SE

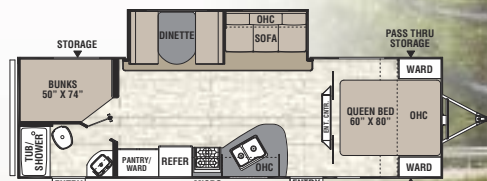

28 SE ♦ Exterior Length 31' 11"

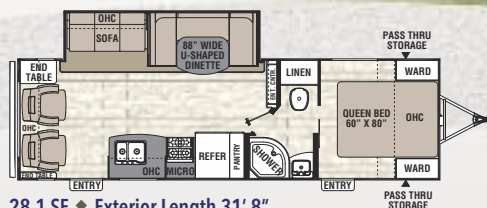

28.1 SE ♦ Exterior Length 31' 8"

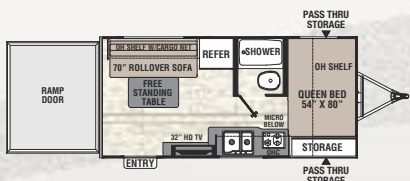

17BL SE ♦ Exterior Length 20' 4"

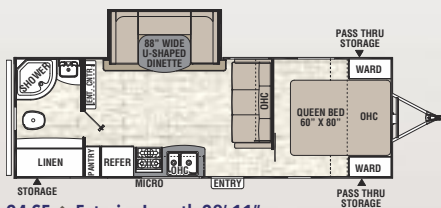

24 SE ♦ Exterior Length 28' 11"

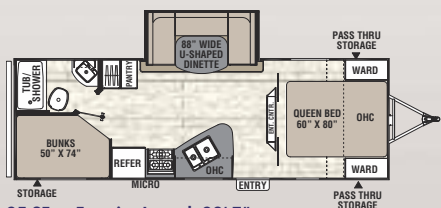

25 SE ♦ Exterior Length 28' 7"

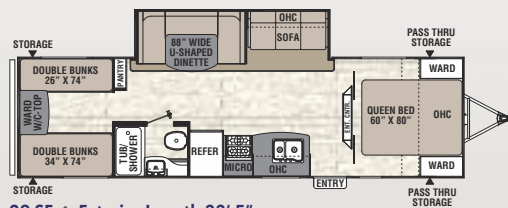

29 SE ♦ Exterior Length 33' 5"

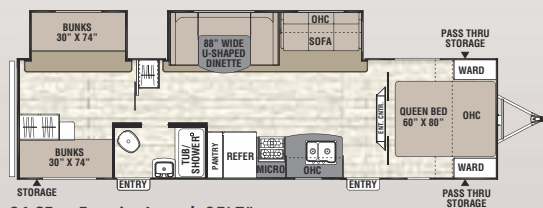

31 SE ♦ Exterior Length 35' 7"



Stable-Ryd® Suspension

- ♦ Spread axle improves weight distribution.
- ♦ Wide track axles provide a wider, more secure stance on the road.
- ♦ Spread axle design allows us to reduce the tongue weight for optimum performance.
- ♦ Spread axle design reduces sway caused by crosswinds.

Lightweight

- ♦ Laminated sidewalls and floor
- ♦ Azdel behind the fiberglass
- ♦ Bow trusses aluminum and wood
- ♦ Rod and angle crossmembers in frame
- ♦ All tanks mounted under floor to lower center of gravity and improve interior storage.

Aerodynamic

- ♦ Aerodynamic front profile (Cuts through the air)
- ♦ Enclosed underbelly reduces turbulence/drag. (Select models)

DECOR

JASMINE



28.1 SE

Freedom Express Special Editions	17BL SE	24 SE	25 SE	28 SE	28.1 SE	29 SE	31 SE
UVW*	3,576	5,088	4,980	5,604	5,699	5,638	6,766
Hitch Weight	426	652	555	585	662	639	704
Carrying Capacity	2,324	2,412	2,520	1,896	1,901	1,962	2,734
Exterior Length	20' 4"	28' 11"	28' 7"	31' 11"	31' 8"	33' 5"	35' 7"
Exterior Height	10' 3"	10' 9"	10' 9"	10' 9"	10' 9"	10' 9"	11'
Interior Height	81"	81"	81"	81"	81"	81"	81"
Awning Length	12'	16'	20'	16'	18'	16'	16'
Fresh/Grey/Waste Water Capacity (gal.)	49/33/33	49/33/33	49/33/33	49/33/33	49/33/33	49/33/33	49/33/33
Tire Size	ST205/75R14C	ST205/75R14C	ST205/75R14C	ST205/75R14C	ST205/75R14C	ST205/75R14C	ST225/75R15D

*Unloaded vehicle weights do not include options. Please refer to back cover for definitions of chart descriptions.



Expandables

Pack all the livability of a 28'-33' travel trailer into the towability (and price) of a 21'-23' trailer. Freedom Express Expandables are easy to tow and come with the Secure-Lok tent system which eliminates the hassle of Velcro or bungsies, making set-up and tear-down a snap - even for one person.



22 TSX

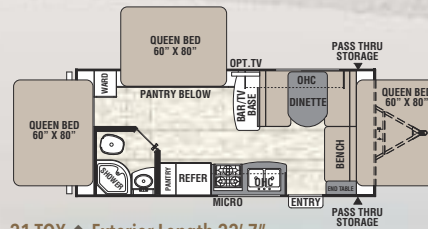

21 TOX ♦ Exterior Length 22' 7"

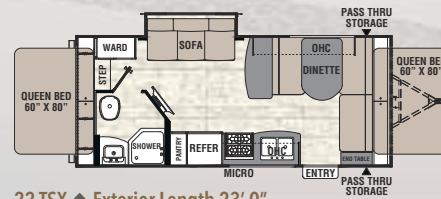

22 TSX ♦ Exterior Length 23' 0"

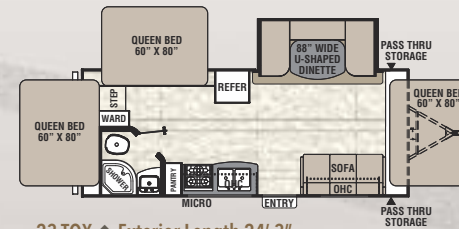

23 TOX ♦ Exterior Length 24' 3"



22 TSX Sleeps up to 10 people with plenty of storage to hold everyone's camping supplies. This spacious expandable has a large living area and kitchen along with a fully enclosed bathroom and two 60" x 80" queen beds. Shown in Russet decor.

Freedom Express Expandables	21 TOX	22 TSX	23 TOX
UVW*	3,650	4,450	4,705
Hitch Weight	430	550	635
Carrying Capacity	2,150	2,550	2,295
Exterior Length (Bumper to Hitch)	22' 7"	23' 0"	24' 3"
Exterior Height (Includes A/C)	10' 3"	10' 9"	10' 9"
Interior Height (Coach)	81"	81"	81"
Awning Length	14'	16'	18'
Fresh/Grey/Waste Water Capacity (gal.)	36/30/30	36/30/30	36/30/30
Tire Size	ST205/75R14C	ST205/75R14C	ST205/75R14C

*Unloaded vehicle weights do not include options. Please refer to back cover for definitions of chart descriptions.

Construction Features



Lightweight Towability and Enhanced Aerodynamics

Freedom Express Ultra-Light travel trailers are ideal for half-ton tow vehicles and optimized fuel efficiency. Designed with fully laminated, aluminum framed walls and floor, Freedom Express travel trailers and hybrid expandables are incredibly lightweight and durable.

1. 3M breathable graphics
2. Tinted, safety glass windows
3. Crowned trusses
4. Aluminum reinforced with 3/8" roof decking
5. Di-Flex II TPO roofing
6. Azdel composite panels
7. Aerodynamic front profile
8. Dual 20 lb. LP gas tanks
9. Welded aluminum structure, vacuum-bonded sidewalls and flooring
10. Smooth exterior fiberglass skin
11. Aluminum framed openings
12. Fully enclosed, heated under belly (25' and above)
13. Fully welded tubular aluminum floor structure
14. Happijac SureTrac™ rack and pinion slide systems
15. Congoleum Designer Carefree Resilient Flooring
16. Powder E-coated, welded I-beam frame
17. Super-Lube® axle hubs
18. Stable-Ryd® spread axle design (25' and above)
19. Nitrogen filled radial tires



- ◆ 50% Lighter than wood
- ◆ No rot, mold or water damage
- ◆ R-2 thermal insulation
- ◆ Odorless, no formaldehyde
- ◆ Sound and energy absorbing
- ◆ Impact and puncture resistant
- ◆ Made in USA

	FE	LE
INTERIOR & DÉCOR		
Independence Maple Hardwood Cabinet Doors and Drawer Faces	X	X
Furniture Grade, Pocket Drilled and Screwed Stile and Rail Cabinet Front Construction	X	X
Full Extension Roller Bearing Drawer Guides	X	X
Designer Hard Valance with Soft sided Window Treatments	X	X
Range Hood with 12V Exhaust and Light	X	X
Sealed/Seamless Countertops	X	X
Brushed Nickel Hardware	X	X
High-Rise Kitchen Faucet	X	X
60/40 Stonecast Composite Kitchen Sink	X	X
Silverware Drawer with Removable Tray (Select Models)	X	X
Jackknife Sofa	X	N/A
Dinette Storage Access Doors	X	X
Accent Wall in Master Bedroom	X	X
Two Full-Length Mirrored Closets in Master, and Over-Bed Cabinets	X	X
Two Nightstands with 110V Outlets (Most models)	X	X
Storage Under Master Bed and Bunks (Select models)	X	X
Wooden Privacy Slider Doors to Master Suite In Place of Curtain or Accordion Door (Most models)	X	X
Entertainment Tower with Rotating TV for Bedroom Viewing (Select models)	X	X
Exhaust Vent with Fan in Bathroom	X	X
Vent in Master Bedroom	X	X
Wood Medicine Cabinet with Bathroom Mirror & Cosmetics Shelf	X	X
Hi Rise Foot Flush Toilet	X	X
Interior Speakers with Selector Switch	X	X
55 Amp Power Converter	X	X

	FE	LE
GFI Receptacles in Bathroom and Kitchen	X	X
LP Leak Alarm	X	X
Fire Extinguisher	X	X
Smoke and Carbon Dioxide Detector	X	X
Multiple Egress Windows with Screen and Prop Rod	X	X
Cable Support Tent Ends - 1000# Capacity (EXP)	EXP	N/A
Frame Mounted Tie-Down D-Rings In Floor	TH	TH
Adjustable High/Low Fresh Air Vents	TH	TH
Zippered Roll-up Screen Wall with Privacy Panels at Ramp Door	TH	TH
Two Jackknife Sofas In Cargo Area	TH	TH
Large Indoor/Outdoor folding Table	TH	TH
Raised Roof Line - 90" Interior Cargo Height	TH	TH
Beavertail Ramp Transition	TH	TH
Sliding Patio Door Between Cargo and Living Areas (301 BLDS Only)	TH	TH
Helmet/Gear Storage in Cargo Area	TH	TH
EXTERIOR		
Dual 20# LP bottles	X	X
LP Bottle Cover w/Valve Access	X	X
60° A-frame	X	X
Dual Battery Rack	X	X
Insulated, Painted Radius Entry Door with Screen Door	X	X
Amber Patio Light	X	X
Nitrogen Filled Radial Tires	X	X
Water Heater Bypass	X	X
Heavy Duty Welded Safety Chains	X	X
Four-Wheel Electric Brakes	X	X

	FE	LE
Breakaway Safety Cable	X	X
Exterior GFI Outlet Near Awning	X	X
High-Capacity Roto-Cast Holding and Fresh Water Tanks	X	X
Hinge Mounted Spring Assist Ramp Door System	TH	TH
Integrated Bar and Latch Locking System on Ramp Door	TH	TH
HappiJac Double Hat Rail, Rack and Pinion 12V Slide System (18" slides)	X	X
LCI Rack and Pinion 12V Slide System with Full Width Welded Ram (38" slides)	X	X
Schwintek Slide System (Some models)	X	X
A-Frame Mounted Generator/Storage Rack (N/A on Liberty/Maple Leaf Editions)	TH	N/A
CONSTRUCTION		
Alumicage Welded Aluminum Structure, Vacuum Bonded Floor and Sidewalls	X	X
Azdel Composite (IPO Iuan behind fiberglass)	X	X
Smooth Fiberglass Exterior Skin	X	X
Aluminum Framed Openings	X	X
Powder E-Coated Steps and Axles	X	X
Floor Plan Specific Cambered Frame Design	X	X
Full Walk-on, Crowned, Aluminum Reinforced Roof with EPDM Membrane over 3/8" Roof Decking	X	X
Double Wiper Seals on All Slideouts	X	X
STANDARD EXTRAS		
Green Certification	X	X
Seal Tech and Rain Bay Testing on Every Unit	X	X
One-Year Free Membership to Coachnet Roadside Assistance	X	X
One-Year Free Membership to Coachmen Owner's Association (C.O.A.)	X	X

FREEDOM *Express*



ULTRA LIGHT TRAVEL TRAILERS
DEEP SLIDES ♦ TOY HAULERS
EXPANDABLES



Find out why Freedom Express has become one of the most demanded ultra light towable RV brands on the market today!

Freedom Express has
Won the Annual DSI
Quality Circle Award!



Coachmen Interactive Mobile Manuals

Download your Coachmen mobile app
or visit our dynamic online manual to

enhance your ownership experience. These interactive options provide incredible ease and insight into use, maintenance and enjoyment of your Coachmen product. Ranging from "How-To" videos, pictures and illustrations of various components, systems and features to fully searchable content and downloadable PDFs for individual component owner's manuals, answers are always just a click away.



423 N. Main Street ♦ P.O. Box 30 ♦ Middlebury, IN 46540

To learn more about Coachmen RV and our products
and see how Coachmen is making the easy life easier,
visit www.coachmenrv.com or call 1.800.353.7383.



Travel Easy™ Roadside Assistance

RVing is easier with Coachmen's Travel Easy™ Roadside Assistance provided FREE the first year of ownership to those who purchase a New Coachmen RV. Administered by Coach-Net, this service provides you with 24/7 operational, technical and emergency road service coverage. Also included is towing, fuel delivery, jump starts, lockout service, tire changes, mobile mechanic and unlimited technical assistance. Anywhere. Anytime. Travel Easy™ is the security of knowing that help is an easy phone call away.



Big benefits for new owners - FREE One Year Membership in the Coachmen Owners Association!

Coachmen is proud to sponsor the largest manufacturer sponsored camping club in North America...Coachmen Owners' Association (COA). COA provides you a world of ways to enjoy your RV. This is FUN ON OVERDRIVE and provides: Free Trip Routing, Exciting Tours & Rallies, Free Campground Directory, Local/State Club Activities, Easy RVing Magazine Free, Theme

Park Discounts, Fuel Discounts, Free onebigplanet® Memberships with discounts at 180,000 merchants and Much More! Every new Coachmen RV buyer is eligible for a 1 Year FREE membership in the Coachmen Owners' Association. It all adds up to an easy ownership experience!



Forest River, Inc. encourages
our customers to purchase
their Forest River products
from a local dealership
whenever possible for the
following reasons:

- 1) Forest River, Inc. dealers are independently owned and operated businesses so priority service and scheduling is at their discretion and is often provided to customers that purchased their unit at that dealership.
- 2) Purchasing locally allows customers to establish meaningful relationships with a dealer, enhancing the RV experience through assistance with product questions, user tips or RV regulations for your state or country, and much more!
- 3) Canadian customers must meet requirements to bring an RV purchased out of the country to their home. These requirements may involve additional inspections and certifications, taxes and fees. Your local Canadian Dealer is a professional at meeting these requirements.
- 4) Scheduling timely warranty repairs and adjustments through a local dealership provides far greater flexibility and convenience to you, the customer!

It is the goal of Forest River, Inc. that all of our RV owners fully enjoy the RV experience and that customer satisfaction meets or exceeds their expectations!

All information contained in this brochure is believed to be accurate at the time of publication. However, during the model year, it may be necessary to make revisions and Forest River, Inc., reserves the right to make all such changes without notice, including prices, colors, materials, equipment and specifications as well as the addition of new models and the discontinuance of models shown in this brochure. Therefore, please consult with your Forest River dealer and confirm the existence of any materials, design or specifications that are material to your purchase decision. ©2016 Freedom Express by Coachmen, a Division of Forest River, Inc., a Berkshire Hathaway company. All Rights Reserved. 3/17



Learn More

Scan this barcode using
a QR Reader on your
smart phone to learn
more about Forest River.



A Berkshire Hathaway company.

GVWR (Gross Vehicle Weight Rating) - is the maximum permissible weight of the unit when fully loaded. It includes all weights, inclusive of all fluids, cargo, optional equipment and accessories. For safety and product performance do NOT exceed the GVWR.

GAWR (Gross Axle Weight Rating) - is the maximum permissible weight, including cargo, fluids, optional equipment and accessories that can be safely supported by a combination of all axles.

UVW (Unloaded Vehicle Weight)* - is the typical weight of the unit as manufactured at the factory. It includes all weight at the unit's axle(s) and tongue or pin and LP Gas. The UVW does not include cargo, fresh potable water, additional optional equipment or dealer installed accessories.

CCC (Cargo Carrying Capacity)** - is the amount of weight available for fresh potable water, cargo, additional optional equipment and accessories. CCC is equal to GVWR minus UVW. Available CCC should accommodate fresh potable water (8.3 lbs. per gallon). Before filling the fresh water tank, empty the black and gray tanks to provide for more cargo capacity.

*Estimated Average based on standard build optional equipment.

** Estimated average based on standard build optional equipment.

Each Forest River RV is weighed at the manufacturing facility prior to shipping. A label identifying the unloaded vehicle weight of the actual unit and the cargo carrying capacity is applied to every Forest River RV prior to leaving our facilities.

The load capacity of your unit is designated by weight, not by volume, so you cannot necessarily use all available space when loading your unit.