

*Cakmont*

Get lost in the moment!



Visit HEARTLAND on:



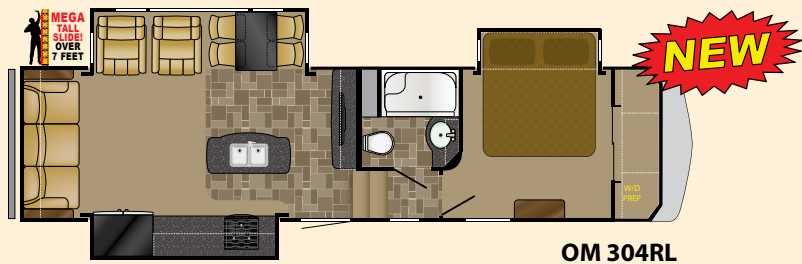

OM 304RL

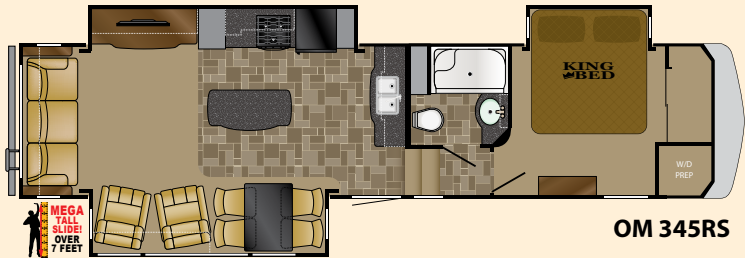

OM 345RS

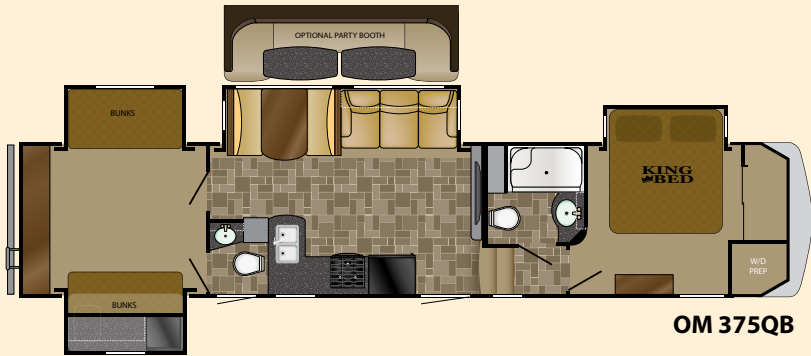

OM 375QB

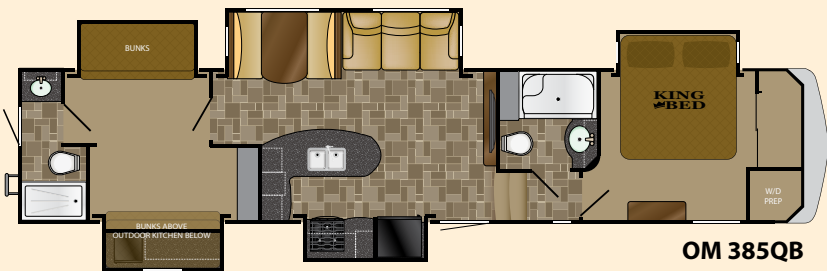

OM 385QB

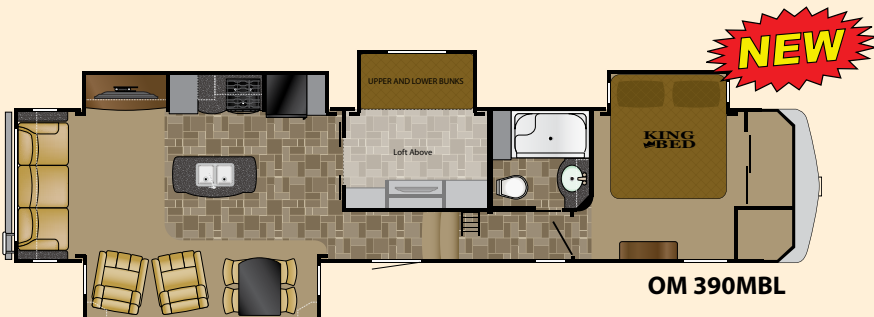

OM 390MBL

### Traveling in Style Package

- Painted fiberglass front cap / Tight Turn Technology
- ABS hitch cover
- High gloss exterior side walls
- Premium upgraded graphics package
- Dexter axles with EZ-Flex suspension and Nev-R-Adjust brakes
- Correct Track axle alignment system
- 16" aluminum automotive style wheels
- Spare tire and carrier
- Hydraulic front landing gear
- Electric rear stabilizer jacks
- Rear ladder
- Power awning with LED light strip
- Outside kitchen (bunk models only)

- Flip & fold sleeper sofa
- 50" LED TV (most models) and through sound entertainment center
- Residential cold crack resistant Beauflor
- Central vacuum system
- Recessed LED lighting
- Ceiling fan
- 15,000 BTU ducted AC system
- One-piece fiberglass shower with glass surround (most models)
- Porcelain commode with foot flush
- King bed pillow top mattress
- Stackable washer dryer prep (most models)

### Camping in Style Package

- Glazed heritage mocha hardwood cabinetry
- Hidden hinges
- Full extension roller bearing drawer glides
- 1.6 cu ft stainless steel residential microwave
- 16 cu ft residential refrigerator
- 22" oven
- Three burner cooktop
- Tempered glass stove cover
- Free standing dinette table and four chairs (two folding) (booth dinette is standard in bunk models)
- Two residential recliners with power massage (most models)

### Options

- Generator prep
- Six point hydraulic auto leveling system
- 12 cu ft gas/electric refrigerator option
- Mega party booth
- Power theater seating
- Flip and fold sofa in place of bottom bunk (375QB & 385QB)
- 32" bedroom TV
- 32" bunk room TV
- Queen bed with nightstands
- Electric fireplace
- 13.5 ducted 2nd bedroom A/C
- Dual pane windows

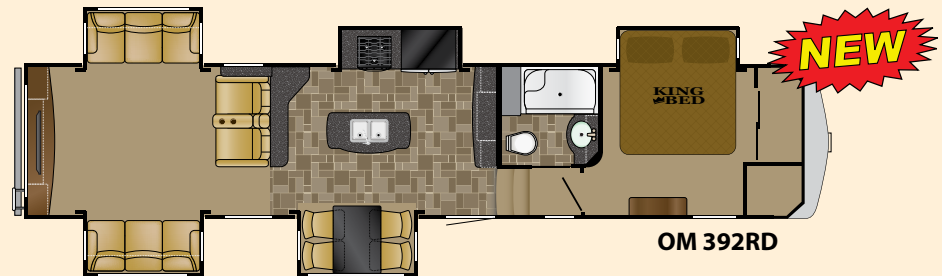

OM 392RD

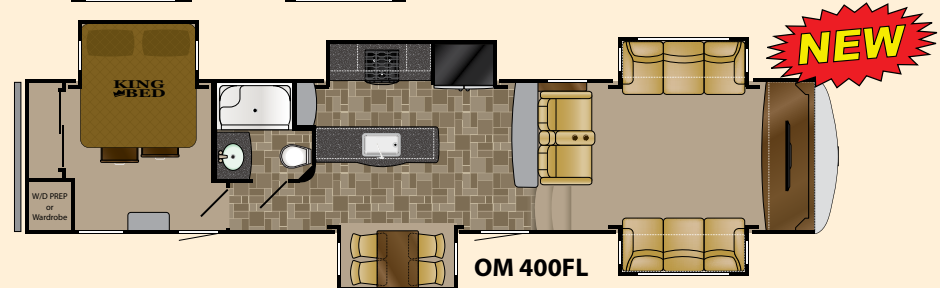

OM 400FL



| MODEL    | 304RL       | 345RS       | 375QB       | 385QB        | 390MBL      | 392RD       | 400FL       |
|----------|-------------|-------------|-------------|--------------|-------------|-------------|-------------|
| LENGTH   | 34' 11"     | 37' 6"      | 41' 3"      | 41' 8"       | 42' 3"      | 42' 1"      | 42' 11"     |
| DRY      | 10,985      | 12,030      | 13,975      | 13,990       | 13,576      | 13,268      | 13,207      |
| HITCH    | 2,275       | 2,120       | 2,290       | 2,520        | 2,580       | 2,500       | 2,905       |
| HEIGHT   | 12' 11"     | 12' 11"     | 12' 11"     | 12' 11"      | 12' 11"     | 12' 11"     | 12' 11"     |
| CAPACITY | 59° 80° 40° | 59° 80° 40° | 59° 80° 80° | 59° 120° 80° | 59° 80° 40° | 59° 80° 40° | 59° 80° 40° |

Model 400 FL





*Model 390 MBL - Shown in Amarillo*

## *Comfortable Living*

The Oakmont collection of distinctive fifth wheels offers comfortable accommodations with luxurious touches only found in more expensive RVs. Some Oakmonts put the emphasis on family, others provide a more private getaway for couples. Whatever you prefer, all Oakmonts share in common: a quality built, smart design that enhances each and every trip you take. Oakmont is truly taking affordable luxury to the next level with hardwood cabinets, contemporary brushed metal hardware, LED lighting, magnificent furnishings, comfortable residential styled furniture, entertainment centers and an abundance of interior and exterior storage space.



*Santa Fe Decor*



*Cambridge Decor*

# Bed, Bunk and Bath



Model 390 MBL  
Shown with standard King bed  
Queen bed with night stands option available



Oakmont bedroom suites all feature King beds and huge front closets that are prepped to install a stacking washer/dryer.



Model 400 FL  
One Piece Fiberglass Mega Shower



The high boy dresser gives you more storage without taking up precious floor space and allows for a huge vertical egress window in your bedroom. Oakmont is prepped for installation of an optional 32" bedroom TV available in all models.



Seven foot tall Mega-slide room

# Special Features



Enormous Mega-Slides equipped with hydraulic slide mechanisms offer the quickest and smoothest operation of even the largest Oakmont slide rooms.



Residential couches with power massage



Built-in central vacuum system



Oakmont features family friendly models where the kids have their own place, sleeping arrangements for the whole family and even a few guests.



Get more out of your patio with an outdoor camp kitchen party center. Available on three Oakmont models featuring a sink, refrigerator, LP two burner stove, storage and workspace.



A large power awning with LED light strip is standard on all models. Its like having that perfect shade tree with you at all times.



Oakmont is equipped with the convenient control center that brings most of the system controls and gauges to one central location.



The Universal Docking Center (U.D.C.) brings all the coach hook-ups and holding tank valve pulls to one central lockable location for quick, easy and secured hookup.



DEXTER AXLE

Standard on every Oakmont are 16" aluminum wheels, E rated radial tires and Dexter E-Z Flex suspension system providing an incredibly smooth ride.

### Optional Six Point Hydraulic Auto Leveling

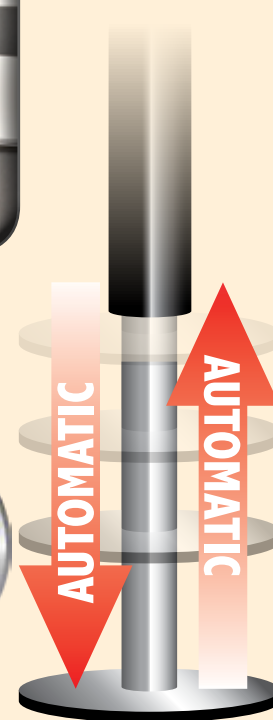



Heartland Recreational Vehicles  
 2831 Dexter Drive • Elkhart, IN 46514 • 574-262-5992

**Community. Convenience. Close-to-home.**

Where you purchase your recreational vehicle is ultimately your decision but Heartland urges you to consider buying at your local dealer. Dealers are part of your community, providing jobs and contributing to your local economy. These dealers are under obligation to provide warranty service for products they sell, but are not legally required to service products purchased from other dealers. At some point, you may need to return to the dealer you buy from - why not stay close to home? After all, home is where your Heartland is!

**BENEFITS OF PURCHASING YOUR RV LOCALLY:**

- You enjoy valuable relationship building with Dealer Representatives, close to your home, who will explain the features and benefits of the product.
- You receive a full product orientation prior to delivery, which includes hands-on directions for many of the coach's systems and functions. You are also introduced to the Dealership's Service/Parts/Warranty personnel who are at the ready to help you with any issues you may encounter, now and in the future.
- You enjoy customer PRIORITY. Dealerships generally service their purchasing customers first - others may experience long delays and miss opportunities to use their RV. What is it worth for you to have a dealership's full attention and motivation to satisfy you when you need service - in a timely manner?
- Valuable TAX dollars and jobs stay in YOUR community which pays for your roads, schools, police and fire departments.

**DON'T UNDERESTIMATE CUSTOMER SERVICE AND PERSONAL CARE!**

For Canadian Residents: If you purchase an RV out-of-country, there are additional fees, taxes and inspections that must be met before bringing your product home. Your local Canadian dealers are experts in these provisions.

Visit HEARTLAND on:



Your Authorized Heartland Dealer:

HEARTLAND PROUDLY PARTNERS WITH THE HIGHEST QUALITY VENDORS in manufacturing our recreational vehicles:

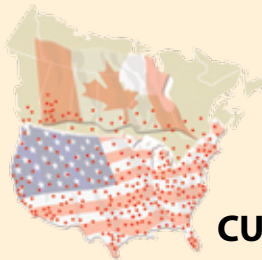

**HEARTLAND CUSTOMER SERVICE WE'VE GOT YOUR BACK!**

Over 40 men and women located in a dedicated facility servicing our customers every day. With a dealer network of over 400 locations across the U.S. and Canada, you're never far from an authorized Heartland dealer.

[www.HEARTLANDRVs.com](http://www.HEARTLANDRVs.com)

**Experience:**  
 Product Walk-Through Videos  
 Side By Side Comparisons  
 Feature Videos • Photo Galleries  
 Virtual 360° Tours  
 Detailed Floor Plans  
 News • Testimonials  
 Dealer Locator • Owners Club  
 Customer Service • Service Locator  
 and More at our Informative Web Site

[www.heartlandrvs.com](http://www.heartlandrvs.com)  
 FOR ADDITIONAL INFORMATION

Product information is as accurate as possible as of the date of publication of this brochure. Due to Heartland's commitment to continuous product improvement - floorplans, materials, components, features, measurements, specifications, options, etc. are subject to change at any time without notice or obligation. In certain conditions some additional equipment may be needed. Photos may show optional equipment or props used for photography purposes only.

Heartland has listed the approximate base weight of the trailer without the option equipment included. Option equipment will impact the weight of the trailer. Please locate the weight sticker attached to the trailer you are considering for the most accurate trailer weight.

Tow Vehicle Caution: Owners of Heartland recreational vehicles are solely responsible for the selection and proper use of tow vehicles. All customers should consult with a motor vehicle manufacturer or their dealer concerning the purchase and use of suitable tow vehicles for Heartland products. Heartland disclaims any liability or damages suffered as a result of the selection, operation, use or misuse of a tow vehicle. Heartland's limited warranty does not cover damage to the recreational vehicle or the tow vehicle as a result of the selection of the tow vehicle.