

Jayco | Jay Feather Travel Trailer

JAY FEATHER

ADVENTURE IS CALLING



2+3
YEAR | YEAR
WARRANTY

INTERIOR DESIGN



VINTAGE WASHED GREY



Wood



Floor

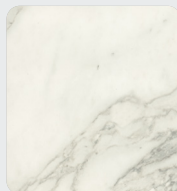

Countertop

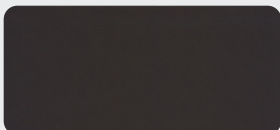

Main Fabric

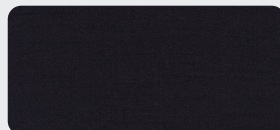

Accent Fabric

MODERN FARMHOUSE

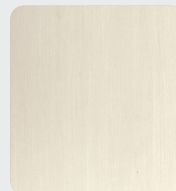

Wood

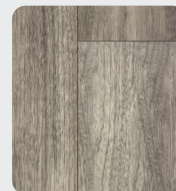

Floor

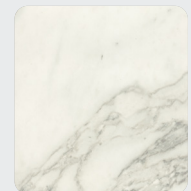

Countertop

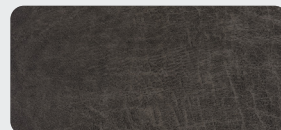

Main Fabric

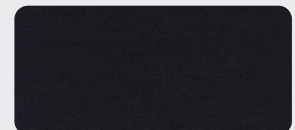

Accent Fabric



JAY FEATHER

X213



20MBH

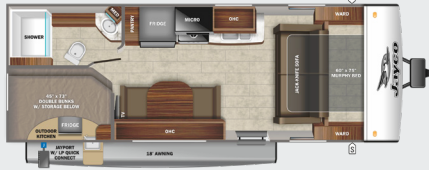

21MML



22BH



22RB

OPTIONS: B, C



24BH

OPTIONS: B, C

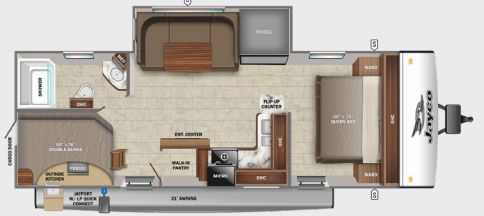

24RL

OPTIONS: A, B



25RB

OPTIONS: A, B



26RL

OPTIONS: A



27BHB

OPTIONS: A, B



30QB

OPTIONS: B, C

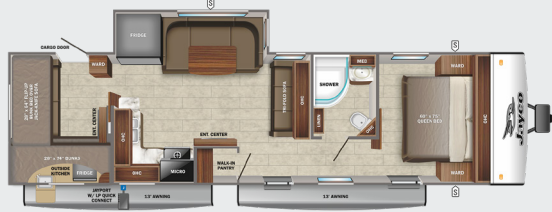

-  STORAGE
-  MICRO MICROWAVE
-  OHC OVERHEAD CABINETS
-  FRIDGE REFRIGERATOR
-  WARD WARDROBE

OPTIONS

A



Tri-Fold Sofa

B



Theater Seat

C



L-Lounge

STANDARDS & OPTIONS

EXTERIOR

Aerodynamic, rounded front profile with diamond plate
Modern retro graphics package with two-colored sidewall
Stronghold VBL™ vacuum-bonded, laminated side and rear walls (including slideout room walls)
Azdel laminated interior and exterior walls
2 in. vacuum-bonded floor with 2 lb. foam insulation
Keyed-Alike™ lock system
Magnum Truss™ Roof System with one-piece seamless roof material with 20 year warranty
American-made frame with integrated A-frame
Dual axles
G20 tinted safety-glass windows
Marine-grade exterior speakers with blue LED accent lighting (2)
Galvanized steel and impact-resistant wheel wells
30-amp service
Outside grill propane quick-connect port
Aluminum tread entry steps (MORryde® StepAbove™ standard on 22RB, 24BH & 25RB)
Outside camp kitchen (standard on select models)
Battery quick disconnect
Slide topper prep (select models with slide rooms)
Exterior TV bracket with 120V electric and cable outlets

INTERIOR

Choice of two interior design packages- Modern Farmhouse or Vintage Washed Grey
LED lighting throughout
Smoked glass decorative inserts (select overhead cabinets)
Screwed and glued cabinetry
Residential vinyl flooring with cold crack resistance
Plywood dinette, bunk and bed bases (applicable models)
Ball-bearing drawer guides with 75 lb. capacity
6 cu. ft. gas/electric refrigerator

Residential oven with 3-burner recessed cooktop and glass cover
Residential-style kitchen countertops
Microwave
Decorative backsplash
4 in. high-density dinette cushions with vinyl backing
Jayco exclusive Teddy Bear “soft-touch” residential-style bed mats (select models)
120V outlet and cargo net in fixed bunks
Plastic foot flush toilet
Bath skylight and roof vent
Wood panel fridge inserts

CUSTOMER VALUE PACKAGE (MANDATORY)

American-made nitro-filled Goodyear® radial tires with self-adjusting electric brakes
Aluminum rims
20 lb. propane bottles with auto regulator (2)
14,500 BTU A/C
Spare tire
Detachable power cord
Power awning with LED lights
Black tank flush
Outside shower
Power tongue jack
Manual stabilizer jacks (4)
6 gal. gas/electric DSI water heater
55 gal. fresh water tank
AM/FM/Bluetooth® stereo
Side-marker camera prep
Rear camera backup prep
360° Siphon® roof vent cap
Inverter pre-wire

SPORT PACKAGE (MANDATORY)

Aluminum tread entry steps
Enhanced graphics package
Front molded fiberglass cap
JaySMART™ (Safety Markers And Reverse Travel) LED lighting (patent-pending)
Roof-mount solar prep
Glacier Package includes enclosed underbelly
32 in. or 40 in. LED TV
Drying rack/sink cover
Power roof vent (main living area)

OPTIONS

120V heated tank pads
50-amp service with 2nd A/C prep (select models)
30 lb. propane bottles with auto regulator (2) (select models)
MORryde® StepAbove™ entry steps on main entrance (standard 22RB, 24BH & 25RB)
8 cu. ft. 12V refrigerator
New JAYCOMMAND® “Smart RV” system (includes TPMS)
Tri-fold sofa with table trays (select models)
Theater seating (select models)
L-lounger sofa in place of U-dinette (22RB, 24BH & 30QB)
Solar Power Package with 190W roof-mounted solar panel
Outside griddle for JayPort system (standard on models with an outside kitchen)

*Indicates split tanks

FLOORPLAN	EXTERIOR TRAVEL LENGTH	EXTERIOR WIDTH	EXTERIOR HEIGHT (WITH A/C)	INTERIOR HEIGHT	UNLOADED VEHICLE WEIGHT	DRY HITCH WEIGHT	GVWR	CARGO CARRYING CAPACITY	FRESH WATER CAPACITY (INCLUDING WATER HEATER)	GRAY WASTE WATER CAPACITY	BLACK WASTE WATER CAPACITY	SLEEPING CAPACITY
X213	24' 2"	8' 0"	10' 3"	6' 6"	4,625	495	5,500	875	61	30.5	22.5	6-9
20MBH	TBD	TBD	TBD	TBD	TBD	TBD	TBD	TBD	TBD	TBD	TBD	4-6
21MML	TBD	TBD	TBD	TBD	TBD	TBD	TBD	TBD	TBD	TBD	TBD	3-4
22BH	TBD	TBD	TBD	TBD	TBD	TBD	TBD	TBD	TBD	TBD	TBD	5-7
22RB	27' 9"	8' 0"	10' 8"	6' 6"	5,655	660	6,750	1,155	61	20.5	22.5	2-3
24BH	30' 2"	8' 0"	10' 9"	6' 6"	6,080	695	7,500	1,420	61	61*	30.5	6-8
24RL	28' 7"	8' 0"	10' 8"	6' 6"	5,360	650	6,500	1,140	61	30.5	30.5	4-6
25RB	30' 8"	8' 0"	10' 8"	6' 6"	5,825	660	7,250	1,425	61	53*	22.5	4-6
26RL	TBD	TBD	TBD	TBD	TBD	TBD	TBD	TBD	61	TBD	TBD	4-5
27BHB	33' 2"	8' 0"	10' 9"	6' 6"	6,370	745	7,600	1,230	61	61*	30.5	8-9
30QB	37' 0"	8' 0"	10' 11"	6' 6"	7,295	835	8,500	1,205	48	61*	30.5	7-10

Meet your Jayco Dealer



Scan QR code for specification definitions

Some specs at the time of print may include estimates. For the most updated information, please visit Jayco.com/jay-feather

Jayco, Inc. | P.O. Box 460 | Middlebury, IN 46540

See dealer for further information and prices. All information in this brochure and on www.jayco.com is the latest available at the time of publication approval. Jayco reserves the right to make changes and to discontinue models without notice or obligation. Photography may show optional equipment or props used for decoration purposes only. RVs built for sale in Canada may differ to conform to Canadian codes. JAYCO and the JAYCO BIRD IN FLIGHT are registered trademarks of Jayco, Inc. Printed in USA 11/21 ©2021 Jayco, Inc. 257074



Jayco - Part of the Jayco Family of Companies