

**STARCRAFT**  
THE FUTURE OF CAMPING | pure and simple.

**AR-ONE** 7' & 8' WIDE ENTRY-LEVEL TRAVEL TRAILERS

# AR-ONE

TAKES YOU TO OTHER WORLDS OF VALUE AND ENJOYMENT.





Model 18QB shown.

### JUST LIKE HOME.

They may be light weight, but not light on styling and comfort. AR-ONE MAXX models provide 81" interior ceiling height, upgraded furniture quality, Honey-glazed Cherry wood cabinetry, many floorplan options and much more!



Model 27BHS shown.

### THEY'RE FOR EVERYONE.

If this is your first family travel trailer or if you're a seasoned RVer looking for a simpler camping unit, AR-ONE MAXX delivers what you need in lasting value. These easy to tow trailers are packed with quality construction features like 5/8" tongue-and-groove plywood floor, structural steel I-beam frame, screwed together (not stapled) cabinet stiles, 48-gallon fresh water capacity, dark tinted safety glass windows, and many more. They are also value priced, backed by Starcraft's industry-leading 2-year warranty, and many models can be towed by mid-sized SUVs and minivans.

# UFO

UNBELIEVABLE FEATURES & OPTIONS.



## ELECTRIC AWNING.

This power awning operates at the touch of a button. It is just one of the many standard upgrades as part of our Show Stopper package. See page 5 for more details.



## UPGRADED SINK.

The AR-ONE models come with a large sink with high rise kitchen faucet as standard. The sink cover pictured is also part of the Show Stopper package (MAXX series).



## MANY FLOORPLANS.

Starcraft has always offered a variety of living configurations. These double bunks are available on 26BH and 27BHS models. Rated for 600 lbs., most competition's are 250 lb.



## STABILIZER JACKS.

Scissor-style stabilizer jacks are bolted in place (not screwed on like the competition) and available on AR-ONE MAXX series. They are located at the unit's front and rear.



## QUALITY OVEN.

A convenient three-burner, brand-name gas oven is optional. AR-ONE models feature an auto changeover LP regulator for LP bottles as standard equipment (MAXX series).



## OUTSIDE SHOWER.

This lockable, outside shower compartment is another great feature available on the MAXX series. Hot and cold water and a shower wand with adjustable head is standard.

## SPACE AGE CONSTRUCTION FEATURES.

For over 50 years Starcraft RV's reputation has been built around top-quality products. Each is designed to provide years of trouble-free use. Backed by a 2-year limited warranty, our innovation and quality start with a solid foundation. Compare and you'll see just how much care and meticulous attention to "doing it right" goes into every Starcraft.



SEE THE FULL COMPARISON ONLINE AT [STARCRAFTCAMPING.COM](http://STARCRAFTCAMPING.COM)



**US** 4,500 lbs. on a Starcraft roof!



**THEM** Same weight on a competitor's style roof.



**US** Vertical wood studs for added support.



**THEM** Little aluminum brace, if that.

## STRONGEST ROOF EVER!

Strength is one of the basic principles of engineering: the stronger something is built, the longer it will last. At Starcraft, we understand strength comes from within, which is why we focused on the smallest of details when constructing our exclusive Magnum Roof System. From sturdier vertical studs to 7" header beams, we pride ourselves on staying at the top of our game—building stronger products that last.



**US** We use large oversized nail plates on both sides.



**THEM** They use smaller and only on one side of truss.



Our optional Climate Package extends your camping season and provides protection against frigid temperatures with its insulated, heated and enclosed underbelly.

## DURABLE CONSTRUCTION

A firm foundation is built on 2"x3" floor joists with 5/8" tongue-and-groove plywood. The walls provide a long-lasting structure with 2"x2" wooden studs on 16" centers and .024 aluminum exterior siding. A one-piece seamless rubber roof membrane covers 4-1/2" arched trusses while 3/8" decking adds protection from the elements.

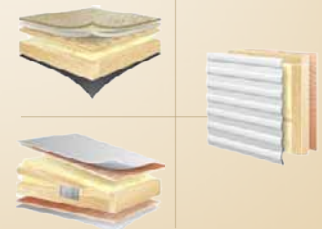

# AR-ONE MAXX 8' WIDE TRAILERS



Model 30BHU shown.



Model 30BHU shown.



Model 30BHU shown.



Model 27BHS shown.



## STARMAXX™ PASS-THRU STORAGE SYSTEM.

AR-ONE MAXX series models are available with this optional front storage compartment we call StarMAXX Pass-Thru. It's a large, integrated pass-through storage with many exclusive features like bolted tie-downs, a convenient battery disconnect, durable rubber floor, unique Toy-Loc security device and more!



## STANDARDS & OPTIONS

### POPULAR STANDARDS

- 5/8" tongue-and-groove plywood main floor decking
- Crowned truss roof rafters on 16" centers with 3/8" WALK ON decking
- Magnum Roof System is 50% stronger
- 48-gallon fresh water capacity
- 13,500-BTU A/C
- Cable TV prep
- Digital antenna (TV/FM)
- Galvanized steel wheel wells
- Solar Prep
- Three-toned exterior metal
- 6 cu./ft. flush-mount refrigerator
- 6.5" interior speakers
- Ball-bearing drawer guides, 50-lb. capacity with full-drawer extension
- High-rise kitchen faucet
- Honey glazed cherry wood cabinetry

- Ultra Plush Denver Mattress™ bunk mats
- Double-over-Double bunk bed with 600-lb. bunk capacities (on 26BH and 27BHS)
- LED interior lighting package (select models)

### SHOW STOPPER PACKAGE (MANDATORY)

- Electric awning
- Front and rear stabilizer jacks
- 30-lb. propane bottles with cover (2)
- Electric tongue jack
- Exterior speakers (2)
- Outside shower
- Sink covers

### POPULAR OPTIONS

- 28" LED TV
- 80-watt portable solar kit
- Aluminum rims

- Climate Package: Insulated, heated and enclosed underbelly; foil insulation in roof
- Décor Upgrade Package: Decorative dinette light (select models), jackknife sofa, kitchen backsplash and valances with lambrequin legs
- Décor Upgrade Package w/tri-fold hide-a-bed sofa ILO sofa bench (on 25BHS, 27BHS and 30BHU)
- Denver Mattress™
- Ducted 13,500-BTU A/C (on 21FB, 25BHS and 26BH)
- Ducted 15,000-BTU A/C
- Oven with 3-burner cooktop
- Spare tire with carrier and cover
- StarMAXX Pass-Thru storage system
- Tri-fold hide-a-bed sofa ILO sofa bench (25BHS, 27BHS, 30BHU)

## AR-ONE MAXX SERIES (8' WIDE)

This popular travel trailer series gives you maximum variety along with outstanding standard features uncommon in this price-point. A three-burner range, optional high-rise sink faucet, 5/8" plywood tongue-and-groove flooring, 48-gallon fresh water, StarMAXX Pass-Thru storage and much more are yours when you choose one of these MAXX series floorplans.

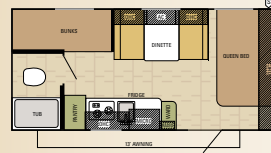

19BH LE\* | AR-ONE MAXX

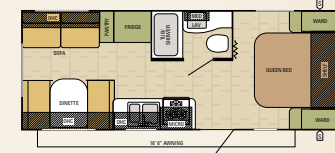

21FB | AR-ONE MAXX

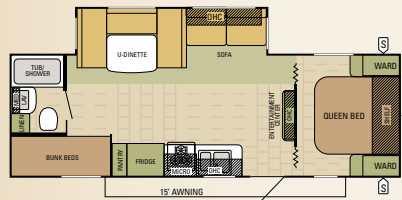

25BHS | AR-ONE MAXX

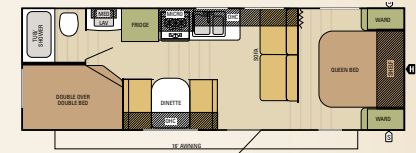

26BH | AR-ONE MAXX

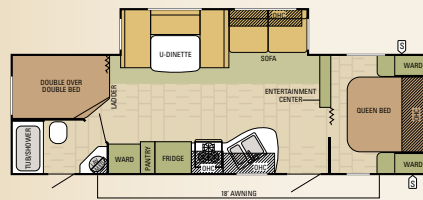

27BHS | AR-ONE MAXX

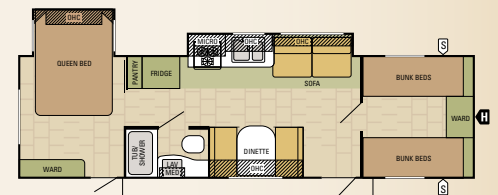

28FBS | AR-ONE MAXX

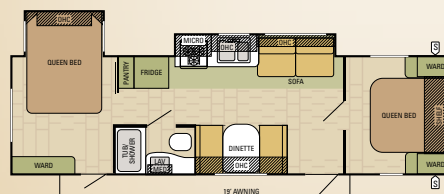

28QBS | AR-ONE MAXX

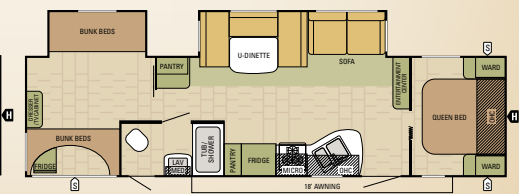

30BHU | AR-ONE MAXX

FOR FULL OPTIONS AND STANDARD FEATURES GO TO [starcraftcamping.com](http://starcraftcamping.com)

## AR-ONE MAXX SPECIFICATIONS

SPECIFICATIONS	19BH LE*	21FB	25BHS	26BH	27BHS	28FBS	28QBS	30BHU
Unloaded Vehicle Weight (lbs)	3265	3880	5200	4280	6000	6320	6120	7170
Dry Hitch Weight (lbs)	400	490	685	500	700	635	615	895
Gross Vehicle Weight Rating (lbs)	4400	6000	7500	6500	8500	8500	8500	9950
Cargo Carrying Capacity (lbs)	1135	2120	2300	2220	2500	2180	2380	2780
Exterior Length	22' 2"	25' 7"	29' 9"	29' 4"	31' 9"	33' 10"	33' 10"	36' 2"
Exterior Width	96"	96"	96"	96"	96"	96"	96"	96"
Exterior Height with A/C	126"	126"	132"	126"	135 - 1/4"	135"	135"	134"
Interior Height (bedroom)	81"	81"	81"	81"	81"	81"	81"	81"
Wheel Base	171 - 1/8"	204 - 3/8"	235 - 9/16"	230"	241 - 3/4"	257 - 1/4"	259 - 1/4"	282 - 3/8"
Fresh Water Capacity (gals)**	48	48	48	48	48	48	48	48
Gray Wastewater Capacity (gals)	32 - 1/2	32 - 1/2	32 - 1/2	32 - 1/2	32 - 1/2	32 - 1/2	32 - 1/2	32 - 1/2
Black Wastewater Capacity (gals)	32 - 1/2	32 - 1/2	32 - 1/2	32 - 1/2	32 - 1/2	32 - 1/2	32 - 1/2	32 - 1/2
Sleeping Capacity	5-6	4	6-8	8-10	8-10	8-10	6-8	8-10

The weights of certain options and/or option packages are not included in the UVW listed above. See weight information details on the back of this brochure.

\* Limited Edition model  
\*\* Includes Water Heater

# AR-ONE 7' WIDE TRAILERS



Model 18QB shown.



Model 15RB shown.



Model 18QB shown.



Model 15RB shown.

## EXTREME PACKAGE.

The Extreme Package option (pictured left) includes 15" off-road mud tires, 5" extra ground clearance, enclosed underbelly, 6-sided Flex-Foil insulation, double-entry step, upgraded graphics and more. This package is a rugged equipment upgrade for those chasing high adventure!

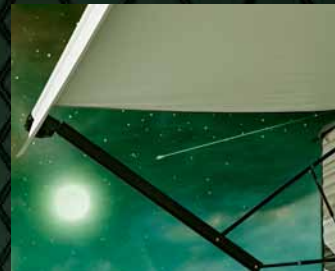

## ELECTRIC AWNING.

At the push of a button, this standard electric awning opens and retracts. It is one of many upgraded features of the mandatory Show Stopper package. Compare to other brands in this price point.

## STANDARDS & OPTIONS

### POPULAR STANDARDS

- Cable support bunk-end system (1,100 lb. capacity, 15RB and 18FB)
- Crowned truss roof rafters on 16" centers with 3/8" WALK ON decking
- Magnum Roof System is 50% stronger than others
- 5,000-BTU A/C (on 14RB, 15RB and 16BH)
- 8,000-BTU A/C (on 17RD, 18FB)
- AquaShield Aqualon water-repellent sectionalized tent with 7-year warranty (on 15RB and 18FB)
- Bunk-end tent permanently attached to bed base (on 15RB and 18FB)

- Cable TV prep
- Digital antenna (TV/FM)
- Galvanized steel wheel wells
- Solar Prep
- Spare tire with carrier
- Three-toned exterior metal
- 3 cu.ft. gas/electric refrigerator
- 6.5" interior speakers
- Honey glazed cherry wood cabinetry
- LED interior lighting package (select models)
- Denver Mattress™

### SHOW STOPPER PACKAGE (MANDATORY)

- Electric awning
- Front/rear stabilizer jacks

- Heated bunk mats (on 15RB and 18FB)
- Ultra Plush Denver Mattress™ bunk mat (on 15RB and 18FB)
- Spare tire cover

### POPULAR OPTIONS

- 80-watt portable solar kit
- 13,500-BTU A/C ILO 5,000 or 8,000-BTU A/C
- Aluminum rims
- Extreme Package: 5" extra ground clearance, 6-sided Flex-Foil insulation, 15" off-road mud tires, double entrance step, enclosed underbelly, fender flair and special graphics

FOR FULL OPTIONS AND STANDARD FEATURES GO TO [starcraftcamping.com](http://starcraftcamping.com)

## AR-ONE SPECIFICATIONS

SPECIFICATIONS	14RB	15RB	16BH	17RD	18FB	18QB
Unloaded Vehicle Weight (lbs)	2390	2550	2560	2865	2975	2885
Dry Hitch Weight (lbs)	255	220	335	305	325	335
Gross Vehicle Weight Rating (lbs)	3200	3200	3500	3500	3750	3750
Cargo Carrying Capacity (lbs)	810	650	940	635	775	865
Exterior Length	16' 6"	17' 6"	17' 10"	20' 6"	21' 6"	21' 8"
Exterior Width	85"	85"	85"	85"	85"	85"
Exterior Height with A/C	110 - 1/4"	112"	112"	112"	112"	111"
Interior Height (bedroom)	73"	73"	73"	73"	73"	73"
Wheel Base	135"	138 - 1/8"	145 - 1/2"	164 - 5/8"	173"	173 - 3/4"
Fresh Water Capacity (gals)	26	26	26	20	20	26
Gray Wastewater Capacity (gals)	15	15	15	15	15	15
Black Wastewater Capacity (gals)	9	9	9	9	9	9
Sleeping Capacity	2-3	4-5	3-4	3-4	5-6	3

The weights of certain options and/or option packages are not included in the UWW listed above. See weight information details on the back of this brochure.

## AR-ONE (7' WIDE)

The standard AR-ONE models in this stellar lineup are among the lightest, easiest to tow travel trailers available today. They're value-packed with quality features like standard stabilizer jacks, dark-tinted safety glass, hardwood cabinet doors, Magnum Roof system, A/C unit and more. The 15RB and 18FB models come with our exclusive tent material called Aqualon. With a 7-year tent warranty, our mold resistant, double-stitched AquaShield Aqualon material doesn't stretch, shrink or crack, and provides long-lasting durability even when it's up against severe elements.

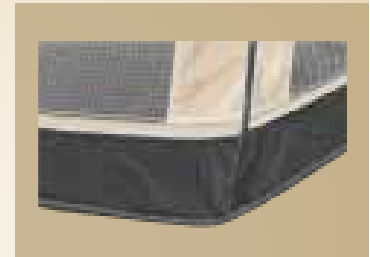

AquaShield Aqualon tent shown.

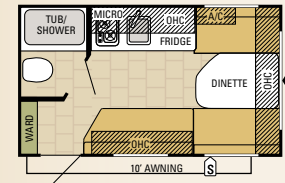

14RB | AR-ONE

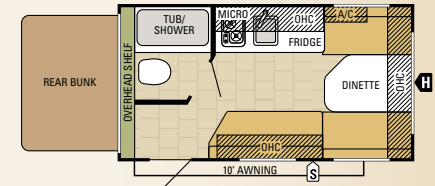

15RB | AR-ONE

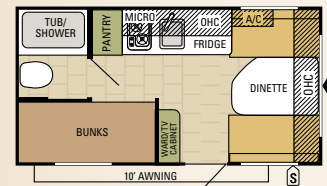

16BH | AR-ONE

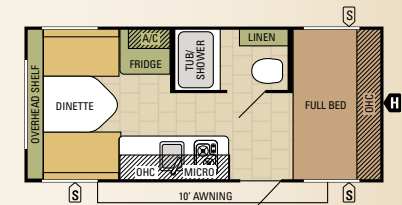

17RD | AR-ONE

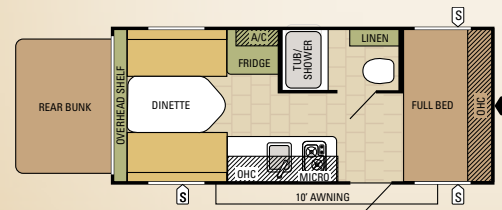

18FB | AR-ONE

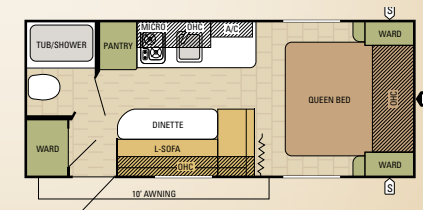

18QB | AR-ONE

## AR-ONE. THE FUTURE OF CAMPING JUST GOT BRIGHTER!



**LANDED IN 1964.** Starcraft is one of the oldest and most respected names in the RV industry. In fact, we've been around since 1903. Back then, we made our name building livestock tanks and other metal farm equipment. In the 1920's, we added a variety of boats to our product lineup. And in 1964, we entered—and revolutionized—the modern camping industry.



### UNHEARD OF 2-YEAR WARRANTY.

The Starcraft warranty is a manufacturer's limited warranty. Each Starcraft is warranted to the original purchaser for 24 months from the original date of purchase against defects in materials and workmanship. For a copy of the limited warranty with full terms and conditions, ask your local Starcraft RV dealer.

## eco advantage™

**SAVING THE PLANET.** The Starcraft EcoAdvantage™ is our company's commitment to protecting the environment. Through smart sustainability efforts, we're creating better ways to build better RVs using fewer or renewable natural resources. This is our commitment to you—to build a better RV so that we can do a better job of protecting our planet.

### GET MORE OF WHAT YOU NEED IN CYBERSPACE.

Explore more Starcraft RVs by visiting our world-class website. This advanced, digital-age-friendly site offers more product photo galleries, construction information, videos, the latest floorplans, specifications and other great features to assist you. Find your closest dealer, customer service info and more!



[STARCRAFTCAMPING.COM](http://STARCRAFTCAMPING.COM)

**SEE YOUR LOCAL STARCRAFT DEALER:**

# STARCRAFT®

THE FUTURE OF CAMPING | pure and simple.

536 Michigan Street  
Topeka, IN 46571 USA

Phone: (800) 945-4787  
Web: [starcraftcamping.com](http://starcraftcamping.com)

**FOR INTELLIGENT LIFE  
FOLLOW US ON:**



All information contained in this brochure is the latest available at the time of publication approval. Starcraft reserves the right to make changes and to discontinue models without notice or obligation. Photography may show optional equipment or props used for promotional purposes. RVs built for sale in Canada may differ to conform to Canadian codes. Check with your authorized Starcraft dealer for the latest information.

**Unloaded Vehicle Weight (UUV):** Sometimes referred to as "Dry Weight," UUV means the typical weight of this trailer as built at the factory. The UUV, as used in product literature and other promotional materials, does not include cargo, fresh water, propane, options or dealer-installed accessories.

**Gross Vehicle Weight Rating (GVWR):** GVWR means the maximum permissible weight of the trailer, including UUV plus passengers, personal items, all cargo, fluids, options, and dealer-installed accessories. The GVWR is equal to or greater than the sum of the UUV and the CCC.

**Cargo Carrying Capacity (CCC):** Means the maximum weight of all passengers, personal items, food, fresh water, propane, tools, other cargo and dealer-installed accessories that can be carried by the trailer. CCC is equal to or less than GVWR minus UUV. The addition of options will decrease the CCC.

**Hitch Weight (HW):** The hitch weight, as used in product literature and other promotional materials, does not include cargo, fresh water, propane gas, options or

dealer-installed accessories. The addition of these types of items will either add to or subtract from the stated hitch weight.

It is important for your safety and enjoyment that your tow vehicle be adequately sized and equipped to tow and handle the GVWR of the RV you select. Review weights and rating of your tow vehicle and consult a competent advisor for questions or advice. Whether you are new to RVing or a veteran, get a feel for the performance of your tow vehicle before heading out on the roadways. When you tow an RV, you must drive differently than when you drive a single vehicle. Practice hooking up, driving, backing up and braking in a safe environment or seek out professional instruction. Starcraft affixes a weight label to each RV which lists weight information for that vehicle. See specifications chart in this brochure.