



EAGLE HT TT

ADVENTURES AROUND EVERY BEND





CLASSIC FARMHOUSE



Main Wood

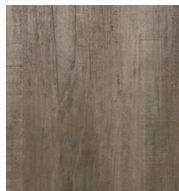

Accent Wood

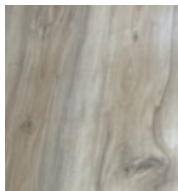

Floor

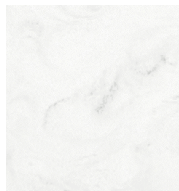

Countertop

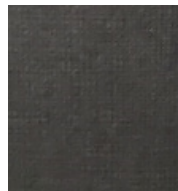

Main Fabric



Accent Fabric

230MLCS OPTION: F

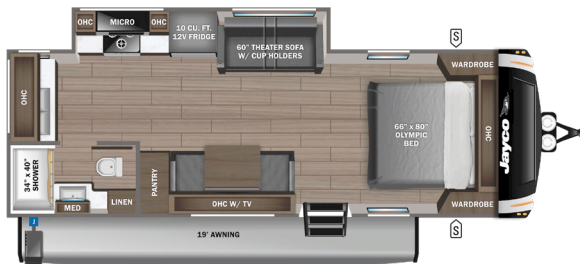

JAYPORT
W/ LP QUICK
CONNECT &
H/C WATER

274FKDS OPTIONS: B, E, F

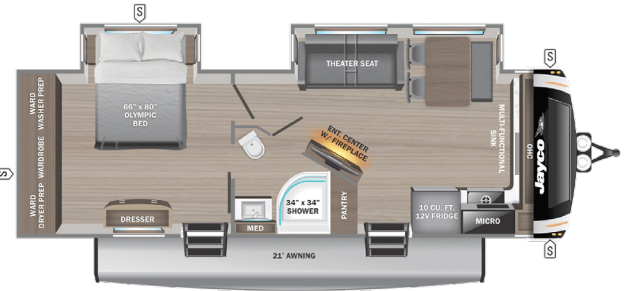

284BHK OPTIONS: A, C, D

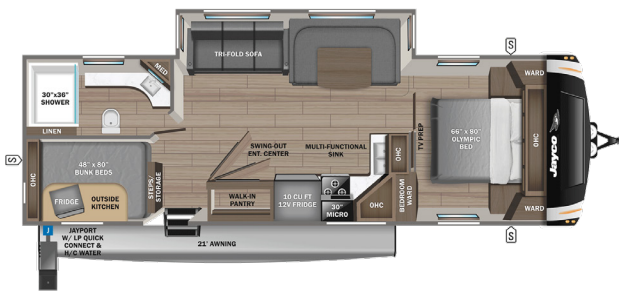

JAYPORT
W/ LP QUICK
CONNECT &
H/C WATER

294CKBS OPTIONS: B, E, F

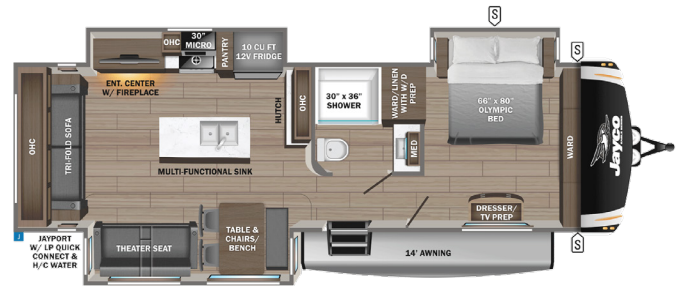

JAYPORT
W/ LP QUICK
CONNECT &
H/C WATER

295RUCD

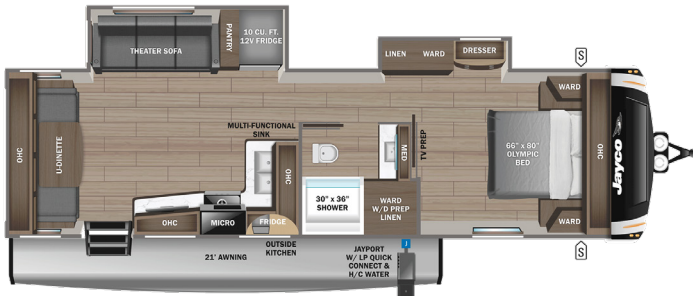

JAYPORT
W/ LP QUICK
CONNECT &
H/C WATER

312BHK OPTIONS: A, C, D

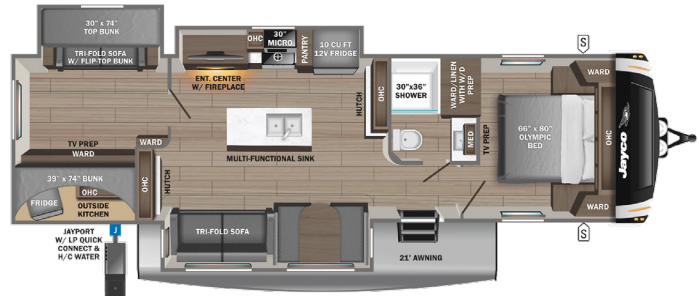

JAYPORT
W/ LP QUICK
CONNECT &
H/C WATER

320MKTS OPTIONS: C, E, F

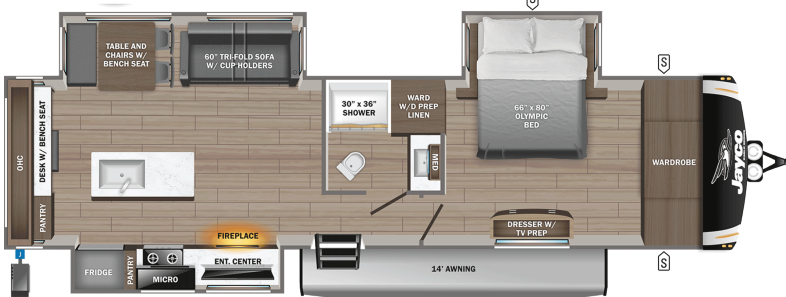

JAYPORT
W/ LP QUICK
CONNECT &
H/C WATER

	STORAGE
	MICROWAVE
	OVERHEAD CABINETS
	REFRIGERATOR
	WARDROBE

OPTIONS

A	B	C
Table & Chairs/Bench	Dinette	Triple Recliner
D	E	F
Theater Seat	King Bed	Jayport

STANDARDS & OPTIONS

EXTERIOR

- 1.5 in. fresh water drain valve
- 5 in. Magnum Truss™ with plywood roof decking
- 50-amp detachable power cord
- Additional dump valve at termination
- Alpha Ply TPO roof membrane (thickest roof membrane with limited lifetime warranty)
- Auto-grade vinyl graphics
- Automotive style front cap with max turn radius
- Backup camera prep
- Black tank flush
- Climate Shield™ zero-degree tested weather protection:
 - * Fully enclosed and heated underbelly (ducted)
 - * 35,000 BTU furnace
 - * Double layer fiberglass batt insulation in ceiling and floor
 - * Double sided radiant barrier insulation (roof, floor and behind cap)
 - * PEX plumbing
- Dual 30 lb. LP bottles
- Factory installed roof ladder
- Galvanneal steel coated outside kitchens
- HELIX Cooling System™ (industry exclusive):
 - * Jayco exclusive insulated dual duct design
 - * Directional and closeable A/C vents
 - * Larger return air vents with user accessible filters
- Independent satellite and cable hookups (outside kitchens and/or pass through storage areas)
- LED exterior lighting package
- LED light and switch at termination
- LED lighting in pass through area
- LP quick connect for gas griddle (next to JayPort)
- Metal slam latch baggage doors
- Nautilus 2.5 water connections
- Nitrogen filled under mount spare tire (model/option varies 15 in. or 16 in.)
- Overlander solar prep (roof)
- Quick connect water connections (door side hot/cold and off door side cold only)
- Slide topper/awning prep
- Stronghold VBL™ walls (laminated sidewalls, rear walls and slide out walls)

INTERIOR

100% No Floor Vents

- 2-piece high gloss bathroom surround
- 5/8 in. tongue-and-groove plywood flooring
- 75 lb. full extension drawer guides
- Bathroom skylight
- Bedroom TV, satellite and cable prep
- CPAP prepped bedroom (both sides)
- Extra 120V power outlets in kitchen and slide rooms (where applicable)
- Gas strutted under bed storage
- Handcrafted and glazed door/drawer fronts
- LED fireplace with 5,000 BTU electric space heater (select models)
- Matte black kitchen faucet with pull-out sprayer
- Medicine cabinet with custom framed mirror
- NuVo H2O Water Treatment System (filters included)
- Porcelain foot flush toilet
- Residential vinyl flooring throughout (NO CARPET)
- Solid hardwood slide fascia
- Teak Seat Shower Prep
- Theater seating (select models)
- Tri-fold hide-a-bed sofa with residential memory foam sleep surface (select models)
- USB 12V charging ports (multiple locations throughout)
- Water shutoff at all faucet locations

CUSTOMER VALUE PACKAGE (MANDATORY)

- 15,000 BTU "Whisper Quiet" A/C and bedroom A/C prep
- 40 in. 4K Ultra LED HD Smart TV in living room
- 50-amp service with dual A/C ducts
- 60,000 BTU on-demand tankless water heater
- Custom machined aluminum rims
- Electric patio awning
- Exterior "Blue Sync" Audio Connect with MB Quart Sound (TV and phone)
- Hidden hinges on cabinet doors
- Interior "Blue Sync" Audio Connect with MB Quart Sound (TV and phone)
- Keyed-Alike™ lock system
- MORryde Step Above™ entrance steps (main entrance) with blue LED light
- Rain proof bathroom power vent
- Rear 2 in. towing receiver
- Upgraded friction hinge entrance door

Winegard Air 360 + antenna and router prep (NOW 5G)

LUXURY PACKAGE (MANDATORY)

- Blackout roller shades with reflective side throughout
- GE 10 cu. ft. 12V refrigerator
- GE 30 in. over-the-range black and stainless microwave with exhaust fan
- GE black and stainless 21 in. range with edge to edge grates
- Inverter pre-wire (multiple locations) ((7) 110 outlets)(6 USBs 12V)
- JayPort 2 in. mount (for outside accessories)
- Magnetic Catches for all drawers and doors
- Multi-Function "ALL in ONE" Stainless steel kitchen sink
- Residential 66 in. x 80 in. OLYMPIC size mattress
- Residential style glass shower door
- Washer/dryer prep (select models)

4-STAR HANDLING PACKAGE (MANDATORY)

- Dexter® Axles with NEV-R-Adjust® brakes and E-Z Lube® hubs
- Goodyear® Endurance® tires (load range E)
- MORryde® CRE-3000™ rubberized suspension
- Wet bolt fasteners with bronze bushings

OPTIONS

- 15,000 BTU bedroom A/C
- Booth dinette (select models)
- Dexter® ABS brake system with anti-sway
- Electric auto-leveling with JAYCOMMAND® Smart RV system
- Extreme Weather Package with 120 heat pads and 12V heat tape on fresh water line
- Frameless dual pane windows
- Free standing table with leaf and bench seat and 2 foldable dinette chairs
- Furniture cup holder tables (1 pair)
- HALO 22 in. outside griddle with deep sink attachment for JayPort system (select models)
- JAYCOMMAND® Smart RV System with TPMS monitoring
- King bed (72 in. x 80 in.) mattress with under-bed storage
- LED fireplace with 5,000 BTU electric space heater (select models)
- Overlander 1 Solar Package (200W panel and 30-amp solar controller)
- Overlander 2 Solar Package: (2) 200W panels, MPPT 30-amp solar controller and 1800W inverter)
- Residential 72 in. x 80 in. king size mattress (select models)
- Theater seating in place of tri-fold sofa (select models)
- Triple reclining sofa ipo dinette (select models)

*Indicates split tanks

FLOORPLAN	TOTAL EXTERIOR LENGTH	EXTERIOR WIDTH	EXTERIOR HEIGHT (WITH A/C)	INTERIOR HEIGHT	UNLOADED VEHICLE WEIGHT	DRY HITCH WEIGHT	GVWR	CARGO CARRYING CAPACITY	FRESH WATER CAPACITY	GRAY WASTE WATER CAPACITY	BLACK WASTE WATER CAPACITY	SLEEPING CAPACITY
230MLCS	27' 8"	8' 1"	11' 9"	7' 0"	6,575	795	8,400	1,825	52	74*	37	2
274FKDS	34' 10"	8' 1"	11' 8"	7' 0"	8,545	1,095	10,600	2,055	52	111*	37	2
284BHOK	34' 10"	8' 1"	11' 7"	7' 0"	7,960	1,500	9,995	2,035	81	74*	37	8-10
294CKBS	38' 0"	8' 1"	11' 10"	7' 0"	9,470	1,280	11,700	2,230	52	74*	37	2-4
295RUCD	33' 10"	8' 1"	11' 8"	7' 0"	8,200	1,000	10,250	2,050	52	74*	37	4-6
312BHOK	38' 8"	8' 1"	11' 11"	7' 0"	9,795	1,330	11,500	1,705	52	74*	38	9-11
320MKTS	36' 8"	8' 1"	12' 0"	7' 0"	9,175	1,145	11,500	2,325	52	74*	37	2-4

Meet your Jayco Dealer



Scan QR code for specification definitions

Some specs at the time of print may include estimates. For the most updated information, please visit Jayco.com

Jayco, Inc. | P.O. Box 460 | Middlebury, IN 46540

See dealer for further information and prices. All information in this brochure and on www.jayco.com is the latest available at the time of publication approval. Jayco reserves the right to make changes and to discontinue models without notice or obligation. Photography may show optional equipment or props used for decoration purposes only. RVs built for sale in Canada may differ to conform to Canadian codes. JAYCO and the JAYCO BIRD IN FLIGHT are registered trademarks of Jayco, Inc. Printed in USA 11/24 ©2024 Jayco, Inc. 2032973



Jayco - Part of Jayco Family of Companies