

SPECIFICATIONS	NEWPORT	CHESAPEAKE	SUN VALLEY	MESA	UTAH	E3 BOX	E3 DECK
Box Size (Inside Length)	9'	11'	12'	12'	12'	12'	12'
Dimensions Open	19' x 6' 8"	23' x 6' 8"	23' 7" x 8' 9"	23' 7" x 8' 9"	23' 7" x 10' 8"	23' 7" x 10' 8"	26' 5" x 10' 8"
Dimensions Closed (L&W)	12' 11" x 6' 8"	14' 11" x 6' 8"	17' 1" x 7' 5"	18' 9" x 7' 5"	18' 9" x 7' 5"	18' 9" x 7' 5"	21' 9" x 7' 5"
Height Closed / Open	47" x 105"	47" x 105"	58" x 105"	58" x 105"	58" x 105'	62" x 110"	62" x 110"
Interior Height	77"	77"	80"	80"	80"	80"	80"
Bed Size – Front	51" x 72"	75" x 72"	77" x 70"	77" x 70"	77" x 70"	77" x 70"	77" x 70"
Bed Size – Rear	51" x 72"	51" x 72"	77" x 70"	77" x 70"	77" x 70"	77" x 70"	77" x 70"
Dinette / Bed Size	39" x 59"	43" x 71"	71" x 43"	71" x 43"	71" x 43"	71" x 43"	71" x 43"
Converter Amperage	20A	20A	35A	35A	35A	35A	35A
Fresh Water Capacity	5 Gal.	5 Gal.	20 Gal.	20 Gal.	20 Gal.	35 Gal.	35 Gal.
Water Tank Storage	Above Floor	Above Floor	Under Floor	Under Floor	Under Floor	Under Floor	Under Floor
Gross Vehicle Weight Rating	2,200 lbs.	2,200 lbs.	3,500 lbs.	3,500 lbs.	3,500 lbs.	3,500 lbs.	4,400 lbs.
Unloaded Vehicle Weight	1,195 lbs.	1,295 lbs.	2,455 lbs.	2,595 lbs.	2,760 lbs.	2,723 lbs.	2,908 lbs.
Maximum Carrying Capacity	1,005 lbs.	905 lbs.	1,045 lbs.	905 lbs.	740 lbs.	777 lbs.	1,492 lbs.
Tongue Weight	100 lbs.	125 lbs.	250 lbs.	285 lbs.	290 lbs.	305 lbs.	385 lbs.
Tire Size	20.5 x 8 x 10	20.5 x 8 x 10	ST205/75D14	ST205/75D14	ST205/75D14	LT235/75R15C	LT235/75R15C

Standard Features

Exterior

- Sunbrella 302 Tenting (Including Window Flaps)
- Power Lift System with Current Limiter\*
- Stainless Steel Lift System
- Tubular Steel Frame
- Single (.030" Thick) Skin Aluminum Roof (No Seams)
- .056" Thick Diamond Plate Front and Rear Panels
- .030 Thick "Black" G-90 Galvanealed Steel Body Panels\*
- 10" Tires and Rims (Grand Tour Ultra)
- 14" Tires and Rims (Grand Tour)
- 15" Aluminum Wheels (Evolution)
- Spare Tire and Carrier
- 4 Stabilizing Jacks w/ Sand Pad
- Back Saver Bed Supports\*
- Dometic Awning (Option for Grand Tour Ultra)
- Double Step (Stepper Door for Grand Tour Ultra)
- Electric Brakes
- Double LP Tanks w/ Auto Changeover (Single Tank for Grand Tour Ultra)
- Outside Shower\*
- EZ Lube Axle

- Recessed Tail Lights
- Exterior Outlet\*
- Exterior Patio Light

Interior

- Water Heater Bypass Valves\*
- "New" Thetford Curve Toilet & Cabinet\*
- Patented Swing-Level Galley\*
- 35 Amp Converter w/ Trickle Charge (20 Amp Converter for Grand Tour Ultra)
- Clear Vinyl Windows
- Deep Bowl Sink
- Stereo System w/ Indoor and Outdoor Speakers\*
- Bed Fan Light\*

Appliances

- Dometic 3-Way Refrigerator\*
- Atwood Hydro Flame 16000 BTU Furnace (Option for Grand Tour Ultra)
- 6 gal. Suburban Porcelain-Lined DSI Water Heater\*

\*Not available on Chesapeake and Newport.



1297 Kecksburg Road  
Mount Pleasant, Pennsylvania 15666  
phone 724.237.5227  
fax 724.423.8485  
www.aliner.com



©2016 Columbia Northwest. Aliner® and Somerset® are registered trademarks of Columbia Northwest. Product information, photography and illustrations included in this publication were as accurate as possible at the time of printing. For further product information and changes, please visit our website at www.aliner.com or contact your nearest Aliner® or Somerset® Camping Trailer dealer. Prices, materials, design and specifications are subject to change without notice. All weights, fuel capacities and dimensions are approximate. The user is responsible for selecting the proper combination of loads (i.e., occupants, equipment, fluids, cargo, etc.) to ensure that the vehicle's capacities are not exceeded.

Your Home on the Road





# ALINER CAMPER: EASY, RELIABLE AND RESPONSIVE



**Aliner owners all share a common desire.**

We want to experience nature. We want to get out in it, be a part of it, be amazed by it. Whether it's hiking, cycling, climbing, rowing, rafting, fishing or just kicking back and taking in the awesome sights and sounds of the outdoors.

We want to be in it. In nature. In the moment. But we don't want a 30-minute setup or the need to buy a heavy-duty, gas guzzling, hard-to-handle truck just to be able to tow a camper. It shouldn't be so complicated. With Aliner, it's not. Aliner campers are easy and convenient, allowing you more time to be **in the moment doing what you came to do, enjoying where you came to be.**



## GRAND TOUR ULTRA LIGHT SERIES



GRAND TOUR **NEWPORT**

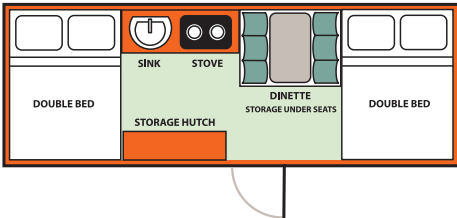

GRAND TOUR **CHESAPEAKE**

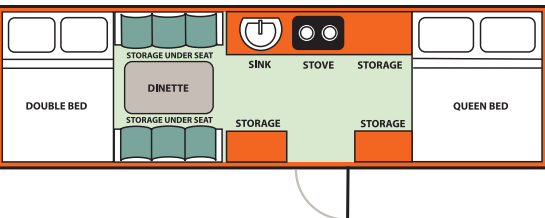

## GRAND TOUR SERIES



GRAND TOUR **SUN VALLEY**



GRAND TOUR **MESA**

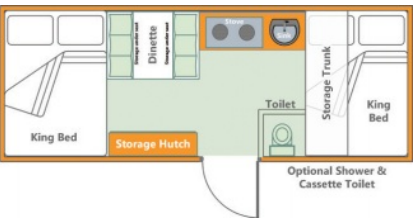

GRAND TOUR **UTAH**



## EVOLUTION SERIES



### Evolution Package Includes:

- 35 Gallon Fresh Water Tank
- Diamond Plate Body Panel Trim
- 15" Off Road Tires
- LED Interior Lighting

The Evolution E3 can be ordered with a front storage box or a front deck.





SOMERSET CAMPER: LEADING THE WAY IN COMFORT AND DURABILITY

Columbia Northwest takes extraordinary pride in the innovative design and quality automotive construction.



With three different series of trailers—Grand Tour Ultra Light, Grand Tour and Evolution—offering five different models, you're sure to find a Somerset® Camping Trailer that's right for you!

No-Spill Swing-Level Galley

The no-spill, swing-level galley's smooth chain and gear design allows for quick and easy set-up, with plenty of upper and lower storage.

\*Not available on Grand Tour Ultra Light.

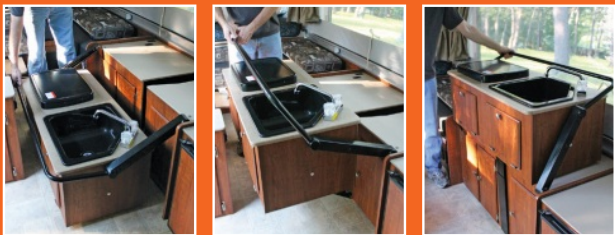

EXPEDITION

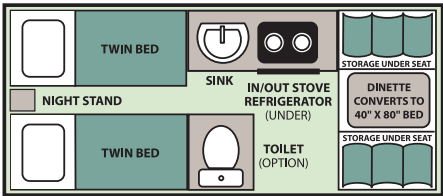
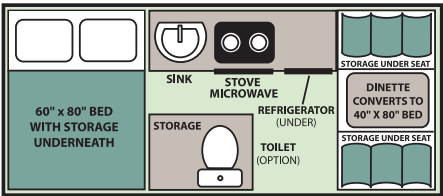
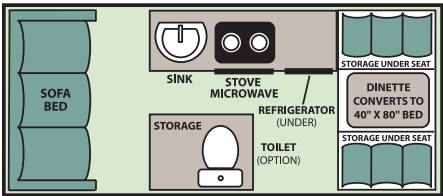

Length 18'  
Width 84"  
Closed Height 62"  
Dry Weight 1900 lbs.  
Dry Hitch Weight 240 lbs.  
GVWR 3500 lbs.

EXPLORER

Length 18'  
Width 84"  
Closed Height 62"  
Dry Weight 2100 lbs.  
Dry Hitch Weight 240 lbs.  
GVWR 3500 lbs.

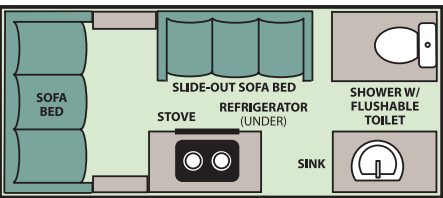
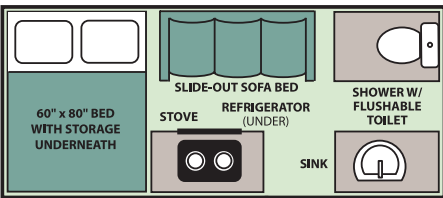

CLASSIC

Length 15'  
Width 78"  
Closed Height 57"  
Dry Weight 1615 lbs.  
Dry Hitch Weight 190 lbs.  
GVWR (Std. Axle) 2500 lbs.  
GVWR (Off-Road Axle) 3000 lbs.

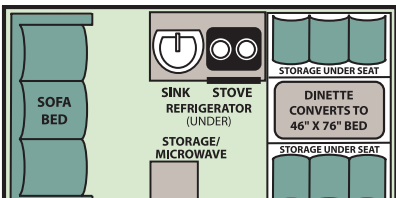
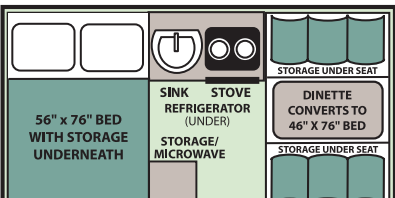

LXE

Length 15'  
Width 78"  
Closed Height 57"  
Dry Weight 1775 lbs.  
Dry Hitch Weight 190 lbs.  
GVWR (Std. Axle) 2500 lbs.  
GVWR (Off-Road Axle) 3000 lbs.

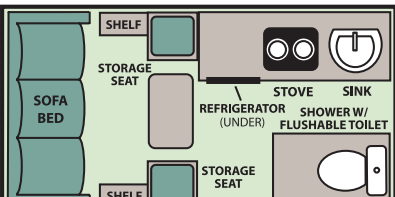



RANGER 15

Length 18'  
Width 84"  
Closed Height 62"  
Dry Weight 1670 lbs.  
Dry Hitch Weight 240 lbs.  
GVWR 3500 lbs.

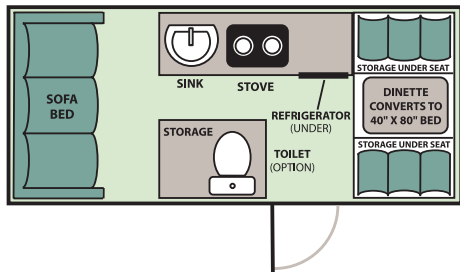

RANGER 12

Length 15'  
Width 78"  
Closed Height 57"  
Dry Weight 1342 lbs.  
Dry Hitch Weight 150 lbs.  
GVWR (Std. Axle) 2500 lbs.  
GVWR (Off-Road Axle) 3000 lbs.

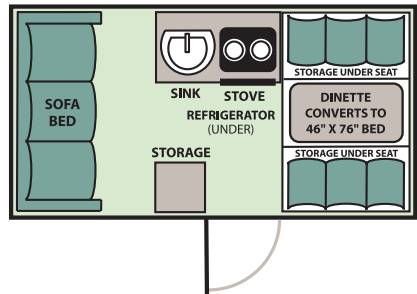

RANGER 10

Length 13'  
Width 78"  
Closed Height 57"  
Dry Weight 1200 lbs.  
Dry Hitch Weight 150 lbs.  
GVWR (Std. Axle) 2500 lbs.  
GVWR (Off-Road Axle) 3000 lbs.

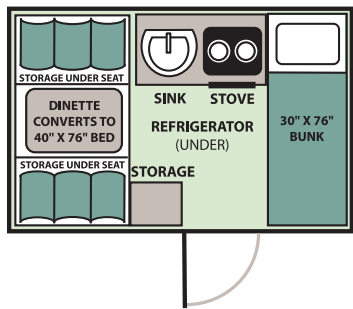
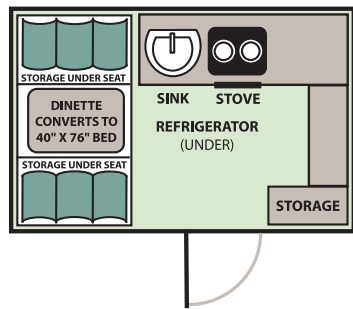

SCOUT

Length 15'  
Width 78"  
Closed Height 57"  
Dry Weight 1115 lbs.  
Dry Hitch Weight 120 lbs.  
GVWR (Std. Axle) 2500 lbs.  
GVWR (Off-Road Axle) 3000 lbs.

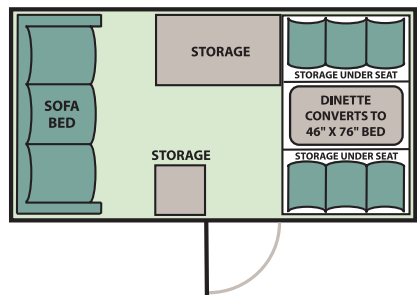

SCOUT-LITE

Length 13'  
Width 78"  
Closed Height 57"  
Dry Weight 1090 lbs.  
Dry Hitch Weight 120 lbs.  
GVWR (Std. Axle) 2500 lbs.  
GVWR (Off-Road Axle) 3000 lbs.

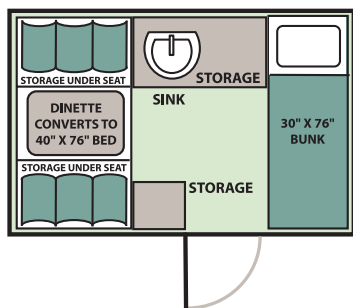

Standard Features  
on All Aliner  
Camping Trailers

- Performax 500 Flooring
- Torsion Axle
- 10" Electric Brakes w/ Breakaway Switch
- Vacuum Bonded Fiberglass Panels
- Diamond Plate Stone Guard
- Aluminum Wheels
- Battery Hook Up
- 35 Amp Converter
- Skylights with Night Shades
- Fan-Tastic Fan
- Solar Panel Port

All weights, fuel capacities and dimensions are approximate. The user is responsible for selecting the proper combination of loads (i.e., occupants, equipment, fluids, cargo, etc.) to ensure that the vehicle's capacities are not exceeded.

EXTERIOR	EXPLORER	EXPEDITION	CLASSIC	LXE	RANGER 15	RANGER 12	RANGER 10	SCOUT	SCOUT-LITE
Stabilizer Jacks	4	4	4	4	2	2	2	2	2
Spare Tire and Carrier	S	S	S	S	S	S	S	S	S
10" brakes with Breakaway Switch	S	S	S	S	S	S	S	S	S
Standard Axle	N/A	N/A	2,500 lb, 13" Aluminum Wheels	2,500 lb, 13" Aluminum Wheels	N/A	2,500 lb, 13" Aluminum Wheels	2,500 lb, 13" Aluminum Wheels	2,500 lb, 13" Aluminum Wheels	2,500 lb, 13" Aluminum Wheels
Off Road Axle	3,500 lb, 14" Aluminum Wheels	3,500 lb, 14" Aluminum Wheels	3,000 lb, 14" Aluminum Wheels	3,000 lb, 14" Aluminum Wheels	3,500 lb, 14" Aluminum Wheels	3000 lb, 14" Aluminum Wheels	3,000 lb, 14" Aluminum Wheels	3,000 lb, 14" Aluminum Wheels	3,000 lb, 14" Aluminum Wheels
Outside Shower	S	S	S	S	S	S	S	N/A	N/A
Baggage Doors	2	3	2	2	1	1	1	O	O
Front Utility Light	S	S	S	S	N/A	N/A	N/A	N/A	N/A
LED Marker and Brake Lights	S	S	S	S	N/A	N/A	N/A	N/A	N/A
Exterior Outlet	S	S	S	S	N/A	N/A	N/A	N/A	N/A
Outside Propane Connection	S	S	S	S	Option with Grill	Option with Grill	Option with Grill	N/A	N/A
INTERIOR	EXPLORER	EXPEDITION	CLASSIC	LXE	RANGER 15	RANGER 12	RANGER 10	SCOUT	SCOUT-LITE
Sink	S	S	S	S	S	S	S	O	S
Shower and Toilet	S	O	N/A	S	N/A	N/A	N/A	N/A	N/A
Fresh Water Capacity	20 gal.	11 gal.	11 gal.	11 gal.	11 gal.	11 gal.	11 gal.	N/A	N/A
Electrical Outlets	3	3	3	3	2	2	2	1	1
Skylight	2	2	2	2	2	2	2	2	2
Front Bed	N/A	40" x 80"	46" x 76"	N/A	40" x 80"	46" x 76"	30" x 76" (dual bunk)	46" x 76"	30" x 76" (dual bunk)
Rear Bed	60" x 80"	60" x 80"	56" x 76"	56" x 76"	60" x 80"	56" x 76"	40" x 76"	56" x 76"	40" x 76"
APPLIANCES	EXPLORER	EXPEDITION	CLASSIC	LXE	RANGER 15	RANGER 12	RANGER 10	SCOUT	SCOUT-LITE
Water Pump	S	S	S	S	S	S	S	N/A	N/A
3- Way Refrigerator Size (cubic feet)	3.0 w/ Freezer	3.0 w/ Freezer	3.0 w/ Freezer	3.0 w/ Freezer	1.9	1.9	1.9	N/A	N/A
Microwave	S	S	S	S	N/A	N/A	N/A	N/A	N/A
Fantastic Fan	S	S	S	S	S	S	S	S	S
Stove Top	Euro, Flush Mount	Euro, Flush Mount	In / Out	Built In	Built In	Built In	Built In	None	None
OPTIONS	EXPLORER	EXPEDITION	CLASSIC	LXE	RANGER 15	RANGER 12	RANGER 10	SCOUT	SCOUT-LITE
Front Storage Tray (and Box)	N/A	N/A	O	O	N/A	O	N/A	N/A	N/A
Front Dormer, Soft	N/A	O	O	N/A	O	O	N/A	N/A	N/A
Rear Dormer, Soft	N/A	O	O	N/A	O	O	N/A	N/A	N/A
Front Dormer, Hard	S	O	O	S	N/A	N/A	N/A	N/A	N/A
Rear Dormer, Hard	O	O	O	O	N/A	N/A	N/A	N/A	N/A
Fast Pack Awning	O	O	O	O	O	O	O	O	O
Dual Tanks and Cover	O	O	O	O	O	O	O	N/A	N/A
Outside Grill	O	O	O	O	O	O	O	N/A	N/A
High Wind Kit	O	O	O	O	O	O	O	O	O
Lift Assist	O	O	O	O	O	O	N/A	O	N/A
Bike Rack	O	O	O	O	O	O	O	O	O
Furnace	O	O	O	O	O	O	O	N/A	N/A
Water Heater	S	O	O	S	O	O	O	N/A	N/A
5,000 BTU Wall AC	O	O	O	O	O	O	O	O	O
11,000 BTU Cool Cat Heat Pump	O	O	O	O	O	O	N/A	N/A	N/A
Toilet	S	O	N/A	S	O	N/A	N/A	N/A	N/A
Stereo	O	O	O	O	O	O	N/A	O	N/A
Stereo Boom Package	O	O	O	O	O	O	N/A	O	N/A
Parks Package*	N/A	N/A	N/A	N/A	N/A	N/A	N/A	O	N/A

\*Parks Package includes city water hookup, sink and electric refrigerator

O Optional  
S Standard